

EXISTING	PROPOSED	EXISTING	PROPOSED
150 WM	150 WM	150 WM	150 WM
300 LBS	300 LBS	300 LBS	300 LBS
290 WMS	290 WMS	290 WMS	290 WMS
MANHOLE	MANHOLE	MANHOLE	MANHOLE
CATCH BASIN	CATCH BASIN	CATCH BASIN	CATCH BASIN
CURB INLET	CURB INLET	CURB INLET	CURB INLET
JUNCTIONS	JUNCTIONS	JUNCTIONS	JUNCTIONS
LEGEND-PLAN	LEGEND-PLAN	LEGEND-PLAN	LEGEND-PLAN

WHOLE NUMBERS INDICATE MILLIMETRES
 DECIMALIZED NUMBERS INDICATE METRES

WARNING

IF POWER EQUIPMENT OR EXPLOSIVES ARE TO BE USED FOR EXCAVATION ON THIS PROJECT THE CONTRACTOR MUST:
 1) NOTIFY THE GAS COMPANY OF THE PROPOSED LOCATION OF EXCAVATION.
 2) TAKE PRECAUTION TO AVOID DAMAGE TO GAS COMPANY INSTALLATIONS.

SEE PROVINCIAL REGULATION 140/92 FOR DETAILS

APEN
 Certificate of Authorization
 Stantec Consulting Ltd.
 No. 1301 Expiry: April 30, 2005

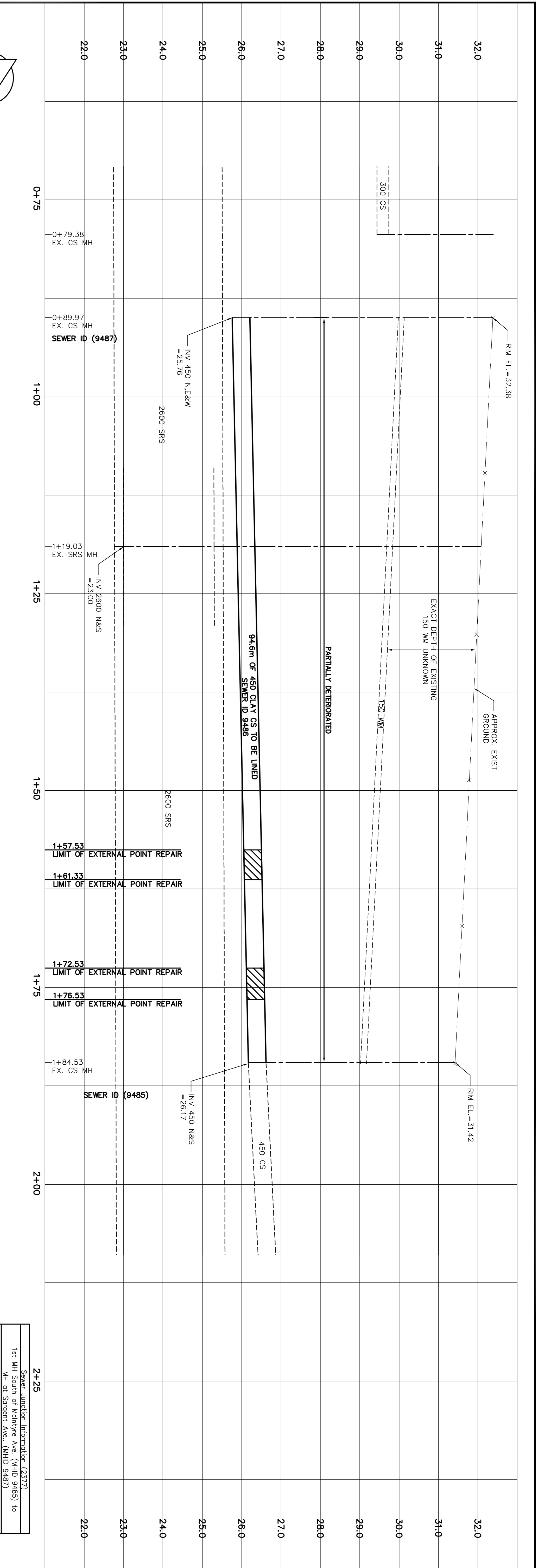
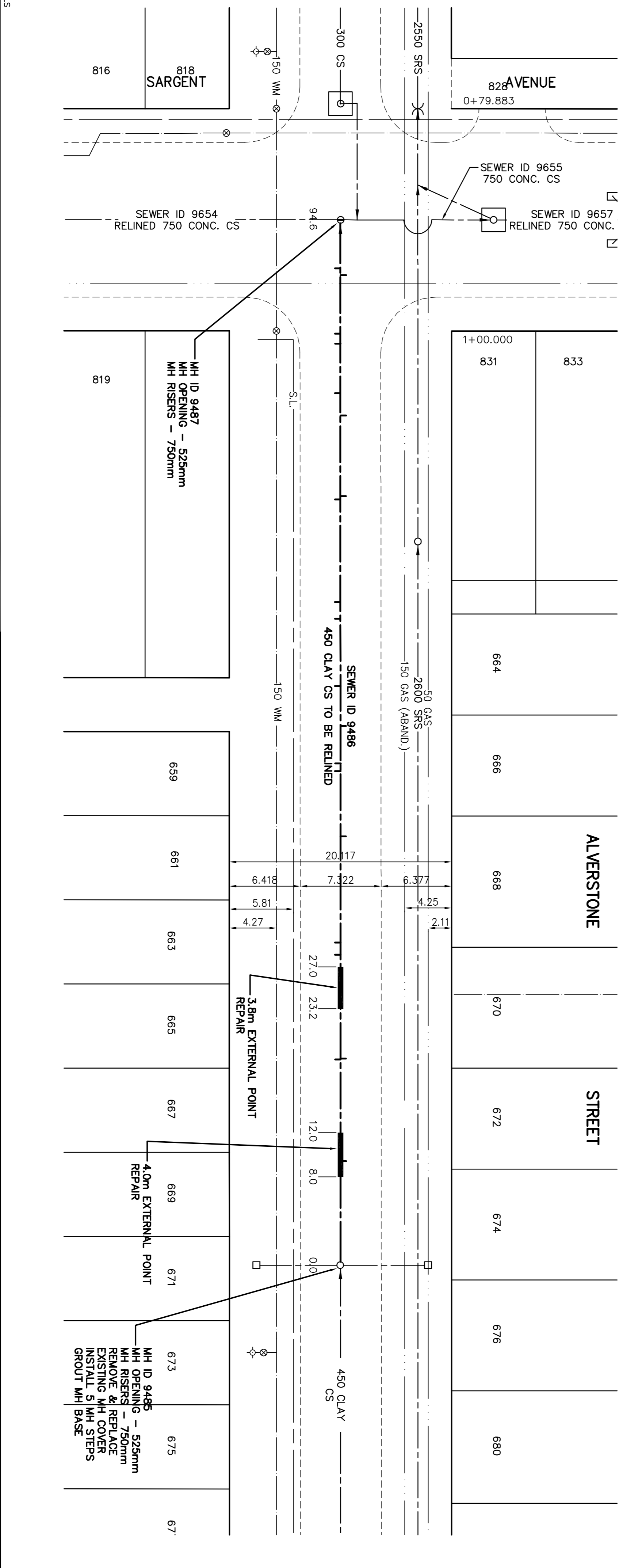
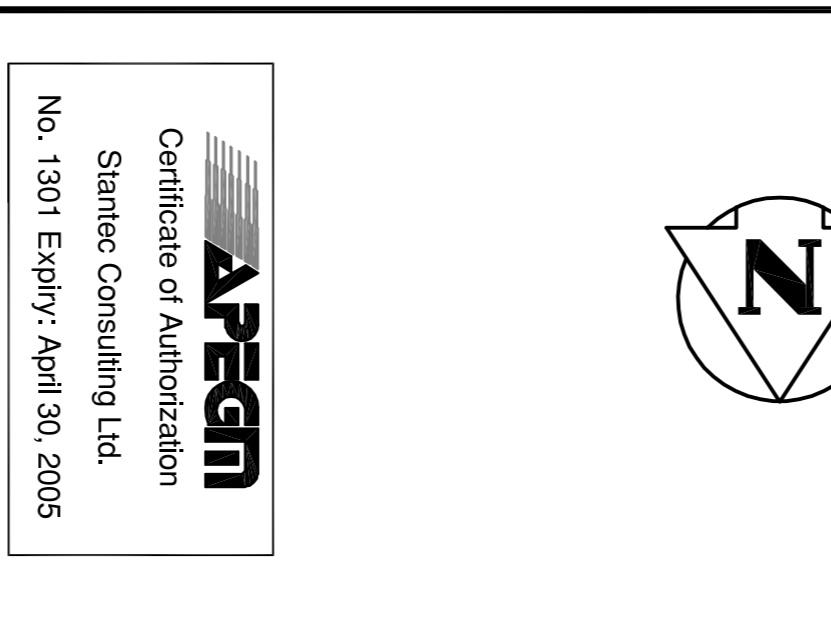

ADDRESS	SIZE	PROPERTY LINE LOCATION
661 ALVERSTONE RESIDENTIAL	N/A	N/A
663 ALVERSTONE RESIDENTIAL	N/A	N/A
664 ALVERSTONE RESIDENTIAL	N/A	N/A
665 ALVERSTONE RESIDENTIAL	N/A	N/A
666 ALVERSTONE RESIDENTIAL	N/A	N/A
667 ALVERSTONE RESIDENTIAL	N/A	N/A
668 ALVERSTONE RESIDENTIAL	N/A	N/A
669 ALVERSTONE RESIDENTIAL	N/A	N/A
670 ALVERSTONE RESIDENTIAL	N/A	N/A
671 ALVERSTONE RESIDENTIAL	N/A	N/A
672 ALVERSTONE RESIDENTIAL	N/A	N/A
673 ALVERSTONE RESIDENTIAL	N/A	N/A
674 ALVERSTONE RESIDENTIAL	N/A	N/A
675 ALVERSTONE RESIDENTIAL	N/A	N/A
676 ALVERSTONE RESIDENTIAL	N/A	N/A
677 ALVERSTONE RESIDENTIAL	N/A	N/A
678 ALVERSTONE RESIDENTIAL	N/A	N/A
679 ALVERSTONE RESIDENTIAL	N/A	N/A
680 ALVERSTONE RESIDENTIAL	N/A	N/A
681 ALVERSTONE RESIDENTIAL	N/A	N/A
682 ALVERSTONE RESIDENTIAL	N/A	N/A

SEWER SERVICE INFORMATION

* Information from Sewer Video Inspection

Distance from 1st MH South of McIntyre Ave. (MHID 9485) to MH at Sargent Ave. (MHID 9487)	Direction	Size	Material	Condition
4.4	South	150 mm Dia.	East	JN
5.0	South	150 mm Dia.	West	CNI
10.3	South	150 mm Dia.	East	CXI
11.2	South	150 mm Dia.	East	JN
11.7	South	150 mm Dia.	East	JN
12.9	South	150 mm Dia.	West	JN
23.9	South	150 mm Dia.	West	JN
24.2	South	150 mm Dia.	East	JN
34.6	South	150 mm Dia.	East	JN
36.1	South	150 mm Dia.	East	JN
42.2	South	150 mm Dia.	West	JN
45.8	South	150 mm Dia.	East	CNI
49.2	South	150 mm Dia.	East	JN
55.4	South	150 mm Dia.	East	JN
65.4	South	150 mm Dia.	East	JN
66.5	South	150 mm Dia.	East	JN
75.9	South	150 mm Dia.	East	JN
76.0	South	150 mm Dia.	East	JN
85.2	South	150 mm Dia.	West	JN

Stantec Consulting Ltd.
 905 Waverley Street, Winnipeg, Manitoba
 Tel 204-489-5900 Fax 204-453-9012

THE CITY OF WINNIPEG
 WATER AND WASTE DEPARTMENT
 ENGINEERING DIVISION

ALVERSTONE STREET
 1ST MH S MCINTYRE AV TO MH SARGENT AV
 STA 0+90 TO STA 1+85
 2004 SEWER RENEWAL BY CIPP LINING

DESIGNED BY: C.D.
 DRAWN BY: K.R.
 HORIZ. SCALE: 1:250
 VERTICAL SCALE: 1:50
 CHECKED BY: B.B.
 APPROVED BY: C.L.D.
 RELEASED FOR CONSTRUCTION: ORIGINAL SIGNED BY KEA TURKO
 DATE: 05/28/2004

ENGINEER'S SEAL: ORIGINAL SEALED BY C. DICK P. ENG. 05/28/2004
 CONSULTANT DRAWING NO. CW-28-614

SHEET 2 OF 7
 CAD FILE DRAWING NUMBER: 2004 Alverstone.dwg
 CITY DRAWING NUMBER: 05441