

NOTE: CHAINAGES SHOWN ARE ALONG E. R. OF COCKBURN ST. S.

COCKBURN STREET (SOUTH)

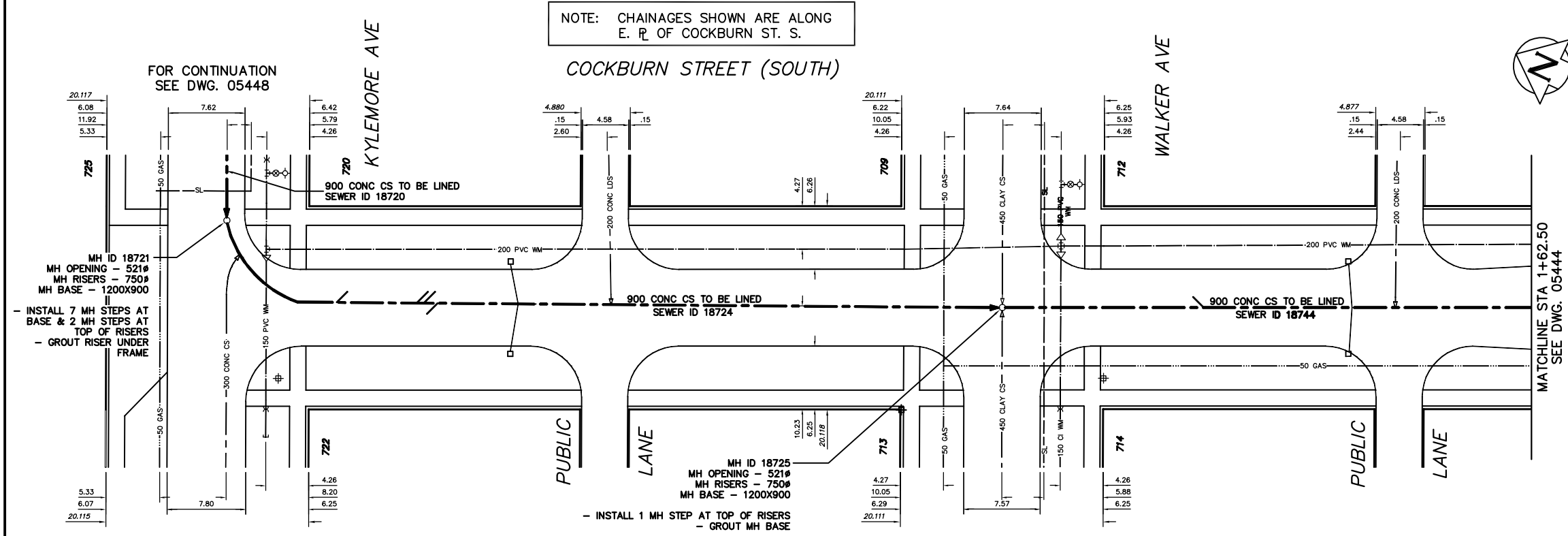

SEWER SERVICE INFORMATION			
ADDRESS	SIZE	R DIST	JUNCTION TIE
709 WALKER AVE	-	-	-
RESIDENTIAL	-	-	NO INFORMATION AVAILABLE
712 WALKER AVE	-	-	-
RESIDENTIAL	-	-	58.52 N MH @ RATHGAR
713 WALKER AVE	-	-	-
RESIDENTIAL	-	-	10.67 W MH @ COCKBURN
714 WALKER AVE	-	-	-
RESIDENTIAL	-	-	11.28 W MH @ COCKBURN
720 KYLEMORE AVE	-	-	-
RESIDENTIAL	-	-	58.52 N MH @ WALKER
722 KYLEMORE AVE	-	-	-
RESIDENTIAL	-	-	50.29 N MH @ WALKER
725 KYLEMORE AVE	-	-	-
RESIDENTIAL	-	-	NO INFORMATION AVAILABLE



SEWER JUNCTION INFORMATION * SEWER ID 18724			
DISTANCE FROM MH ID 18721			
3.40	S	300	WEST CNI
13.50	S	200	EAST CX
21.50	S	200	TOP CNI
22.20	S	150	TOP CNI
23.50	S	150	WEST CNI
31.50	S	200	EAST CNI
31.50	S	200	WEST CNI
40.70	S	200	EAST CNI
79.50	S	450	EAST CNI
79.50	S	450	WEST CNI

SEWER JUNCTION INFORMATION * SEWER ID 18744			
DISTANCE FROM MH ID 18725			
20.00	S	200	EAST CNI
34.70	S	200	EAST CNI
34.70	S	200	WEST CNI
39.00	S	200	EAST CNI

\* INFORMATION FROM SEWER VIDEO INSPECTION

**WARNING**

**METRIC**  
WHOLE NUMBERS INDICATE MILLIMETRES  
DECIMALIZED NUMBERS INDICATE METRES

IF POWER EQUIPMENT OR EXPLOSIVES ARE TO BE USED FOR EXCAVATION ON THIS PROJECT THE CONTRACTOR

- 1) NOTIFY THE GAS COMPANY OF THE PROPOSED LOCATION OF EXCAVATION.
- 2) TAKE PRECAUTION TO AVOID DAMAGE TO GAS COMPANY INSTALLATIONS.

SEE PROVINCIAL REGULATION 210/72 FOR DETAILS

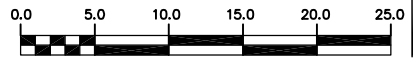

200 WM	WATERMAIN	200 WM	SL, HYDRO	150 WM	WATERMAIN	150 WM
+	HYDRANT	+	MTS	+	HYDRANT	+
o	VALVE	o	TRAFFIC SIGNALS	+	VALVE	+
525 LDS	LAND DRAINAGE SEWER	525 LDS	GAS	50 GAS	300 LDS	LAND DRAINAGE SEWER
375 WWS	WASTEWATER SEWER	375 WWS	SURVEY BAR	250 WWS	250 WWS	WASTEWATER SEWER
o	MANHOLE	o	FENCE	x	o	PROFILE
□	CATCH BASIN	□	POLE - HYDRO, MTS	///	o	GROUND ABOVE PIPE
▽	CURB INLET	▽	CURB STOP	o		
+	JUNCTIONS	+	GUY ANCHOR			
+	CULVERT	+	LIGHT STANDARD			
o	ANODE	o	TREE			
EXISTING	LEGEND-PLAN	PROPOSED	EXISTING	LEGEND-PLAN	PROPOSED	EXISTING
EXISTING	LEGEND-PROFILE	PROPOSED	EXISTING	LEGEND-PROFILE	PROPOSED	EXISTING

LOCATION APPROVED UNDERGROUND STRUCTURES	
SUPV. U/G STRUCTURES COMMITTEE	DATE
NOTE: LOCATION OF UNDERGROUND STRUCTURES AS SHOWN ARE BASED ON THE BEST INFORMATION AVAILABLE BUT NO GUARANTEE IS GIVEN THAT ALL EXISTING UTILITIES ARE SHOWN OR THAT THE GIVEN LOCATIONS ARE EXACT. CONFIRMATION OF EXISTENCE AND EXACT LOCATION OF ALL SERVICES MUST BE OBTAINED FROM THE INDIVIDUAL UTILITIES BEFORE PROCEEDING WITH CONSTRUCTION.	
B.M. ELEV.	FIELD BOOK #
POSTED TO LBS	
DESIGNED BY TW	CHECKED BY KZ
DRAWN BY CJH	APPROVED BY KZ
HOR. SCALE 1:250	RELEASED FOR CONSTRUCTION
VERTICAL 1:50	
DATE 2004.05.28	DATE
NO. REVISIONS	DATE BY

**CITY OF WINNIPEG**  
WATER AND WASTE  
ENGINEERING DIVISION

DESIGNED BY TW  
CHECKED BY KZ  
DRAWN BY CJH  
APPROVED BY KZ  
HOR. SCALE 1:250  
VERTICAL 1:50  
DATE 2004.05.28

ENGINEER'S SEAL  
ORIGINAL SIGNED BY K.R. ZUREK  
04/05/28

**THE CITY OF WINNIPEG**  
WATER AND WASTE DEPARTMENT

2004 COMBINED SEWER RENEWALS  
BY CIPP LINING  
**COCKBURN STREET (SOUTH)**  
MH AT KYLEMORE AVENUE TO  
44.5 m S OF S R WALKER AVENUE

SHEET 2 OF 13  
CITY DRAWING NUMBER  
05443

BID OPPORTUNITY: 242-2004  
FILENAME: 105443\_44\_45\_47.dwg  
PLOT DATE: 2004 05 28