

NOTE: CHAINAGES SHOWN ARE ALONG
S. P. OF GROSVENOR AVE.

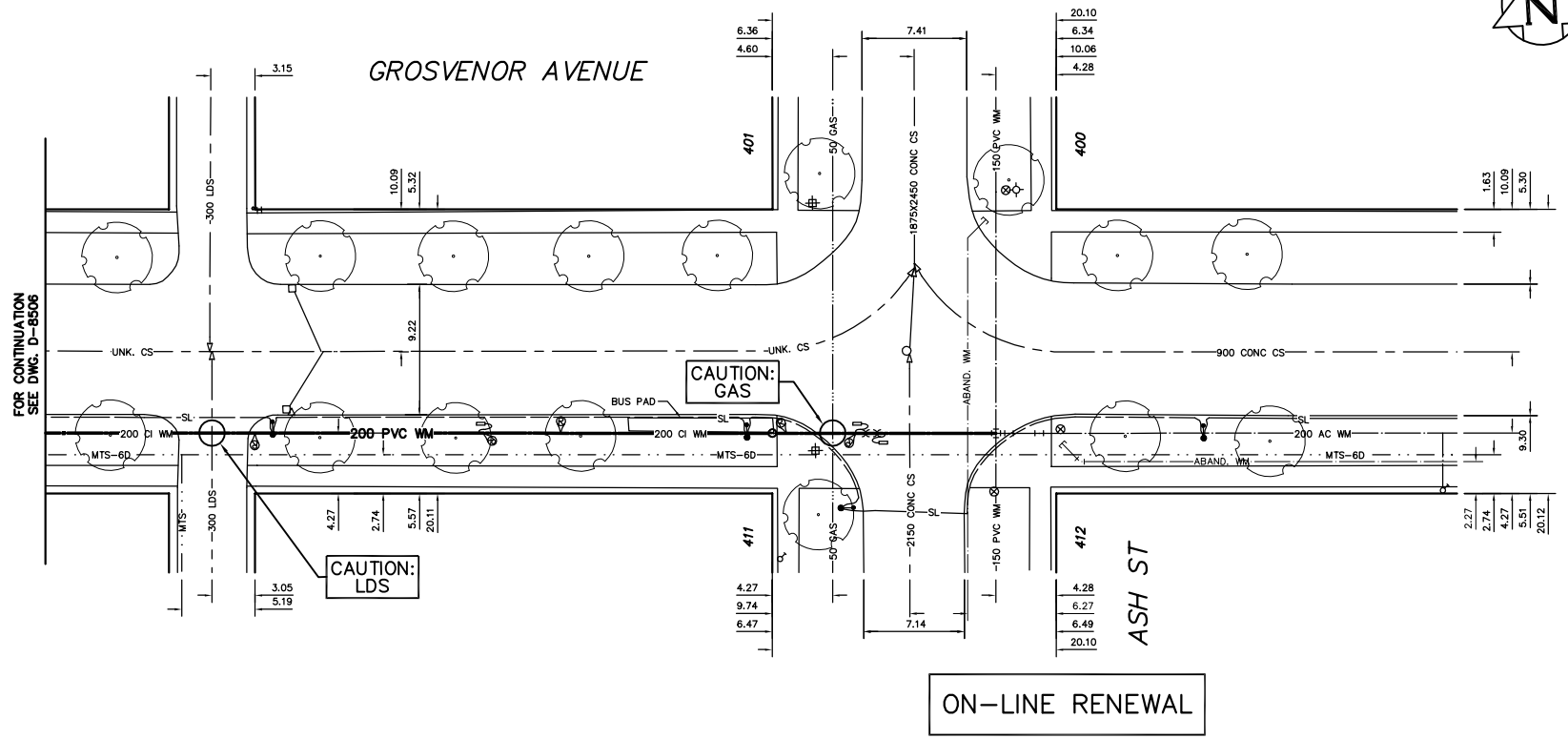

WATER SERVICE INFORMATION

ADDRESS	SIZE(mm) & TYPE (STREET)	SIZE(mm) & TYPE (PROP)	SHORT & LONG MEASUREMENT	CORP. LOCATION	REMARKS
400 ASH ST	20	20	1.98 S/NHL	0.46 S/SC	SERV. FROM ASH
401 ASH ST	20	20	0.48 S/NHL	0.3 N/SC	SERV. FROM ASH
RESIDENTIAL	COPPER	COPPER	9.88>NNL GROSVENOR		SERV. FROM ASH
411 ASH ST	20	20	1.83 S/NHL	0.91 S OF S/C	SERV. FROM ASH
RESIDENTIAL	COPPER	COPPER	4.88 SSL GROSVENOR		SERV. FROM ASH
412 ASH ST	25	20	0.46 EWL GARAGE	OPP S/C	SERV. FROM GROSVENOR
RESIDENTIAL	COPPER	COPPER	27.4 EEL ASH		SERV. FROM GROSVENOR
400 WATERLOO ST	20	20	1.37 S/NHL	OPP S/C	SERV. FROM WATERLOO
RESIDENTIAL	LEAD	LEAD	10.0>NNL GROSVENOR		SERV. FROM WATERLOO
401 WATERLOO ST	20	20	0.48 S/NHL	OPP S/C	SERV. FROM WATERLOO
RESIDENTIAL	COPPER	COPPER	10.7>NNL GROSVENOR		SERV. FROM WATERLOO
410 WATERLOO ST	20	20	2.13 S/NHL	OPP S/C	SERV. FROM WATERLOO
RESIDENTIAL	COPPER	LEAD	3.02 SSL GROSVENOR		SERV. FROM WATERLOO
411 WATERLOO ST	20	20	1.82 S/NHL	OPP S/C	SERV. FROM WATERLOO
RESIDENTIAL	LEAD	LEAD	3.05 SSL GROSVENOR		SERV. FROM WATERLOO
403 NIAGARA ST	20	13	1.25 S/NHL	0.4 N OF S/C	SERV. FROM NIAGARA
RESIDENTIAL	LEAD	LEAD	9.66>NNL GROSVENOR		SERV. FROM NIAGARA
404 NIAGARA ST	20	13	1.34 S/NHL	0.7 S OF S/C	SERV. FROM NIAGARA
RESIDENTIAL	LEAD	LEAD	9.88>NNL GROSVENOR		SERV. FROM NIAGARA
410 NIAGARA ST	20	20	1.22 S OF NHL	OPP S/C	SERV. FROM NIAGARA
RESIDENTIAL	LEAD	LEAD	2.44 SSL GROSVENOR		SERV. FROM NIAGARA
413 NIAGARA ST	25	20	2.74>NNL DOOR	10.7 N OF S/C	SERV. FROM NIAGARA
RESIDENTIAL	COPPER	LEAD	13.44 SSL GROSVENOR		SERV. FROM NIAGARA

- CONSTRUCTION NOTES**
- EXPOSE EXISTING WATERMAIN & CONFIRM INVERTS PRIOR TO CONSTRUCTION.
 - LOCATION OF ALL SERVICES TO BE CONFIRMED IN THE FIELD.
 - INSTALL WATERMAIN BY TRENCHLESS METHODS.
 - TRENCHES AND EXCAVATIONS WITHIN 1 METRE OF A PAVED AREA INCLUDING SIDEWALKS SHALL BE CLASS 3 BACKFILL.
 - ALL MATERIALS SHALL CONFORM TO THE CITY OF WINNIPEG STANDARD CONSTRUCTION SPECIFICATIONS.
 - MINIMUM COVER TO TOP OF WATERMAIN SHALL BE 2.4 m.
 - REPLACE ALL EXISTING LEAD SERVICES FROM PROPOSED WATERMAIN TO P.
 - NOTIFY ALL AFFECTED RESIDENTS AND BUSINESSES 24 HOURS IN ADVANCE OF ANY WATER SHUTDOWNS OR DISRUPTION OF SERVICE.

METRIC
WHOLE NUMBERS INDICATE MILLIMETRES
DECIMALIZED NUMBERS INDICATE METRES

NOTE: ALL VALVES TO BE INSTALLED
COUNTERCLOCKWISE TO CLOSE

WARNING

IF POWER EQUIPMENT OR EXPLOSIVES ARE TO BE USED FOR EXCAVATION ON THIS PROJECT THE CONTRACTOR MUST:

- NOTIFY THE GAS COMPANY OF THE PROPOSED LOCATION OF EXCAVATION.
- TAKE PRECAUTION TO AVOID DAMAGE TO GAS COMPANY INSTALLATIONS.

SEE PROVINCIAL REGULATION 210/72 FOR DETAILS

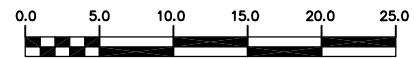

200 WM	WATERMAIN	200 WM	SL, HYDRO	150 WM	WATERMAIN	150 WM	LOCATION APPROVED UNDERGROUND STRUCTURES SUPV. U/O STRUCTURES COMMITTEE DATE NOTE: LOCATION OF UNDERGROUND STRUCTURES AS SHOWN ARE BASED ON THE BEST INFORMATION AVAILABLE BUT NO GUARANTEE IS GIVEN THAT ALL EXISTING UTILITIES ARE SHOWN OR THAT THE GIVEN LOCATIONS ARE EXACT. CONFIRMATION OF EXISTENCE AND EXACT LOCATION OF ALL SERVICES MUST BE OBTAINED FROM THE INDIVIDUAL UTILITIES BEFORE PROCEEDING WITH CONSTRUCTION.	B.M. ELEV. FIELD BOOK # POSTED TO LISB DESIGNED BY NC CHECKED BY TW DRAWN BY C/JH APPROVED BY KZ HOR. SCALE 1:250 VERTICAL 1:50 RELEASSED FOR CONSTRUCTION DATE 2004 06 11 DATE	ENGINEER'S SEAL ORIGINAL SIGNED BY K.R. ZUREK 04/06/14 BID OPPORTUNITY: 247-2004 FILENAME: D-8506-D-8507.dwg PLOT DATE: 2004 06 14	THE CITY OF WINNIPEG WATER AND WASTE DEPARTMENT 2004 WATERMAIN RENEWALS GROSVENOR AVENUE 28 m E OF E P WATERLOO STREET TO 51 m W OF ASH STREET	SHEET 7 OF 11 CITY DRAWING NUMBER D-8507
⊕	HYDRANT	⊕	MTS	⊕	HYDRANT	⊕					
⊖	VALVE	⊖	TRAFFIC SIGNALS	⊖	VALVE	⊖					
—	LAND DRAINAGE SEWER	—	GAS	—	LAND DRAINAGE SEWER	—					
—	WASTEWATER SEWER	—	SURVEY BAR	—	WASTEWATER SEWER	—					
○	MANHOLE	○	FENCE	○	PROFILE	○					
□	CATCH BASIN	□	POLE - HYDRO, MTS	□	GROUND ABOVE PIPE	□					
∇	CURB INLET	∇	CURB STOP	∇							
△	REDUCER	△	GUY ANCHOR	△							
X	COUPLING	X	LIGHT STANDARD	X							
○	ANODE	○	TREE	○							
EXISTING	LEGEND-PLAN	PROPOSED	EXISTING	LEGEND-PLAN	PROPOSED	EXISTING	LEGEND-PROFILE	PROPOSED			