

WATER SERVICE INFORMATION					
ADDRESS	SIZE(mm) & TYPE (STREET)	SIZE(mm) & TYPE (PROP)	SHORT & LONG MEASUREMENT	CORP. LOCATION	REMARKS
856 GROSVENOR AVE	13 LEAD	13	1.0 WEL FOUNDATION	0.91 W OF S/C	-
RESIDENTIAL	LEAD	LEAD	63.4 WML LILAC	-	-
859 GROSVENOR AVE	25 LEAD	25	14.36 WEL FOUNDATION	0.46 E OF S/C	WEST SERVICE
RESIDENTIAL	LEAD	LEAD	66.28 EEL WENTWORTH	-	-
859 GROSVENOR AVE	25 LEAD	25	14.08 WEL FOUNDATION	0.46 E OF S/C	EAST SERVICE
COMMERCIAL	LEAD	LEAD	68.58 EEL WENTWORTH	-	-
860 GROSVENOR AVE	13 LEAD	13	3.96 W/EHL	0.3 W OF S/C	RENEW W/ 20 COPPER
RESIDENTIAL	LEAD	LEAD	72.3 WML LILAC	-	-
862 GROSVENOR AVE	20 COPPER	20	1.52 W/EHL	1.21 W OF S/C	REV. TAPPED
RESIDENTIAL	COPPER	COPPER	85.65 WML LILAC	-	-
866 GROSVENOR AVE	13 COPPER	13	3.96 W OF EHL	0.91 W OF S/C	RENEW W/ 20 COPPER
RESIDENTIAL	COPPER	LEAD	50.9 EEL WENTWORTH	-	-
869 GROSVENOR AVE	20 COPPER	16	2.3 W/EHL	0PP S/C	REV. TAPPED
RESIDENTIAL	COPPER	LEAD	48.99 EEL WENTWORTH	-	-
871 GROSVENOR AVE	20 COPPER	20	3.2 W OF EHL	0.91 W OF S/C	RENEW W/ 20 COPPER
RESIDENTIAL	LEAD	COPPER	32.3 EEL WENTWORTH	-	-
872 GROSVENOR AVE	20 COPPER	20	1.21 W/EHL	0.3 E OF S/C	-
RESIDENTIAL	COPPER	COPPER	35.5 EEL WENTWORTH	-	-
873 GROSVENOR AVE	20 COPPER	20	1.33 W/EHL	0PP S/C	-
RESIDENTIAL	COPPER	LEAD	24.7 WML WENTWORTH	-	-
874 GROSVENOR AVE	20 COPPER	13	1.88 E/EHL	0.6 E OF S/C	-
RESIDENTIAL	COPPER	COPPER	34.75 EEL WENTWORTH	-	-
876 GROSVENOR AVE	20 COPPER	20	1.83 W OF WHL	0.91 W OF S/C	-
RESIDENTIAL	COPPER	COPPER	12.2 EEL WENTWORTH	-	-
877 GROSVENOR AVE	20 COPPER	13	4.27 W/EHL	0PP S/C	-
RESIDENTIAL	COPPER	LEAD	11.28 EEL WENTWORTH	-	-
880 GROSVENOR AVE	20 COPPER	13	1.4 E/EHL	0.91 W OF S/C	-
RESIDENTIAL	COPPER	LEAD	11.9 EEL WENTWORTH	-	-
881 GROSVENOR AVE	20 COPPER	20	3.66 E/WHL	0PP S/C	-
RESIDENTIAL	COPPER	LEAD	11.28 WML WENTWORTH	-	-
882 GROSVENOR AVE	20 COPPER	20	1.52 EWL HSE	0.3 E OF S/C	-
RESIDENTIAL	COPPER	COPPER	13.10 WML WENTWORTH	-	-
883 GROSVENOR AVE	25 COPPER	20	7.2 W/EHL	0.3 E OF S/C	CONN. TO 2-20 LEAD SERV.'S ON PROP.
RESIDENTIAL	COPPER	LEAD	23.47 WML WENTWORTH	-	-
888 GROSVENOR AVE	25 COPPER	25	5.2 WEL FOUNDATION	0.46 E OF S/C	-
RESIDENTIAL	COPPER	LEAD	25.3 WML WENTWORTH	-	-

NOTE: CHAINAGES SHOWN ARE ALONG S. R. OF GROSVENOR AVE



* SERVICES TO BE RENEWED TO R. ALL OTHERS TO BE RECONNECTED

- CONSTRUCTION NOTES**
1. EXPOSE EXISTING WATERMAIN & CONFIRM INVERTS PRIOR TO CONSTRUCTION.
 2. LOCATION OF ALL SERVICES TO BE CONFIRMED IN THE FIELD.
 3. INSTALL WATERMAIN BY TRENCHLESS METHODS.
 4. TRENCHES AND EXCAVATIONS WITHIN 1 METRE OF A PAVED AREA INCLUDING SIDEWALKS SHALL BE CLASS 3 BACKFILL.
 5. ALL MATERIALS SHALL CONFORM TO THE CITY OF WINNIPEG STANDARD CONSTRUCTION SPECIFICATIONS.
 6. MINIMUM COVER TO TOP OF WATERMAIN SHALL BE 2.4 m.
 7. REPLACE ALL EXISTING LEAD SERVICES FROM PROPOSED WATERMAIN TO R.
 8. NOTIFY ALL AFFECTED RESIDENTS AND BUSINESSES 24 HOURS IN ADVANCE OF ANY WATER SHUTDOWNS OR DISRUPTION OF SERVICE.

METRIC
WHOLE NUMBERS INDICATE MILLIMETRES
DECIMALIZED NUMBERS INDICATE METRES

NOTE: ALL VALVES TO BE INSTALLED COUNTERCLOCKWISE TO CLOSE

WARNING

IF POWER EQUIPMENT OR EXPLOSIVES ARE TO BE USED FOR EXCAVATION ON THIS PROJECT THE CONTRACTOR MUST:
1) NOTIFY THE GAS COMPANY OF THE PROPOSED LOCATION OF EXCAVATION.
2) TAKE PRECAUTION TO AVOID DAMAGE TO GAS COMPANY INSTALLATIONS.
SEE PROVINCIAL REGULATION 210/72 FOR DETAILS

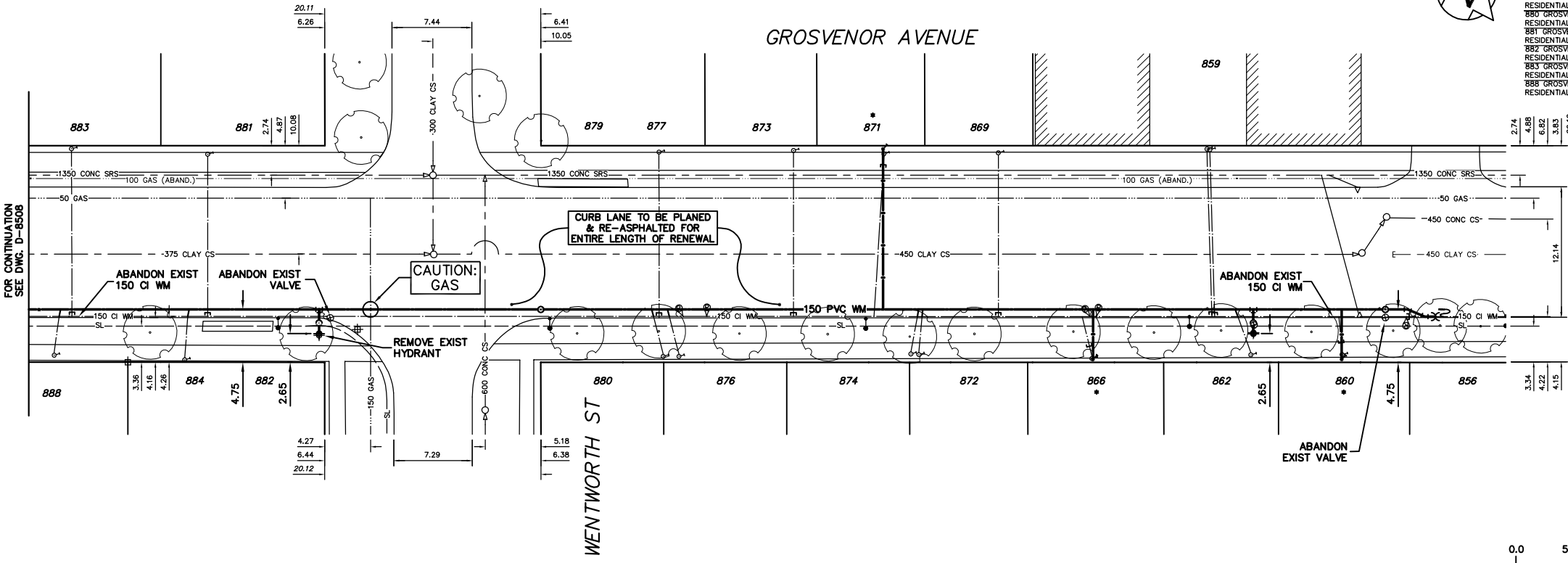
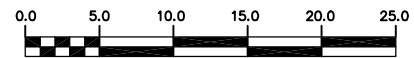

FOR CONTINUATION SEE DWG. D-8508

200 WM	WATERMAIN	200 WM	SL, HYDRO	150 WM	WATERMAIN	150 WM
⊕	HYDRANT	⊕	MTS	+	HYDRANT	+
⊖	VALVE	⊖	TRAFFIC SIGNALS	X	VALVE	X
525 LDS	LAND DRAINAGE SEWER	525 LDS	GAS	50 GAS	LAND DRAINAGE SEWER	300 LDS
375 WWS	WASTEWATER SEWER	375 WWS	SURVEY BAR	250 WWS	WASTEWATER SEWER	250 WWS
○	MANHOLE	●	FENCE	X	○ PROFILE	
□	CATCH BASIN	■	POLE - HYDRO, MTS	---	GROUND ABOVE PIPE	
▽	CURB INLET	▽	CURB STOP	⊕		
△	REDUCER	△	GUY ANCHOR			
X	COUPLING	X	LIGHT STANDARD			
⊕	ANODE	⊕	TREE			
EXISTING	LEGEND-PLAN	PROPOSED	EXISTING	LEGEND-PLAN	PROPOSED	EXISTING
				LEGEND-PROFILE	PROPOSED	

LOCATION APPROVED
UNDERGROUND STRUCTURES

SUPV. U/G STRUCTURES COMMITTEE DATE

NOTE:
LOCATION OF UNDERGROUND STRUCTURES AS SHOWN ARE BASED ON THE BEST INFORMATION AVAILABLE BUT NO GUARANTEE IS GIVEN THAT ALL EXISTING UTILITIES ARE SHOWN OR THAT THE GIVEN LOCATIONS ARE EXACT. CONFIRMATION OF EXISTENCE AND EXACT LOCATION OF ALL SERVICES MUST BE OBTAINED FROM THE INDIVIDUAL UTILITIES BEFORE PROCEEDING WITH CONSTRUCTION.

B.M. ELEV.	FIELD BOOK #
POSTED TO LBS	
NO. REVISIONS	DATE BY

CITY OF WINNIPEG
WATER AND WASTE
ENGINEERING DIVISION

DESIGNED BY: NC
CHECKED BY: TW

DRAWN BY: C.J.H.
APPROVED BY: K.Z.

HOR. SCALE: 1:250
VERTICAL: 1:50

RELEASED FOR CONSTRUCTION: 2004 06 11

ENGINEER'S SEAL

ORIGINAL SIGNED BY K.R. ZUREK
04/06/14

BID OPPORTUNITY: 247-2004
FILENAME: D-8508-D-8509.dwg
PLOT DATE: 2004 06 14

THE CITY OF WINNIPEG
WATER AND WASTE DEPARTMENT

2004 WATERMAIN RENEWALS

GROSVENOR AVENUE
125 m E OF STAFFORD STREET TO
90 m E OF WENTWORTH STREET

SHEET 9 OF 11
CITY DRAWING NUMBER
D-8509