

1 Existing Plan - 15th Tee
scale 1:500

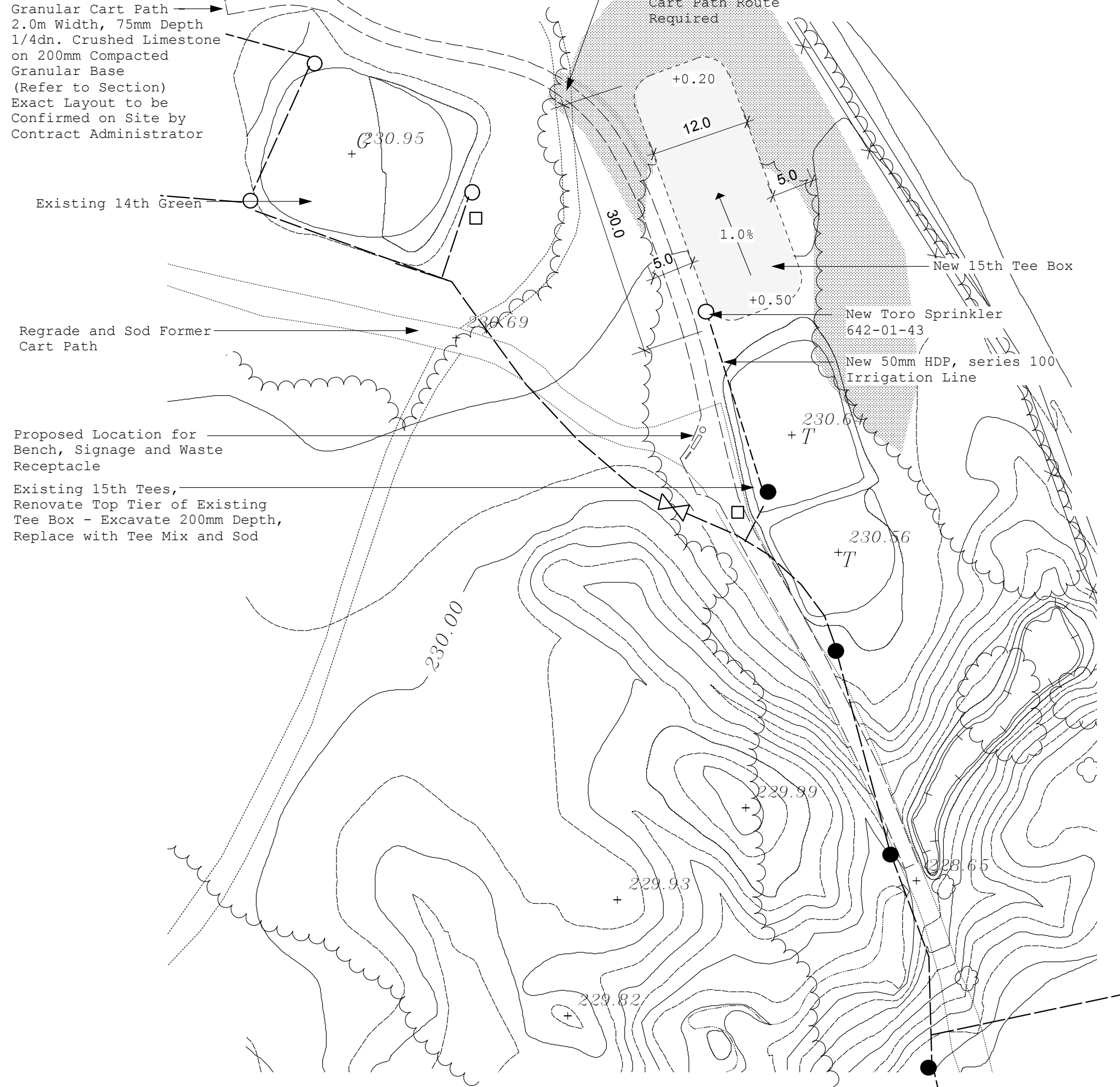

2 Grading and Layout Plan - 15th Tee Box Expansion and Renovation
scale 1:500

FOR BIDDING PURPOSES ONLY

Tee Mix shall consist of 80% sharp sand and 20% by volume organic matter, having a pH range of 6.0 to 7.5 and a salinity rating of less than 1.5 mmhos/cm. It shall be free clay lumps, stones, roots, rhizomes or other deleterious material.

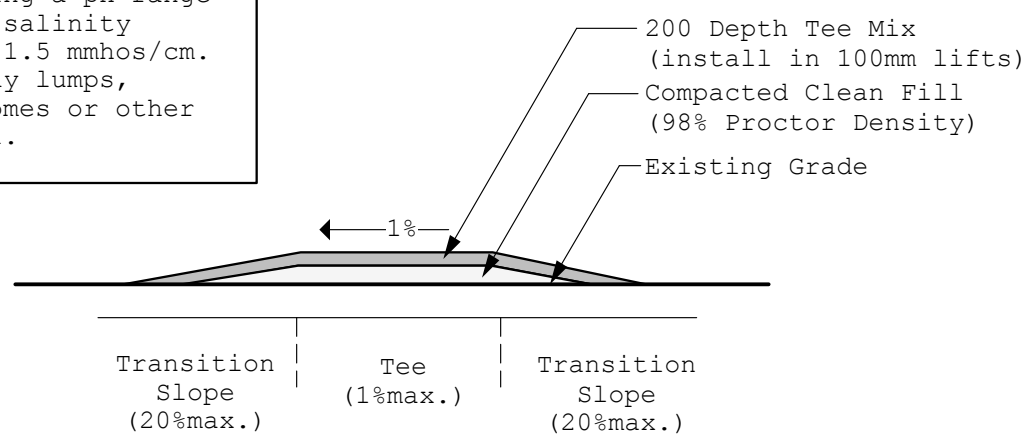

3 Section - Typical Tee Box
nts

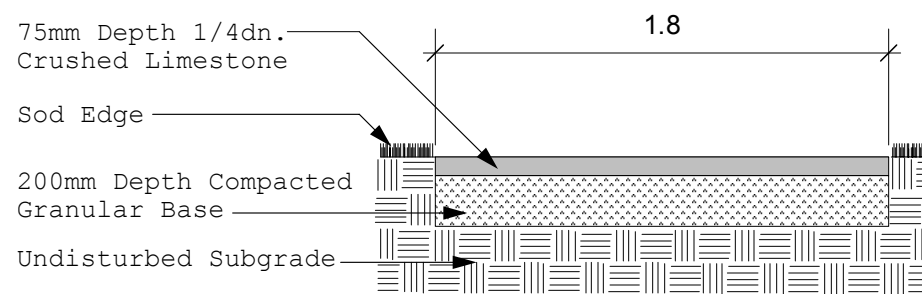

4 Section - Typical Granular Cart Path
scale 1:30

NOTES:

- Sodding shall conform to City of Winnipeg specification CW3510-R5
- Granular Cart Paths shall conform to City of Winnipeg specification CW3150-R3
- Irrigation work shall conform to City of Winnipeg specification CW3530-R3
- Earthwork and grading shall conform to City of Winnipeg specification CW3170-R3
- Clearing and grubbing work shall be conform to City of Winnipeg specification 3020-R4

THIS DRAWING SHALL NOT BE USED FOR CONSTRUCTION PURPOSES UNLESS SIGNED ACCORDINGLY.
THE CONTRACTOR SHALL CHECK ALL DIMENSIONS AND OTHER DATA ON SITE AND REPORT ANY DISCREPANCIES TO THE CONTRACT ADMINISTRATOR.
FIGURED DIMENSIONS TO BE TAKEN IN PREFERENCE TO SCALED DIMENSIONS.

DESIGNED BY: DKM	CHECKED BY:
DRAWN BY: DKM / CLA	APPROVED BY:
HOR. SCALE: as noted	RELEASED FOR CONSTRUCTION
VERT. SCALE:	
DATE: May 19 2004	CAD FILE:

SCATLIFF + MILLER + MURRAY
landscape architecture urban design golf course architecture
8th floor 44 princess street, winnipeg, m.b., r3b 1k2, tel: 204.927.3444 fax: 204.927.3443

DRAWING TITLE
WINDSOR GOLF COURSE RENOVATIONS - 2004

15th Tee Expansion

CAD DRAWING NO.
SHEET 1 OF 1
DRAWING NO.
W15T