

TEST HOLE #3

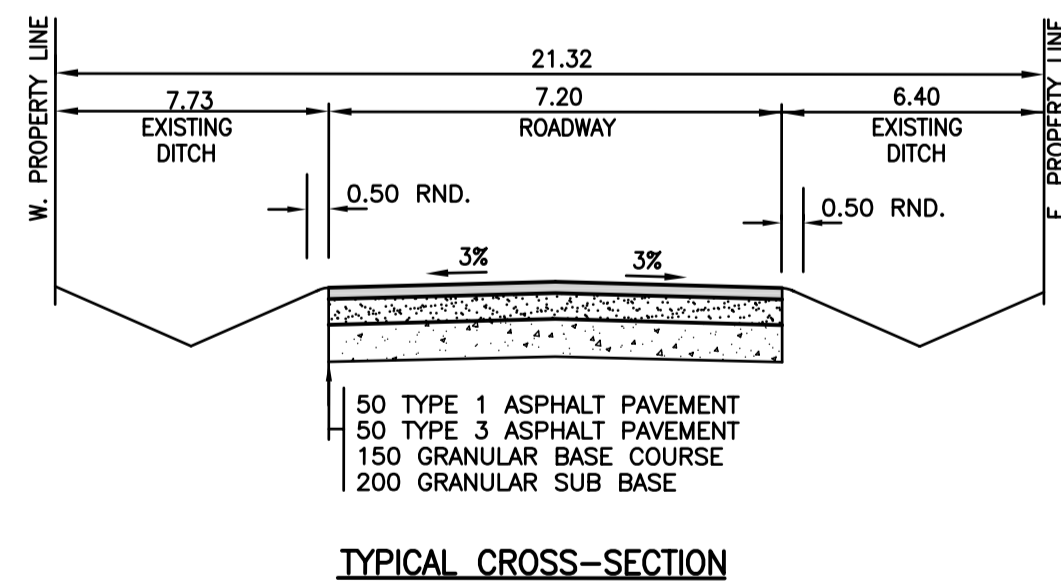

TYPICAL CROSS-SECTION

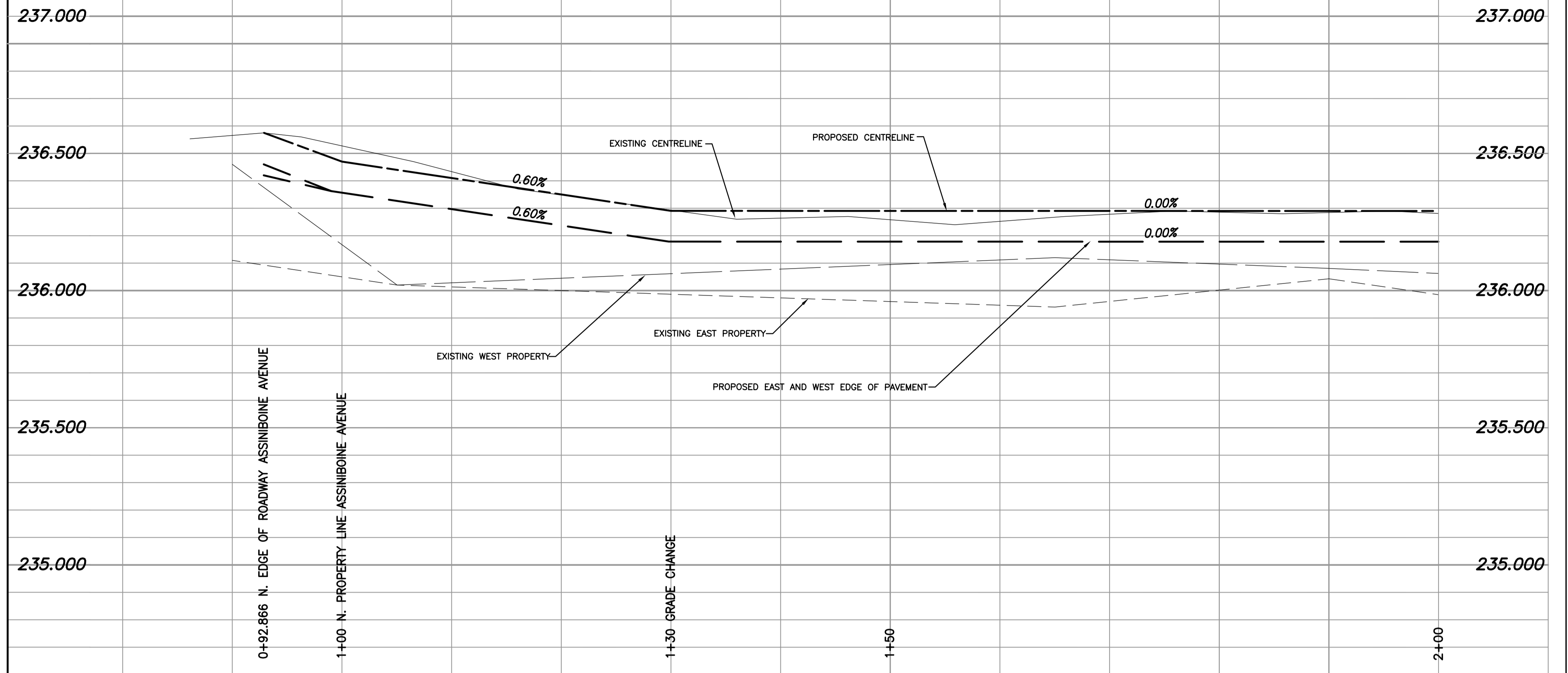
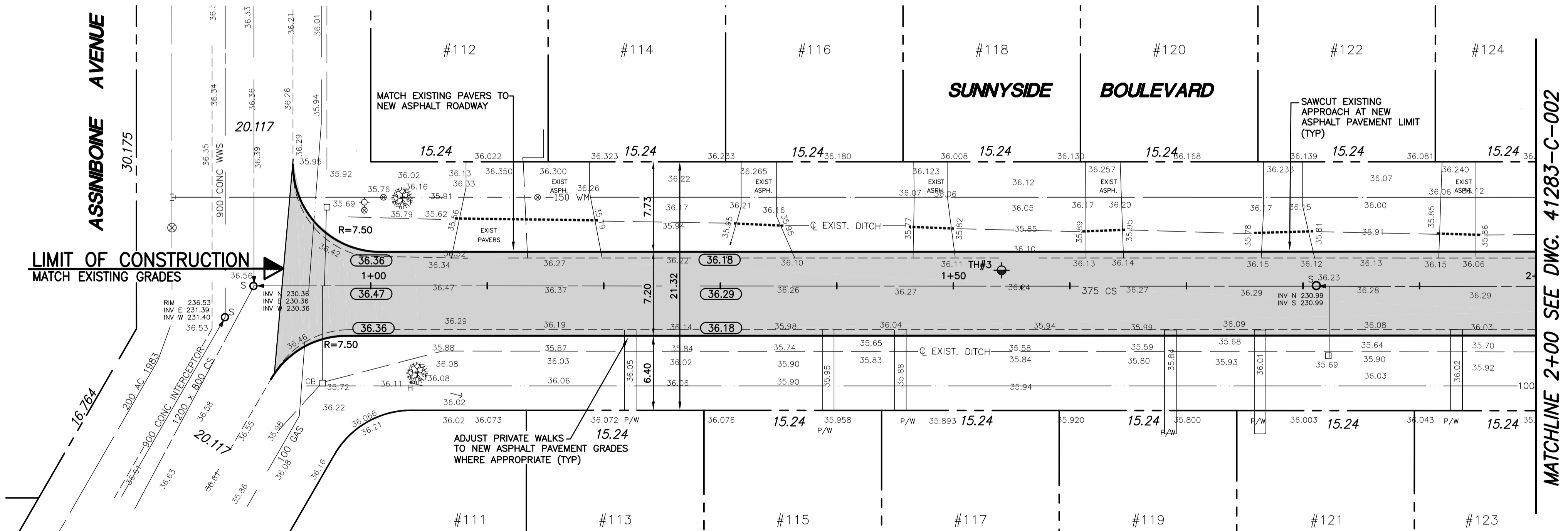

MATCHLINE 2+00 SEE DWG. 41283-C-002

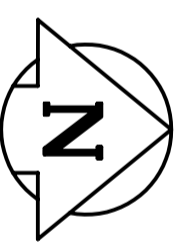

EXISTING	LEGEND-PLAN	PROPOSED	EXISTING	LEGEND-PLAN	PROPOSED	EXISTING	LEGEND-PROFILE	PROPOSED
⊕	WATERMAIN HYDRANT	⊕	⊕	CULVERT	⊕			
⊕	VALVE	⊕	⊕	HYDRO POLE	⊕			
⊕	LAND DRAINAGE SEWER	⊕	#111	PROPERTY LINE	⊕			
⊕	WASTE WATER SEWER	⊕	31.999	HOUSE NUMBERS	⊕			
⊕	MANHOLE	⊕		ELEVATION	⊕			35.000
⊕	CATCH BASIN	⊕		EDGE OF PAVEMENT	⊕			
⊕	CURB INLET	⊕		CENTRE LINE	⊕			
⊕	UTILITIES ADJUSTED	⊕		EAST & WEST EOP	⊕			
⊕	M.T.S.	⊕		ASPHALT PAVEMENT	⊕			
⊕	GAS	⊕		REGRADE GRAVEL	⊕			

LOCATIONS APPROVED UNDERGROUND STRUCTURES	
SIGNED BY:	DATE
SUPV U/G STRUCTURES	
LOCATION OF UNDERGROUND STRUCTURES AS SHOWN ARE BASED ON THE BEST INFORMATION AVAILABLE BUT NO GUARANTEE IS GIVEN THAT ALL EXISTING UTILITIES ARE SHOWN OR THAT THE GIVEN LOCATIONS ARE EXACT CONFIRMATION OF EXISTENCE AND EXACT LOCATION OF ALL SERVICES MUST BE OBTAINED FROM THE INDIVIDUAL UTILITIES BEFORE PROCEEDING	
NO.	REVISIONS
DATE	BY

G.B.M. 41-048 S. Side of Assiniboine Ave. @ Sunnyside Blvd., 7ft. on top of 0.05 m dia. x 2.4 m iron pipe, ELEV. 236.306 2 m S. of C.L. asphalt roadway of Assiniboine Ave., produced from the W. and 3.2 m E. of C.L. asphalt roadway of Sunnyside Blvd.

NSLEA Engineers & Planners Inc.
Suite 111-93 Lombard Avenue Winnipeg, Manitoba R3B 3B1
Phone (204) 943-3178 Facsimile (204) 943-4948

DESIGNED BY: RMB CHECKED BY: RMB/Dd
DRAWN BY: KG APPROVED BY: RMB
HOR. SCALE 1:250 VERTICAL 1:10
RELEASED FOR CONSTRUCTION
DATE JANUARY 14, 04 DATE

ENGINEER'S SEAL
PROVINCE OF MANITOBA
R.M. BORODY
REGISTERED PROFESSIONAL ENGINEER
CONSULTANT ACAD DWG. NO.
41283-C-001

THE CITY OF WINNIPEG
PUBLIC WORKS DEPARTMENT
ENGINEERING SERVICES DIVISION

2004 RESIDENTIAL STREET RENEWAL PROGRAM
ASPHALT PAVEMENT RECONSTRUCTION
SUNNYSIDE BOULEVARD
ASSINIBOINE AVENUE TO Sta. 2+00

CITY DRAWING NUMBER
SHEET 1 OF 3
BID NO. 30-2004