

TEST HOLE #2

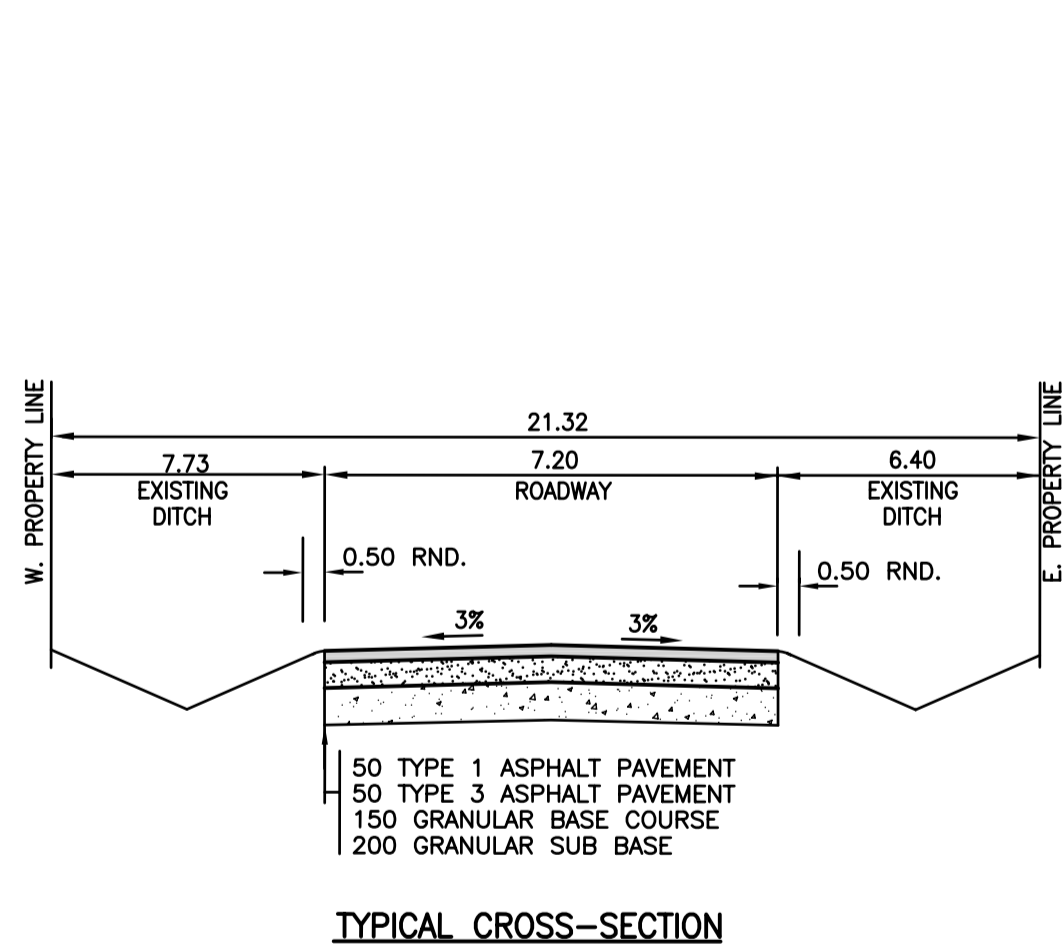

TYPICAL CROSS-SECTION

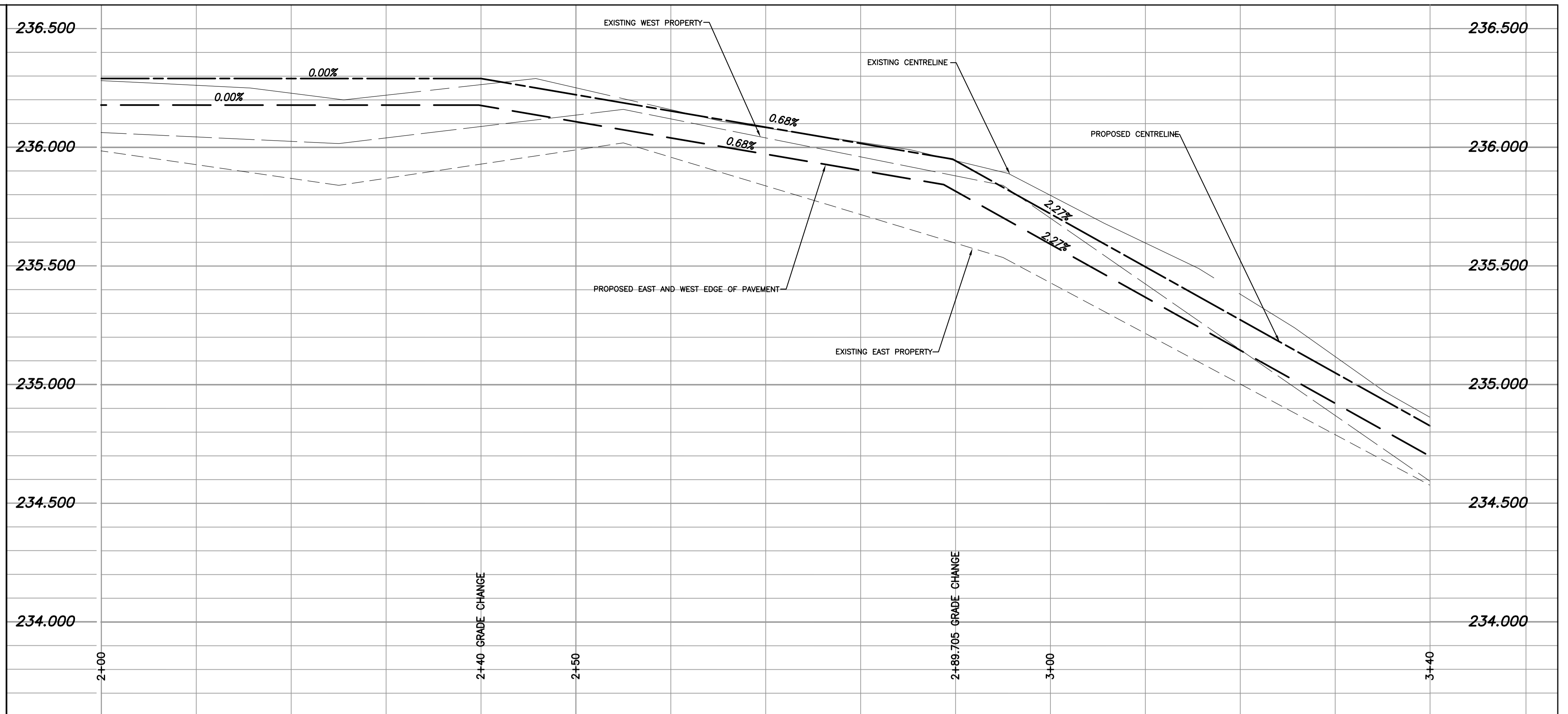
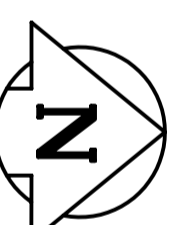
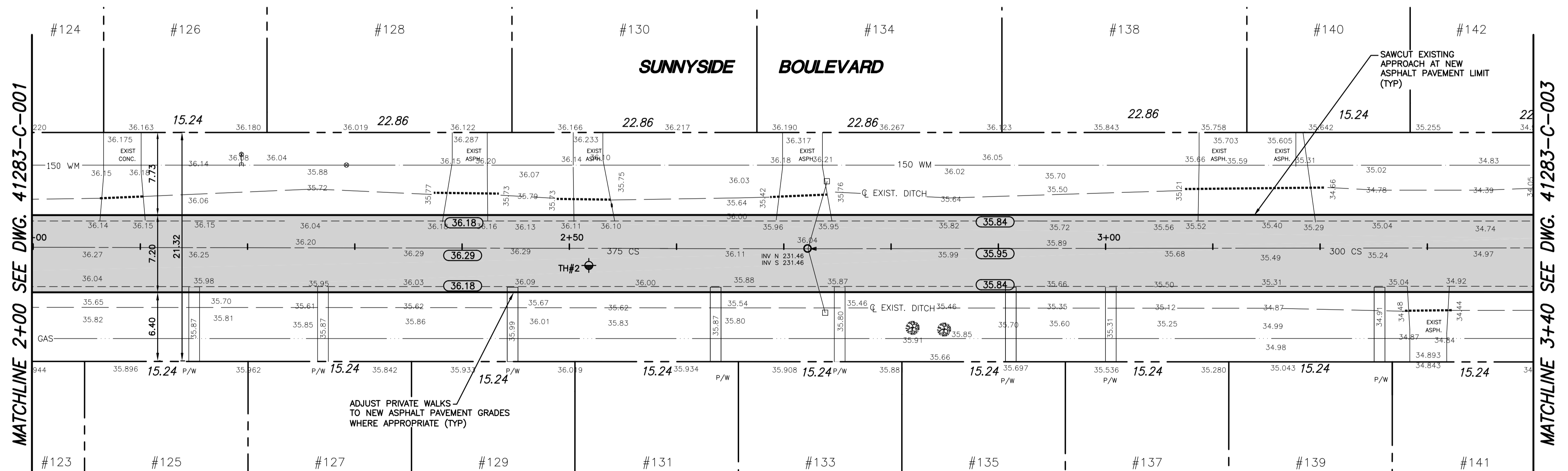

EXISTING	LEGEND-PLAN	PROPOSED	EXISTING	LEGEND-PLAN	PROPOSED	EXISTING	LEGEND-PROFILE	PROPOSED
—	WATERMAIN	—	—	CULVERT	—	—	LOCATIONS APPROVED	—
—	HYDRANT	—	—	HYDRO POLE	—	—	UNDERGROUND	—
—	VALVE	—	—	PROPERTY LINE	—	—	STRUCTURES	—
—	LAND DRAINAGE SEWER	—	—	HOUSE NUMBERS	—	—	SIGNED BY:	—
—	WASTE WATER SEWER	—	—	ELEVATION	—	—	SUPV U/G STRUCTURES	—
—	MANHOLE	—	—	EDGE OF PAVEMENT	—	—	DATE	—
—	CATCH BASIN	—	—	CENTRE LINE	—	—	LOCATION OF UNDERGROUND STRUCTURES AS SHOWN ARE BASED ON THE BEST INFORMATION AVAILABLE BUT NO GUARANTEE IS GIVEN THAT ALL EXISTING UTILITIES ARE SHOWN OR THAT THE GIVEN LOCATIONS ARE EXACT CONFIRMATION OF EXISTENCE AND EXACT LOCATION OF ALL SERVICES MUST BE OBTAINED FROM THE INDIVIDUAL UTILITIES BEFORE PROCEEDING	—
—	CURB INLET	—	—	EAST & WEST EOP	—	—	G.B.M. 41-048 S. Side of Assiniboine Ave., Sunnyside Blvd., 1/2" on top of 0.05 m dia. X 2.4 m iron pipe, ELEV. 236.306 5 m S. of C.L. asphalt roadway of Assiniboine Ave., produced from the W. and 3.2 m E. of C.L. asphalt roadway of Sunnyside Blvd.	—
—	UTILITIES ADJUSTED	—	—	ASPHALT PAVEMENT	—	—	NSLEA Engineers & Planners Inc. Suite 111-93 Lombard Avenue Winnipeg, Manitoba R3B 3B1 Phone (204) 943-3178 Facsimile (204) 943-4948	—
—	M.T.S.	—	—	REGRADE GRAVEL	—	—	DESIGNED BY: RMB	—
—	GAS	—	—		—	—	CHECKED BY: RMB/Dd	—
—		—	—		—	—	DRAWN BY: KG	—
—		—	—		—	—	APPROVED BY: RMB	—
—		—	—		—	—	HOR. SCALE 1:250	—
—		—	—		—	—	VERTICAL 1:10	—
—		—	—		—	—	RELEASED FOR CONSTRUCTION	—

NO.	REVISIONS	DATE	BY

ENGINEER'S SEAL	CONSULTANT ACAD. DWG. NO.
	41283-C-002

THE CITY OF WINNIPEG PUBLIC WORKS DEPARTMENT ENGINEERING SERVICES DIVISION	
2004 RESIDENTIAL STREET RENEWAL PROGRAM	CITY DRAWING NUMBER
ASPHALT PAVEMENT RECONSTRUCTION SUNNYSIDE BOULEVARD	SHEET 2 OF 3
Sta. 2+00 TO Sta. 3+40	BID NO. 30-2004