

SEWER SERVICE INFORMATION (ID #20024) *	
DISTANCE FROM 2ND MH N. OF LYNDALE DR. (MH ID #20023)	
84.8 N	SERVICE CONNECTION E
24.5 N	SERVICE CONNECTION E
39.3 N	SERVICE CONNECTION E
54.1 N	SERVICE CONNECTION E
63.5 N	SERVICE CONNECTION E
69.7 N	SERVICE CONNECTION E
85.2 N	SERVICE CONNECTION W
86.2 N	SERVICE CONNECTION E

* - INFORMATION FROM SEWER VIDEO INSPECTION

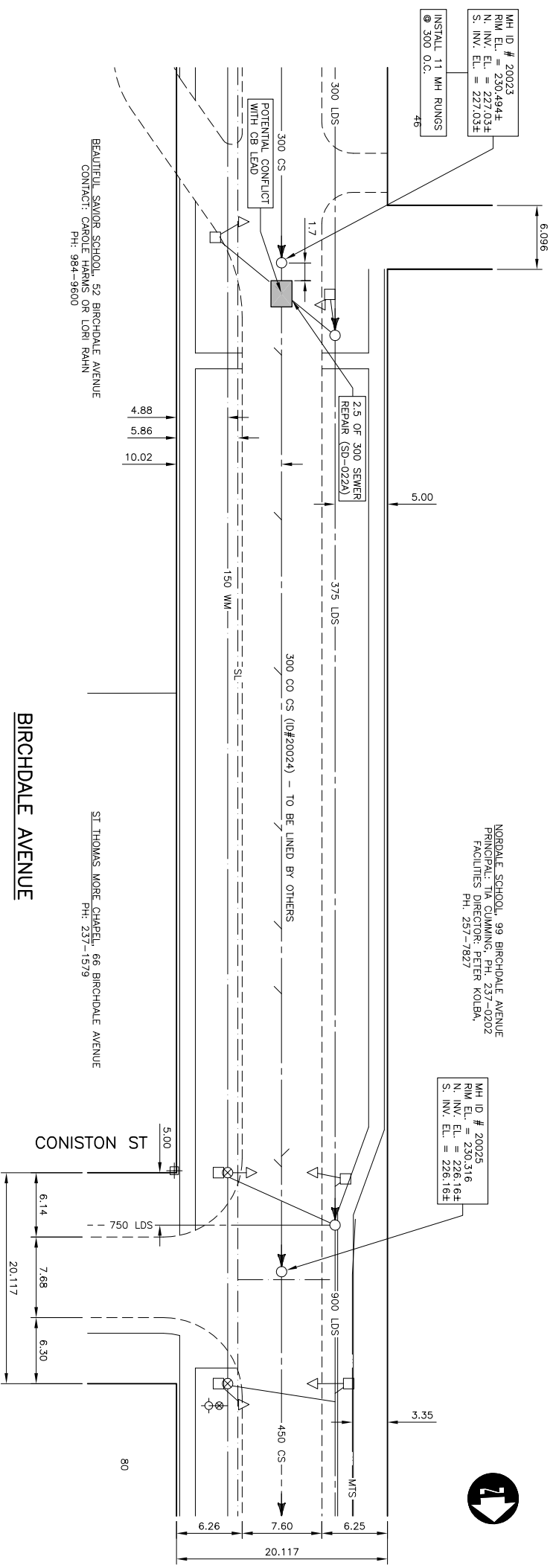

EXISTING	LEGEND-PLAN	PROPOSED	EXISTING	LEGEND-PLAN	PROPOSED	EXISTING	LEGEND-PROFILE	PROPOSED
150 mm W.M.	WATERMAIN	150 mm W.M.	150 mm W.M.	WATERMAIN	150 mm W.M.			
300 mm U.S.	HYDRANT VALVE	300 mm U.S.	300 mm U.S.	HYDRANT VALVE	300 mm U.S.			
250 mm W.M.S.	LAND DRAINAGE SEWER	250 mm W.M.S.	250 mm W.M.S.	LAND DRAINAGE SEWER	250 mm W.M.S.			
	MANHOLE			MANHOLE				
	CATCH BASIN			CATCH BASIN				
	CULVERT			CULVERT				
	JUNCTIONS			JUNCTIONS				
	GAS			GAS				
	PROPERTY LINE			PROPERTY LINE				
	SURVEY BAR			SURVEY BAR				
	SURVEY VALVE			SURVEY VALVE				
	I.P.S.			I.P.S.				
	BUILDING			BUILDING				

UNDERGROUND STRUCTURES	DATE
SYN. U/S STRUCTURES	

B.M. ELEV.	DESIGNED BY	A.R.P.
	BY	
	DRAWN BY	S.C.C.
	CHECKED BY	P.M.K.
	APPROVED	

NO.	REGIONS	DATE	BY	DATE
1	SUBMITTED TO WAW FOR REVIEW	06/29/04	P.M.K.	
2	ISSUED FOR TENDER	07/23/04	P.M.K.	

DILLON CONSULTING

RELEASED FOR CONSTRUCTION

DATE: JUNE 2004

ENGINEER'S SEAL	CONSULTANT DRAWING NO. 043032-09
-----------------	----------------------------------

THE CITY OF WINNIPEG WATER AND WASTE DEPARTMENT

2004 COMBINED SEWER RENEWALS AND REPAIRS - CONTRACT 10

BIRCHDALE AVENUE

2ND MH NORTH OF LYNDALE DR TO MH AT CONISTON ST (CL)

CITY DRAWING NUMBER: 05501

SHEET 9 OF 17

BID OPPORTUNITY NO. 305-2004

WARNING

IF POWER EQUIPMENT OR EXPLOSIVES ARE TO BE USED NEAR EQUIPMENT ON THIS PROJECT THE CONTRACTOR MUST:

1. NOTIFY THE GAS COMPANY OF THE PROPOSED LOCATION OF EXCAVATION.
2. TAKE PRECAUTION TO AVOID DAMAGE TO GAS COMPANY INSTALLATIONS

SEE PROVINCIAL REGULATION 210/72 FOR DETAILS

METRIC

WHOLE NUMBERS INDICATE MILLIMETRES
DECIMALIZED NUMBERS INDICATE METRES