

- CONSTRUCTION NOTES:**
- SEWER TO BE RENEWED OFF-LINE BY TRENCHLESS METHODS.
  - CONFIRM THE LOCATION OF ALL SEWER SERVICES.
  - RENEW SEWER SERVICES TO R.
  - BACKFILL UNDER PAVEMENT, IN SIDEWALKS, & WITHIN 1.0 m OF PAVEMENT TO BE CLASS 3.
  - BACKFILL IN BOULEVARD TO BE CLASS 5.
  - SEWER SERVICE RISERS TO BE INSTALLED WHEN COMBINED SEWER EXCEEDS 4.25 m IN DEPTH.
  - INSTALL TEE INCLUDING RISERS & PLUG FOR FUTURE SERVICE CONNECTION OF EXISTING WYED SEWER SERVICES AS SHOWN ON DRAWINGS OR AS DIRECTED BY THE CONTRACT ADMINISTRATOR.
  - CATCHBASIN LEADS TO BE INSTALLED AT MINIMUM 1.0% SLOPE OR AS DIRECTED BY THE CONTRACT ADMINISTRATOR.

NOTE: CHAINAGES SHOWN ARE ALONG S. R. OF MACHRAY AVE.

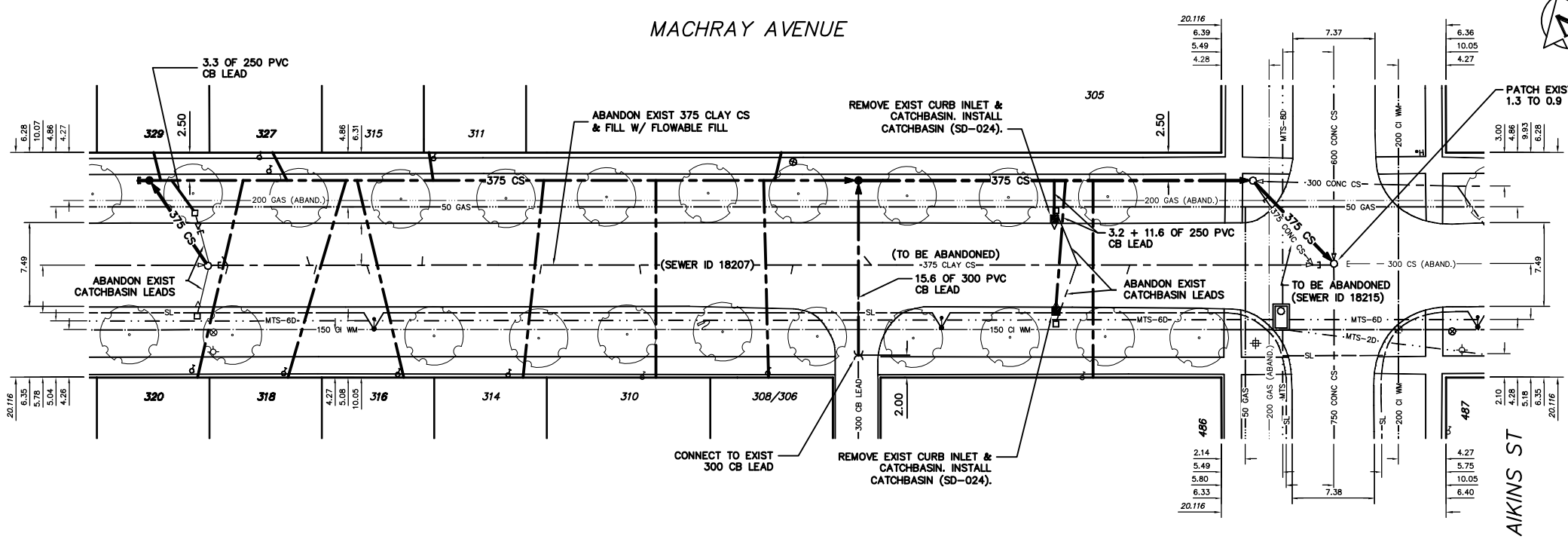

SEWER SERVICE INFORMATION			
ADDRESS	SIZE	R DIST	JUNCTION TIE
486 AIKINS ST		11.52 W OF EL	
RESIDENTIAL		18.29 W MH @ AIKINS	
487 AIKINS ST		13.0 E OF WL	
COMMERCIAL		18.29 E MH @ AIKINS	
305 MACHRAY AVE		22.66 E OF WL	
COMMERCIAL		41.45 W MH @ AIKINS	
308/306 MACHRAY AVE		5.79 W OF EL	
RESIDENTIAL		48.46 W MH @ AIKINS	
310 MACHRAY AVE		4.90 W OF EL	
RESIDENTIAL		62.21 W MH @ AIKINS	
311 MACHRAY AVE		0.46 E OF WL #311	
RESIDENTIAL		81.69 W MH @ AIKINS	
314 MACHRAY AVE		2.13 W OF EL	
RESIDENTIAL		71.02 W MH @ AIKINS	
315 MACHRAY AVE		0.46 E OF WL #311	
RESIDENTIAL		81.69 W MH @ AIKINS	
316 MACHRAY AVE		2.74 W OF EL	
RESIDENTIAL		86.63 W MH @ AIKINS	
318 MACHRAY AVE		3.05 W OF EL	
RESIDENTIAL		91.14 W MH @ AIKINS	
320 MACHRAY AVE		1.22 W OF EL	
RESIDENTIAL		99.05 W MH @ AIKINS	
327 MACHRAY AVE		4.42 W OF EL	
RESIDENTIAL		91.74 W MH @ AIKINS	
329 MACHRAY AVE		5.04 W OF EL	
RESIDENTIAL		99.07 W MH @ AIKINS	

SEWER JUNCTION INFORMATION 1ST MH E. OF SALTER ST. (2+10.65) TO * MH @ AIKINS ST. (3+11.52)			
DISTANCE FROM 1ST MH E. OF SALTER ST. (2+10.65)			
1.40	E	150#	SOUTH
9.10	E	150#	NORTH
10.70	E	150#	SOUTH
19.30	E	150#	NORTH
20.10	E	150#	SOUTH
30.10	E	150#	SOUTH
38.60	E	150#	SOUTH
39.20	E	150#	NORTH
52.50	E	150#	SOUTH
59.30	E	150#	NORTH
59.60	E	150#	NORTH
60.10	E	200#	SOUTH
68.00	E	150#	NORTH
76.40	E	150#	SOUTH
77.10	E	150#	NORTH
82.60	E	150#	SOUTH
96.50	E	150#	SOUTH
99.00	E	375#	NORTH

**METRIC**  
WHOLE NUMBERS INDICATE MILLIMETRES  
DECIMALIZED NUMBERS INDICATE METRES

**WARNING**  
IF POWER EQUIPMENT OR EXPLOSIVES ARE TO BE USED FOR EXCAVATION ON THIS PROJECT THE CONTRACTOR MUST:  
1) NOTIFY THE GAS COMPANY OF THE PROPOSED LOCATION OF EXCAVATION.  
2) TAKE PRECAUTION TO AVOID DAMAGE TO GAS COMPANY INSTALLATIONS.  
SEE PROVINCIAL REGULATION 210/72 FOR DETAILS

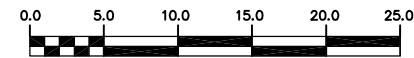

200 WM	WATERMAIN	200 WM	SL, HYDRO	150 WM	WATERMAIN	150 WM
+	HYDRANT	+	MTS	+	HYDRANT	+
o	VALVE	o	TRAFFIC SIGNALS	o	VALVE	o
525 LDS	LAND DRAINAGE SEWER	525 LDS	GAS	50 GAS	300 LDS	LAND DRAINAGE SEWER
375 WWS	WASTEWATER SEWER	375 WWS	SURVEY BAR	250 WWS	WASTEWATER SEWER	250 WWS
o	MANHOLE	o	FENCE	o	PROFILE	
□	CATCH BASIN	□	POLE - HYDRO, MTS	□	GROUND ABOVE PIPE	
▽	CURB INLET	▽	CURB STOP	▽	DITCH (SOUTH & EAST)	
+	JUNCTIONS	+	GUY ANCHOR	+	GUTTER (NORTH & WEST)	
+	CULVERT	+	LIGHT STANDARD			
+	ANODE	+	TREE			
EXISTING	LEGEND-PLAN	PROPOSED	EXISTING	LEGEND-PLAN	PROPOSED	EXISTING

LOCATION APPROVED UNDERGROUND STRUCTURES		B.M. ELEV.	FIELD BOOK #
SUPV. U/G STRUCTURES COMMITTEE	DATE		
NOTE: LOCATION OF UNDERGROUND STRUCTURES AS SHOWN ARE BASED ON THE BEST INFORMATION AVAILABLE BUT NO GUARANTEE IS GIVEN THAT ALL EXISTING UTILITIES ARE SHOWN OR THAT THE GIVEN LOCATIONS ARE EXACT. CONFIRMATION OF EXISTENCE AND EXACT LOCATION OF ALL SERVICES MUST BE OBTAINED FROM THE INDIVIDUAL UTILITIES BEFORE PROCEEDING WITH CONSTRUCTION.			
NO.	REVISIONS	DATE	BY

**CITY OF WINNIPEG**  
WATER AND WASTE  
ENGINEERING DIVISION

DESIGNED BY: SC  
CHECKED BY: TW

DRAWN BY: CJH  
APPROVED BY: KZ

HOR. SCALE: 1:250  
VERTICAL: 1:50

RELEASED FOR CONSTRUCTION: 2004.08.11

ENGINEER'S SEAL  
ORIGINAL SIGNED BY K.R. ZUREK  
04/08/11

**THE CITY OF WINNIPEG**  
WATER AND WASTE DEPARTMENT

2004 COMBINED SEWER RENEWALS AND ASSOCIATED WORKS  
**MACHRAY AVENUE**  
80 m E OF E R. SALTER STREET TO MH AT AIKINS STREET

SHEET 4 OF 9  
CITY DRAWING NUMBER: 05515