

- CONSTRUCTION NOTES:**
- SEWER TO BE RENEWED OFF-LINE BY TRENCHLESS METHODS.
 - CONFIRM THE LOCATION OF ALL SEWER SERVICES.
 - RENEW SEWER SERVICES TO R.
 - BACKFILL UNDER PAVEMENT, IN SIDEWALKS, & WITHIN 1.0 m OF PAVEMENT TO BE CLASS 3.
 - BACKFILL IN BOULEVARD TO BE CLASS 5.
 - SEWER SERVICE RISERS TO BE INSTALLED WHEN COMBINED SEWER EXCEEDS 4.25 m IN DEPTH.
 - INSTALL TEE INCLUDING RISERS & PLUG FOR FUTURE SERVICE CONNECTION OF EXISTING WYED SEWER SERVICES AS SHOWN ON DRAWINGS OR AS DIRECTED BY THE CONTRACT ADMINISTRATOR.
 - CATCHBASIN LEADS TO BE INSTALLED AT MINIMUM 1.0% SLOPE OR AS DIRECTED BY THE CONTRACT ADMINISTRATOR.

NOTE: CHAINAGES SHOWN ARE ALONG E. R. OF LENORE ST.

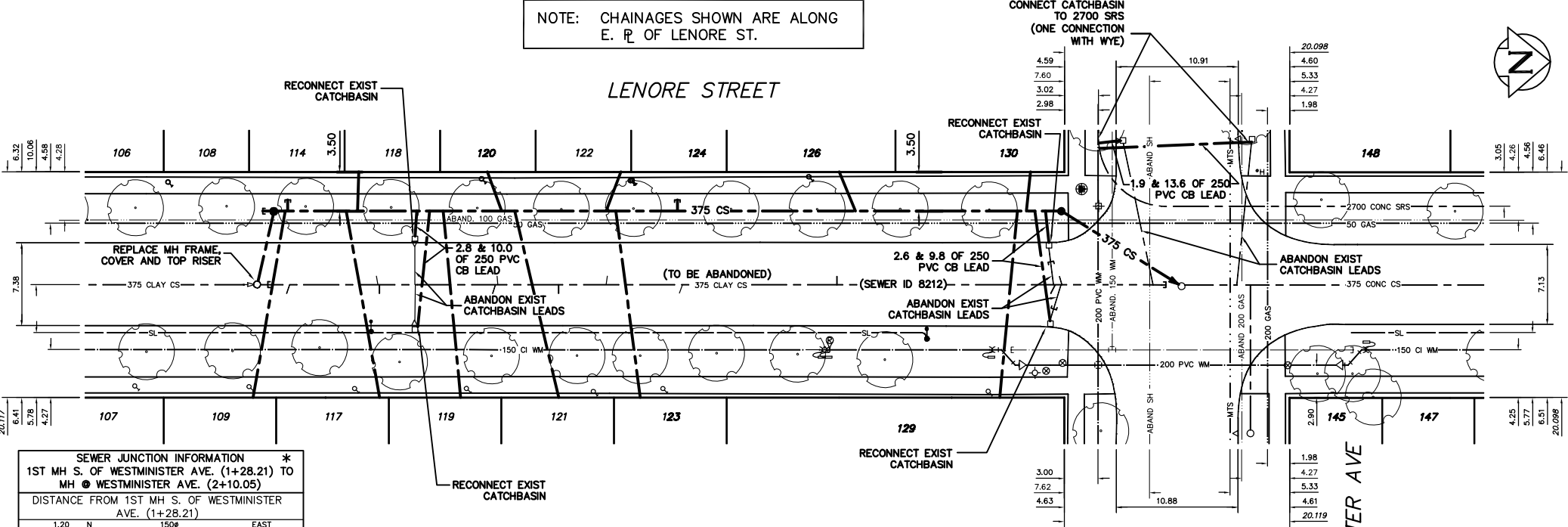

SEWER SERVICE INFORMATION

ADDRESS	SIZE	R DIST	JUNCTION TIE
106 LENORE ST	RESIDENTIAL	-	-
107 LENORE ST	RESIDENTIAL	-	NO INFORMATION AVAILABLE
108 LENORE ST	RESIDENTIAL	-	NO INFORMATION AVAILABLE
109 LENORE ST	RESIDENTIAL	-	NO INFORMATION AVAILABLE
110 LENORE ST	RESIDENTIAL	79.65 S MH @ WESTMINSTER	-
111 LENORE ST	RESIDENTIAL	-	NO INFORMATION AVAILABLE
112 LENORE ST	RESIDENTIAL	71.63 S MH @ WESTMINSTER	-
113 LENORE ST	RESIDENTIAL	-	NO INFORMATION AVAILABLE
114 LENORE ST	RESIDENTIAL	3.66 S OF NL	-
115 LENORE ST	RESIDENTIAL	61.26 S MH @ WESTMINSTER	-
116 LENORE ST	RESIDENTIAL	-	NO INFORMATION AVAILABLE
117 LENORE ST	RESIDENTIAL	-	NO INFORMATION AVAILABLE
118 LENORE ST	RESIDENTIAL	-	NO INFORMATION AVAILABLE
119 LENORE ST	RESIDENTIAL	-	NO INFORMATION AVAILABLE
120 LENORE ST	RESIDENTIAL	-	NO INFORMATION AVAILABLE
121 LENORE ST	RESIDENTIAL	DBL. SERV. W/#123	-
122 LENORE ST	RESIDENTIAL	55.63 S MH @ WESTMINSTER	-
123 LENORE ST	RESIDENTIAL	-	NO INFORMATION AVAILABLE
124 LENORE ST	RESIDENTIAL	DBL. SERV. W/#121	-
125 LENORE ST	RESIDENTIAL	55.63 S MH @ WESTMINSTER	-
126 LENORE ST	RESIDENTIAL	-	NO INFORMATION AVAILABLE
127 LENORE ST	RESIDENTIAL	-	NO INFORMATION AVAILABLE
128 LENORE ST	RESIDENTIAL	30.78 S MH @ WESTMINSTER	-
129 LENORE ST	RESIDENTIAL	5.79 S OF NL	-
130 LENORE ST	RESIDENTIAL	11.28 S MH @ WESTMINSTER	-
131 LENORE ST	RESIDENTIAL	3.05 S OF NL	-
132 LENORE ST	RESIDENTIAL	10.67 S MH @ WESTMINSTER	-
133 LENORE ST	RESIDENTIAL	8.23 N OF SL	-
134 LENORE ST	RESIDENTIAL	58.52 S 2ND MH S PRESTON	-
135 LENORE ST	RESIDENTIAL	DBL. SERV. W/#149	-
136 LENORE ST	RESIDENTIAL	49.07 S 2ND MH S PRESTON	-
137 LENORE ST	RESIDENTIAL	-	NO INFORMATION AVAILABLE
138 LENORE ST	RESIDENTIAL	-	NO INFORMATION AVAILABLE

SEWER JUNCTION INFORMATION

* 1ST MH S. OF WESTMINSTER AVE. (1+28.21) TO MH @ WESTMINSTER AVE. (2+10.05)

DISTANCE FROM 1ST MH S. OF WESTMINSTER AVE. (1+28.21)

Distance	Direction	Size	Material
1.20	N	150	EAST
9.90	N	200	EAST
10.60	N	200	WEST
15.00	N	250	EAST
20.50	N	150	EAST
21.20	N	150	WEST
26.20	N	150	EAST
30.10	N	150	EAST
30.90	N	150	WEST
49.90	N	150	WEST
70.80	N	150	EAST
71.10	N	200	TOP
72.30	N	150	EAST
77.90	N	150	WEST

*** INFORMATION FROM SEWER VIDEO INSPECTION**

200 WM	WATERMAIN	200 WM	SL, HYDRO	150 WM	WATERMAIN	150 WM
+	HYDRANT	+	MTS	+	HYDRANT	+
o	VALVE	o	TRAFFIC SIGNALS	o	VALVE	o
525 LDS	LAND DRAINAGE SEWER	525 LDS	GAS	50 GAS	300 LDS	LAND DRAINAGE SEWER
375 WWS	WASTEWATER SEWER	375 WWS	SURVEY BAR	250 WWS	250 WWS	WASTEWATER SEWER
o	MANHOLE	o	FENCE	x	o	PROFILE
□	CATCH BASIN	□	POLE - HYDRO, MTS		□	GROUND ABOVE PIPE
▽	CURB INLET	▽	CURB STOP	o	o	DITCH (SOUTH & EAST)
+	JUNCTIONS	+	GUY ANCHOR	△	△	GUTTER (NORTH & WEST)
▽	CULVERT	▽	LIGHT STANDARD	□	□	
o	ANODE	o	TREE			
EXISTING	LEGEND-PLAN	PROPOSED	EXISTING	LEGEND-PLAN	PROPOSED	EXISTING
				LEGEND-PROFILE		PROPOSED

LOCATION APPROVED UNDERGROUND STRUCTURES

SUPV. U/G STRUCTURES COMMITTEE	DATE

NOTE: LOCATION OF UNDERGROUND STRUCTURES AS SHOWN ARE BASED ON THE BEST INFORMATION AVAILABLE BUT NO GUARANTEE IS GIVEN THAT ALL EXISTING UTILITIES ARE SHOWN OR THAT THE GIVEN LOCATIONS ARE EXACT. CONFIRMATION OF EXISTENCE AND EXACT LOCATION OF ALL SERVICES MUST BE OBTAINED FROM THE INDIVIDUAL UTILITIES BEFORE PROCEEDING WITH CONSTRUCTION.

CITY OF WINNIPEG WATER AND WASTE ENGINEERING DIVISION

DESIGNED BY: SC
CHECKED BY: TW
DRAWN BY: CJH
APPROVED BY: KZ

HOR. SCALE: 1:250
VERTICAL: 1:50
DATE: 2004.08.11

ENGINEER'S SEAL
ORIGINAL SIGNED BY K.R. ZUREK
04/08/11

THE CITY OF WINNIPEG WATER AND WASTE DEPARTMENT

2004 COMBINED SEWER RENEWALS AND ASSOCIATED WORKS
LENORE STREET
MH AT WESTMINSTER AVENUE TO 1ST MH S OF WESTMINSTER AVENUE

SHEET 6 OF 9
CITY DRAWING NUMBER 05517

WARNING

IF POWER EQUIPMENT OR EXPLOSIVES ARE TO BE USED FOR EXCAVATION ON THIS PROJECT THE CONTRACTOR MUST:

- NOTIFY THE GAS COMPANY OF THE PROPOSED LOCATION OF EXCAVATION.
- TAKE PRECAUTION TO AVOID DAMAGE TO GAS COMPANY INSTALLATIONS.

SEE PROVINCIAL REGULATION 210/72 FOR DETAILS

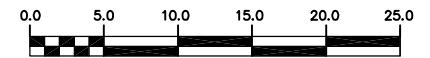

METRIC
WHOLE NUMBERS INDICATE MILLIMETRES
DECIMALIZED NUMBERS INDICATE METRES