

<b>WATERMAIN</b> 200 MM HYDRANT VALVE LAND DRAINAGE SEWER WASTEWATER SEWER MANHOLE CATCH BASIN CURB INLET JUNCTIONS CULVERT ANODE		<b>EXISTING</b> 150 WM HYDRANT VALVE 50 GAS LAND DRAINAGE SEWER WASTEWATER SEWER 50 GMS SURVEY BAR POLE - HYDRO. MTS GUY ANCHOR LIGHT STANDARD TREE		<b>PROPOSED</b> 150 WM WATERMAIN 50 GAS LAND DRAINAGE SEWER WASTEWATER SEWER 50 GMS SURVEY BAR POLE - HYDRO. MTS GUY ANCHOR LIGHT STANDARD TREE		<b>LEGEND-PLAN</b> 150 WM WATERMAIN 50 GAS LAND DRAINAGE SEWER WASTEWATER SEWER 50 GMS SURVEY BAR POLE - HYDRO. MTS GUY ANCHOR LIGHT STANDARD TREE		<b>LEGEND-PROFILE</b> 150 WM WATERMAIN 50 GAS LAND DRAINAGE SEWER WASTEWATER SEWER 50 GMS SURVEY BAR POLE - HYDRO. MTS GUY ANCHOR LIGHT STANDARD TREE		<b>PROPOSED</b> 150 WM WATERMAIN 50 GAS LAND DRAINAGE SEWER WASTEWATER SEWER 50 GMS SURVEY BAR POLE - HYDRO. MTS GUY ANCHOR LIGHT STANDARD TREE		<b>EXISTING</b> 150 WM WATERMAIN 50 GAS LAND DRAINAGE SEWER WASTEWATER SEWER 50 GMS SURVEY BAR POLE - HYDRO. MTS GUY ANCHOR LIGHT STANDARD TREE		<b>LEGEND-PLAN</b> 150 WM WATERMAIN 50 GAS LAND DRAINAGE SEWER WASTEWATER SEWER 50 GMS SURVEY BAR POLE - HYDRO. MTS GUY ANCHOR LIGHT STANDARD TREE		<b>LEGEND-PROFILE</b> 150 WM WATERMAIN 50 GAS LAND DRAINAGE SEWER WASTEWATER SEWER 50 GMS SURVEY BAR POLE - HYDRO. MTS GUY ANCHOR LIGHT STANDARD TREE		<b>PROPOSED</b> 150 WM WATERMAIN 50 GAS LAND DRAINAGE SEWER WASTEWATER SEWER 50 GMS SURVEY BAR POLE - HYDRO. MTS GUY ANCHOR LIGHT STANDARD TREE		<b>EXISTING</b> 150 WM WATERMAIN 50 GAS LAND DRAINAGE SEWER WASTEWATER SEWER 50 GMS SURVEY BAR POLE - HYDRO. MTS GUY ANCHOR LIGHT STANDARD TREE	
--	--	---	--	--	--	---	--	--	--	--	--	--	--	---	--	--	--	--	--	--	--

LOCATION APPROVED  
 UNDERGROUND STRUCTURES  
 DATE  
 SLIP: U/S STRUCTURES COMMITTEE

THE CITY OF WINNIPEG  
 WATER AND WASTE DEPARTMENT

**2004 COMBINED SEWER RENEWALS  
 AND ASSOCIATED WORKS**

11 E OF R AIKINS STREET TO  
 1ST MH E OF AIKINS STREET

05514

CITY OF WINNIPEG  
 WATER AND WASTE  
 ENGINEERING DIVISION

ENGINEER'S SEAL  
 K. R. ZUREK  
 REGISTERED PROFESSIONAL ENGINEER

NO. REVISIONS  
 DATE BY

DESIGNED BY SC  
 CHECKED BY TW  
 DRAWN BY CJH  
 RELEASE FOR CONSTRUCTION DATE: 2004.08.11

DATE: 2004.08.11  
 HORIZ. SCALE: 1:250  
 VERTICAL SCALE: 1:50

**WARNING**

IF POWER EQUIPMENT OR EXPOSURES ARE TO BE USED FOR EXCAVATION ON THIS PROJECT THE CONTRACTOR MUST:  
 1) NOTIFY THE GAS COMPANY OF THE PROPOSED LOCATION OF EXCAVATION.  
 2) TAKE PRECAUTION TO AVOID DAMAGE TO GAS COMPANY INSTALLATIONS.

SEE PROVINCIAL REGULATION 210/72 FOR DETAILS

**METRIC**

WHOLE NUMBERS INDICATE MILLIMETERS  
 DECIMALIZED NUMBERS INDICATE METERS

**SEWER JUNCTION INFORMATION**

ADDRESS	SIZE	TYPE
233 INKSTER BLVD	Ø 235	BRANCH SRV. W/ #235
234 INKSTER BLVD	Ø 235	BRANCH SRV. W/ #235
235 INKSTER BLVD	Ø 235	BRANCH SRV. W/ #235
236 INKSTER BLVD	Ø 235	BRANCH SRV. W/ #235
237 INKSTER BLVD	Ø 235	BRANCH SRV. W/ #235
238 INKSTER BLVD	Ø 235	BRANCH SRV. W/ #235
239 INKSTER BLVD	Ø 235	BRANCH SRV. W/ #235
240 INKSTER BLVD	Ø 235	BRANCH SRV. W/ #235
241 INKSTER BLVD	Ø 235	BRANCH SRV. W/ #235
242 INKSTER BLVD	Ø 235	BRANCH SRV. W/ #235
243 INKSTER BLVD	Ø 235	BRANCH SRV. W/ #235
244 INKSTER BLVD	Ø 235	BRANCH SRV. W/ #235
245 INKSTER BLVD	Ø 235	BRANCH SRV. W/ #235
246 INKSTER BLVD	Ø 235	BRANCH SRV. W/ #235
247 INKSTER BLVD	Ø 235	BRANCH SRV. W/ #235
248 INKSTER BLVD	Ø 235	BRANCH SRV. W/ #235
249 INKSTER BLVD	Ø 235	BRANCH SRV. W/ #235
250 INKSTER BLVD	Ø 235	BRANCH SRV. W/ #235
251 INKSTER BLVD	Ø 235	BRANCH SRV. W/ #235
252 INKSTER BLVD	Ø 235	BRANCH SRV. W/ #235
253 INKSTER BLVD	Ø 235	BRANCH SRV. W/ #235
254 INKSTER BLVD	Ø 235	BRANCH SRV. W/ #235
255 INKSTER BLVD	Ø 235	BRANCH SRV. W/ #235
256 INKSTER BLVD	Ø 235	BRANCH SRV. W/ #235
257 INKSTER BLVD	Ø 235	BRANCH SRV. W/ #235
258 INKSTER BLVD	Ø 235	BRANCH SRV. W/ #235
259 INKSTER BLVD	Ø 235	BRANCH SRV. W/ #235
260 INKSTER BLVD	Ø 235	BRANCH SRV. W/ #235
261 INKSTER BLVD	Ø 235	BRANCH SRV. W/ #235
262 INKSTER BLVD	Ø 235	BRANCH SRV. W/ #235
263 INKSTER BLVD	Ø 235	BRANCH SRV. W/ #235
264 INKSTER BLVD	Ø 235	BRANCH SRV. W/ #235
265 INKSTER BLVD	Ø 235	BRANCH SRV. W/ #235
266 INKSTER BLVD	Ø 235	BRANCH SRV. W/ #235
267 INKSTER BLVD	Ø 235	BRANCH SRV. W/ #235
268 INKSTER BLVD	Ø 235	BRANCH SRV. W/ #235
269 INKSTER BLVD	Ø 235	BRANCH SRV. W/ #235
270 INKSTER BLVD	Ø 235	BRANCH SRV. W/ #235
271 INKSTER BLVD	Ø 235	BRANCH SRV. W/ #235
272 INKSTER BLVD	Ø 235	BRANCH SRV. W/ #235
273 INKSTER BLVD	Ø 235	BRANCH SRV. W/ #235
274 INKSTER BLVD	Ø 235	BRANCH SRV. W/ #235
275 INKSTER BLVD	Ø 235	BRANCH SRV. W/ #235

**\* INFORMATION FROM SEWER VIDEO INSPECTION**

STATION	DEPTH (m)	DIRECTION
18.00	1.50	E
18.00	1.50	NORTH
24.80	1.50	SOUTH
32.40	1.50	NORTH
35.60	1.50	SOUTH
36.20	1.50	NORTH
47.80	1.50	SOUTH
48.40	1.50	NORTH
63.80	1.50	NORTH
63.80	1.50	SOUTH
70.60	1.50	NORTH
71.00	1.50	NORTH
76.40	1.50	NORTH
86.40	1.50	NORTH
93.70	1.50	E

**CONSTRUCTION NOTES:**

- SEWER TO BE RENEWED OFF-LINE BY TRENCHLESS METHODS.
- CONFIRM THE LOCATION OF ALL SEWER SERVICES.
- RENEW SEWER SERVICES TO R. SIDEWALKS, & WITHIN 1.0 m OF PAVEMENT TO BE CLASS 3.
- BACKFILL UNDER PAVEMENT, IN CLASS 5.
- BACKFILL IN BOULEVARD TO BE PAVEMENT TO BE CLASS 3.
- SEWER SERVICE RISERS TO BE INSTALLED WHEN COMBINED SEWER EXCEEDS 4.25 m IN DEPTH.
- INSTALL TEE INCLUDING RISERS & PLUG FOR FUTURE SERVICE CONNECTION OF EXISTING WYED SEWER SERVICES AS SHOWN ON DRAWINGS OR AS DIRECTED BY THE CONTRACT ADMINISTRATOR.
- CATCHBASIN LEADS TO BE INSTALLED AT MINIMUM 1.0% SLOPE OR AS DIRECTED BY THE CONTRACT ADMINISTRATOR.

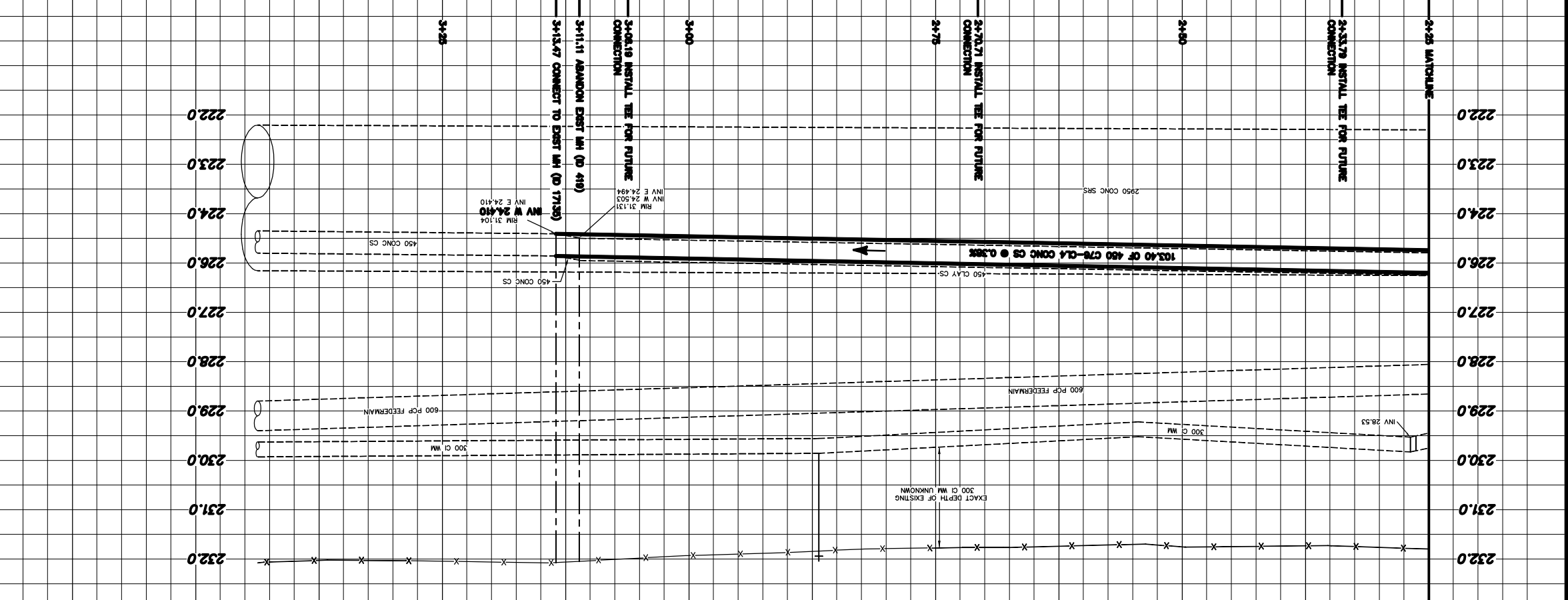
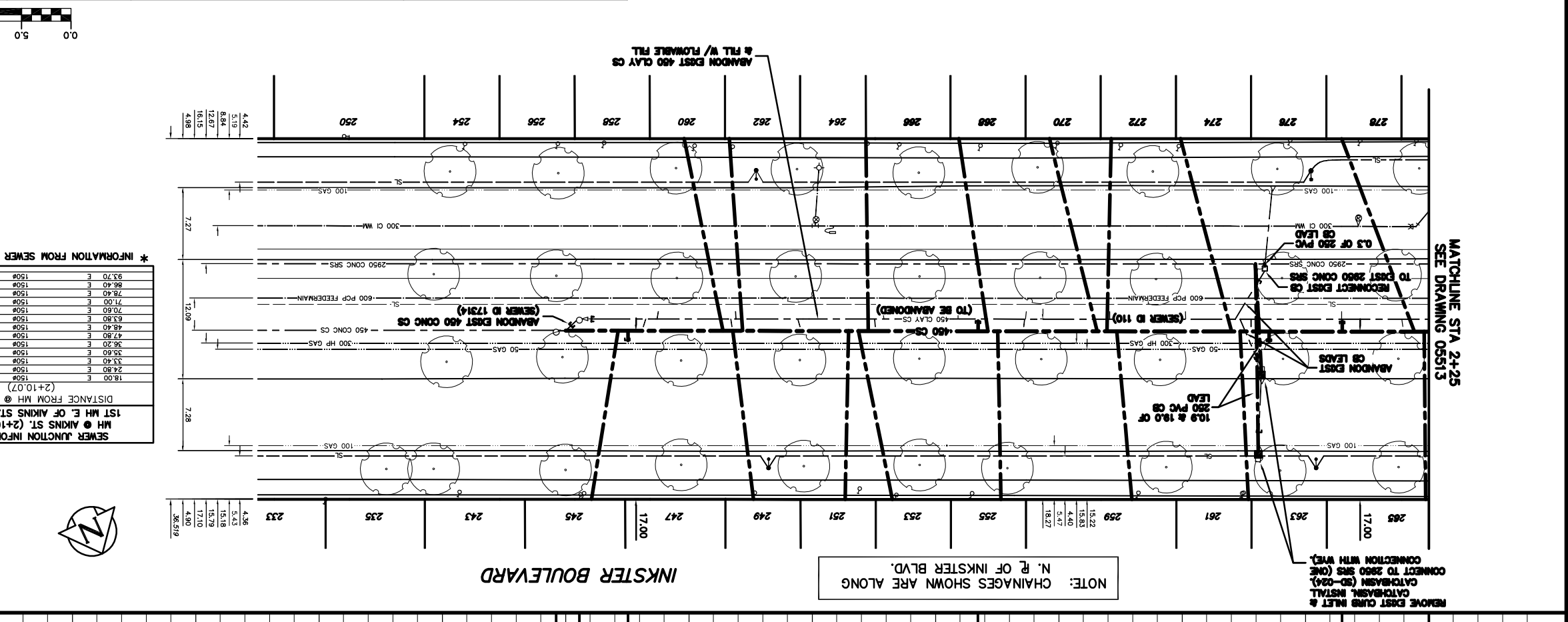
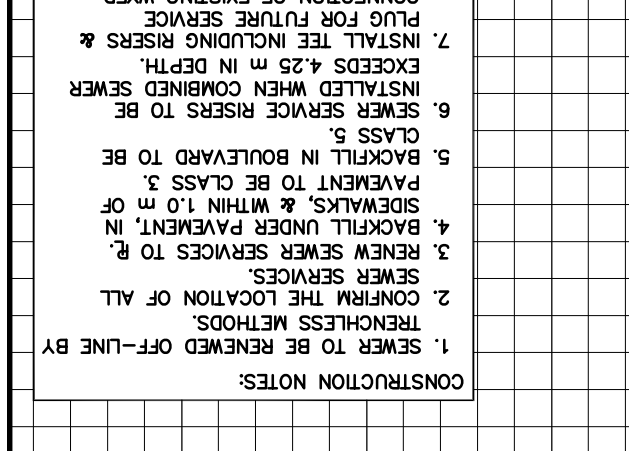

MATCHLINE STA 2+25  
 SEE DRAWING 05513