

Aug 24, 2004 - 3:32:27
 P:\41333 - 41333\Drawings\WMP\Rein\Rein\41333 04 S4 Reinforcing.dwg - tab:Layout1

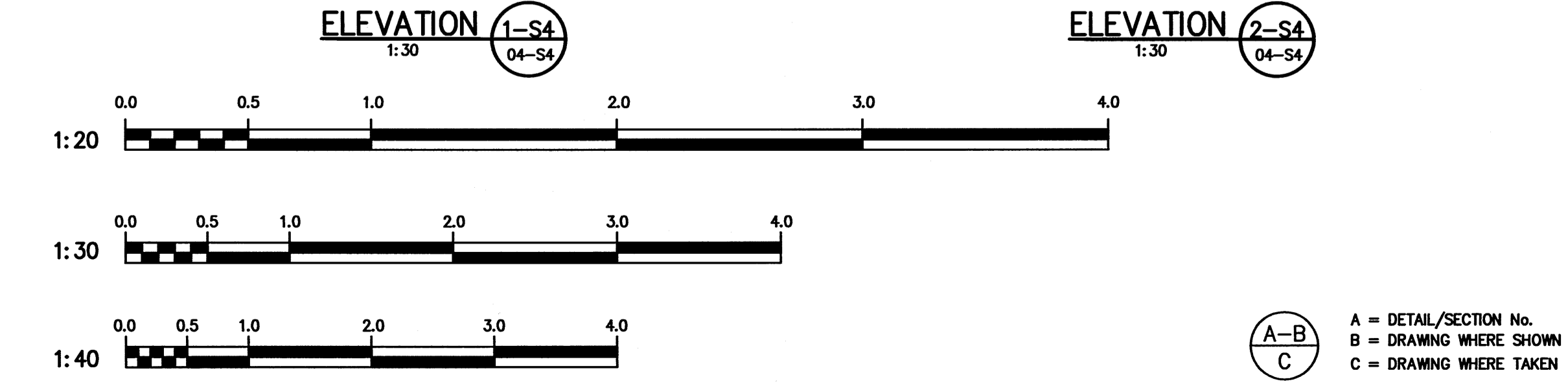
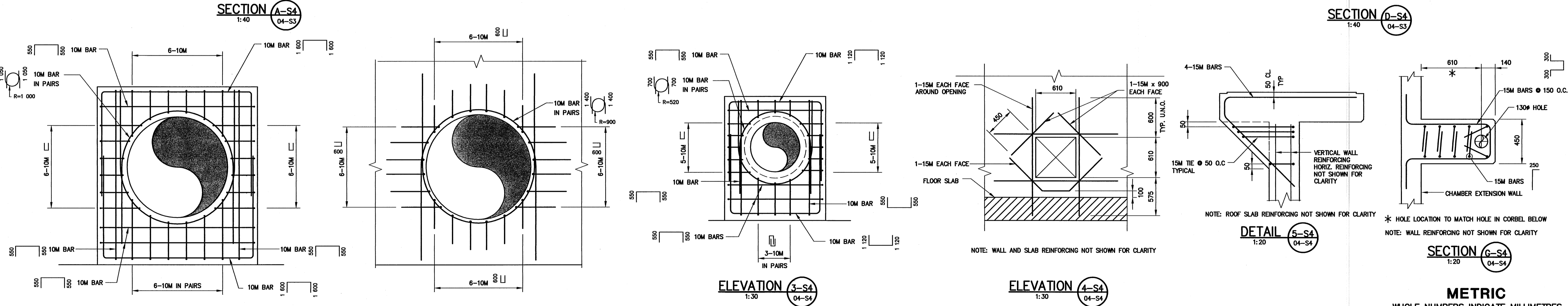
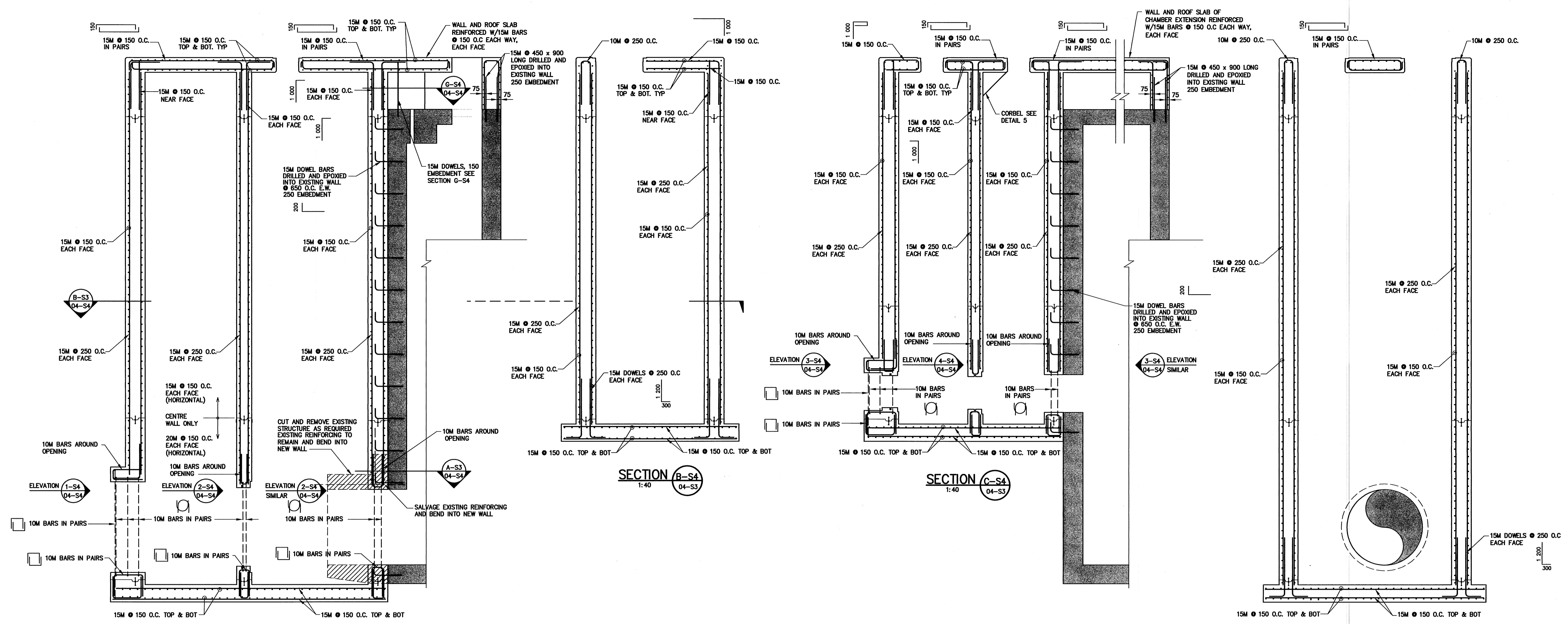

APEGM
 Certificate of Authorization
 ND LEA Engineers & Planners Inc.
 No. 2728 Expiry: April 30, 2005

NOTE:
 These design documents are prepared solely for the use by the party with whom the design professional has entered into a contract and there are no representations of any kind made by the design professional to any party with whom the design professional has not entered into a contract.

NDLEA Engineers & Planners Inc. Suite 111-93 Lombard Avenue Winnipeg, Manitoba R3B 3B1 Phone (204) 943-3178 Facsimile (204) 943-4948		ENGINEER'S SEAL
DESIGNED BY: EH DRAWN BY: RCS HOR. SCALE: AS SHOWN VERTICAL: VERTICAL	CHECKED BY: MH APPROVED BY: [Signature] RELEASED FOR CONSTRUCTION: [Signature] DATE: 04/08/05	
NO. REVISIONS: 1 DATE: 04/08/05 BY: [Signature]	DATE: 04/08/05	BID OPPORTUNITY: 416-2004 PLOT DATE: 04/08/23

THE CITY OF WINNIPEG
 WATER AND WASTE DEPARTMENT

2004 OUTFALL GATE CHAMBER UPGRADES
RICE ROAD
 LDS OUTFALL GATE CHAMBER MODIFICATION
 REINFORCING LAYOUT 2/2

CONSULTANT DRAWING NUMBER: 41333 04 S4
 SHEET: 8 OF 12
 CITY DRAWING NUMBER: LD-3041