

NOTE: CHAINAGES SHOWN ARE ALONG N.  $\phi$  OF COMANCHE RD.

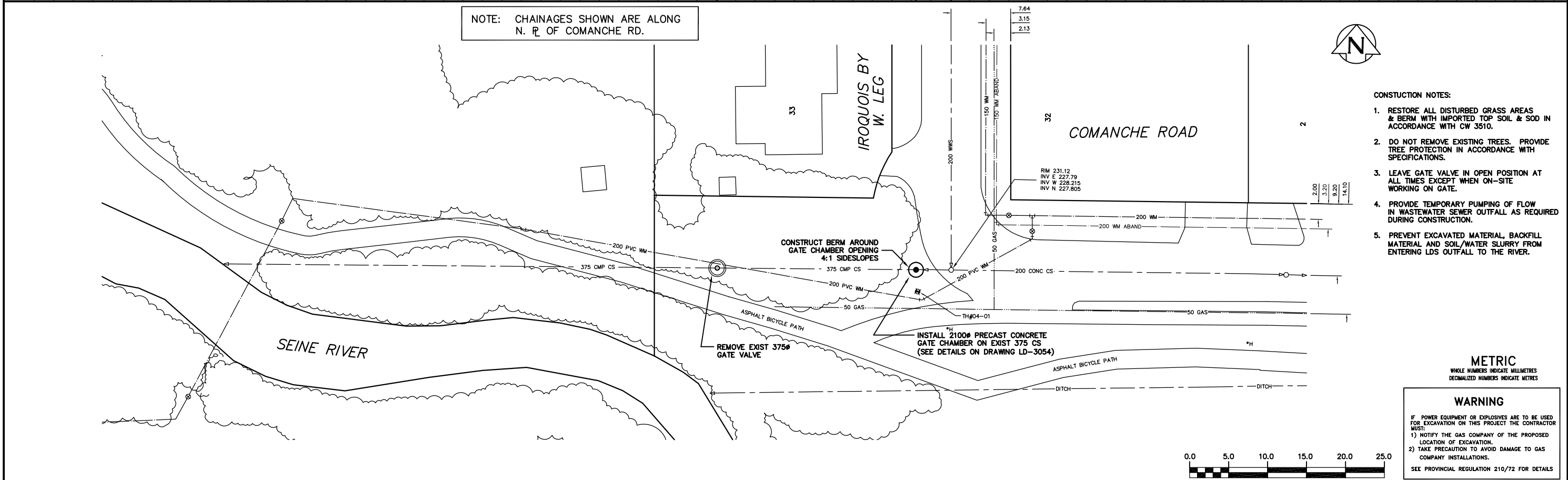

- CONSTRUCTION NOTES:**
- RESTORE ALL DISTURBED GRASS AREAS & BERM WITH IMPORTED TOP SOIL & SOD IN ACCORDANCE WITH CW 3510.
  - DO NOT REMOVE EXISTING TREES. PROVIDE TREE PROTECTION IN ACCORDANCE WITH SPECIFICATIONS.
  - LEAVE GATE VALVE IN OPEN POSITION AT ALL TIMES EXCEPT WHEN ON-SITE WORKING ON GATE.
  - PROVIDE TEMPORARY PUMPING OF FLOW IN WASTEWATER SEWER OUTFALL AS REQUIRED DURING CONSTRUCTION.
  - PREVENT EXCAVATED MATERIAL, BACKFILL MATERIAL AND SOIL/WATER SLURRY FROM ENTERING LDS OUTFALL TO THE RIVER.

**METRIC**  
WHOLE NUMBERS INDICATE MILLIMETRES  
DECIMALIZED NUMBERS INDICATE METRES

**WARNING**  
IF POWER EQUIPMENT OR EXPLOSIVES ARE TO BE USED FOR EXCAVATION ON THIS PROJECT THE CONTRACTOR MUST:  
1) NOTIFY THE GAS COMPANY OF THE PROPOSED LOCATION OF EXCAVATION.  
2) TAKE PRECAUTION TO AVOID DAMAGE TO GAS COMPANY INSTALLATIONS.  
SEE PROVINCIAL REGULATION 210/72 FOR DETAILS

200 WM	WATERMAIN	200 WM	SL, HYDRO	150 WM	WATERMAIN	150 WM	LOCATION APPROVED	B.M. ELEV.	FIELD BOOK #	<b>CITY OF WINNIPEG</b> <b>WATER AND WASTE</b> <b>ENGINEERING DIVISION</b>	ENGINEER'S SEAL	<b>THE CITY OF WINNIPEG</b> <b>WATER AND WASTE DEPARTMENT</b> 2004 OUTFALL GATE CHAMBER UPGRADES <b>COMANCHE ROAD</b> <b>CS OUTFALL GATE CHAMBER</b> <b>SITE PLAN</b>	SHEET 8 OF 14 CITY DRAWING NUMBER <b>LD-3053</b>
525 LDS	LAND DRAINAGE SEWER	525 LDS	50 GAS	300 LDS	LAND DRAINAGE SEWER	300 LDS	SUPV. U/G STRUCTURES COMMITTEE	POSTED TO LBS	DESIGNED BY: DGS		CHECKED BY: TW		
375 WWS	WASTEWATER SEWER	375 WWS	SURVEY BAR	250 WWS	WASTEWATER SEWER	250 WWS	NOTE:	NO. REVISIONS	DATE	BY	APPROVED BY: KZ		
MANHOLE	MANHOLE	MANHOLE	FENCE	GROUND ABOVE PIPE	GROUND ABOVE PIPE	GROUND ABOVE PIPE	LOCATION OF UNDERGROUND STRUCTURES AS SHOWN ARE BASED ON THE BEST INFORMATION AVAILABLE BUT NO GUARANTEE IS GIVEN THAT ALL EXISTING UTILITIES ARE SHOWN OR THAT THE GIVEN LOCATIONS ARE EXACT. CONFIRMATION OF EXISTENCE AND EXACT LOCATION OF ALL SERVICES MUST BE OBTAINED FROM THE INDIVIDUAL UTILITIES BEFORE PROCEEDING WITH CONSTRUCTION.				RELEASED FOR CONSTRUCTION		
CATCH BASIN	CATCH BASIN	CATCH BASIN	POLE - HYDRO, MTS										
CURB INLET	CURB INLET	CURB INLET	CURB STOP										
JUNCTIONS	JUNCTIONS	JUNCTIONS	GUY ANCHOR										
CULVERT	CULVERT	CULVERT	LIGHT STANDARD										
ANODE	ANODE	ANODE	TREE										
EXISTING	LEGEND-PLAN	PROPOSED	EXISTING	LEGEND-PLAN	PROPOSED	EXISTING	LEGEND-PROFILE	PROPOSED					