

13 PRESSURE TREATED PLYWOOD CAN/CSA 080.15M

ASPHALTIC SEALANT ALL AROUND

FASTEN TO PRECAST CONC. TEE'S WITH ONE 6.35mmx32 ZAMAC @ 300 O.C.

18ga. G-90 (GALVANIZED)

PRECAST CONC. TEE'S (EXISTING)

FASTEN STEEL DECK TO 18ga. G-90 WITH ONE 200-470 WAFER HD TEK SCREW @ 300 O.C.

SECTION 1-1

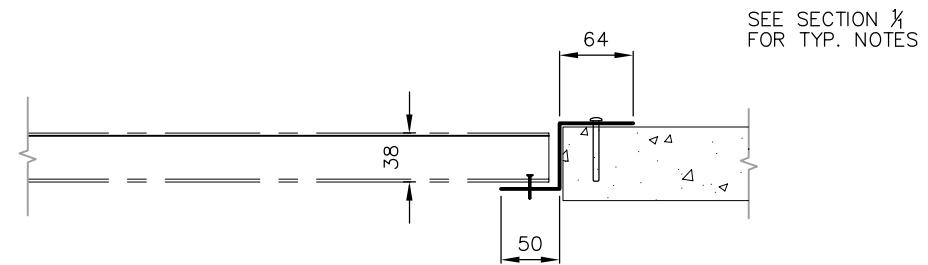

SECTION 2-1

METRIC
WHOLE NUMBERS INDICATE MILLIMETRES
DECIMALIZED NUMBERS INDICATE METRES

B.M. ELEV.	FIELD BOOK #:	CITY OF WINNIPEG WATER AND WASTE ENGINEERING DIVISION		ENGINEER'S SEAL	THE CITY OF WINNIPEG WATER AND WASTE DEPARTMENT
POSTED TO LBIS		DESIGNED BY	CHECKED BY JE		
		DRAWN BY BH	APPROVED BY JE		NORTH END WATER POLLUTION CONTROL CENTRE GRIT REMOVAL BUILDING RE-ROOFING SKYLIGHT DETAIL
		HOR. SCALE N.T.S.	RELEASED FOR CONSTRUCTION	TENDER No:	
		VERTICAL	DATE 2004 09 07	FILENAME :	SHEET 1 OF 1
NO. REVISIONS	DATE BY			PLOT DATE : 2004.09.07	CITY DRAWING NUMBER
					NEP-0056A