

NOTE:
1. MAINTAIN ACCESS TO PARKADE ENTRANCE/EXIST AT ALL TIMES

NOTE:
UNREGULATED WATER LEVEL REFERS TO WINTER OPERATION OF ST. ANDREWS LOCK AND DAM AND ASSUMES WINTER RIVER LEVELS AT 0 FT. JAMES AVENUE PUMP STATION DATUM. ACTUAL WINTER RIVER LEVELS VARY DEPENDING ON ACTUAL FLOWS

WARNING

IF POWER EQUIPMENT OR EXPLOSIVES ARE TO BE USED FOR EXCAVATION ON THIS PROJECT THE CONTRACTOR MUST:
1) NOTIFY THE GAS COMPANY OF THE PROPOSED LOCATION OF EXCAVATION.
2) TAKE PRECAUTION TO AVOID DAMAGE TO GAS COMPANY INSTALLATIONS.
SEE PROVINCIAL REGULATION 210/72 FOR DETAILS.

METRIC

WHOLE NUMBERS INDICATE MILLIMETRES
DECIMALIZED NUMBERS INDICATE METRES

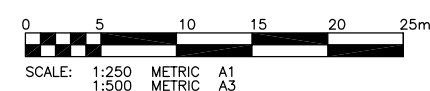
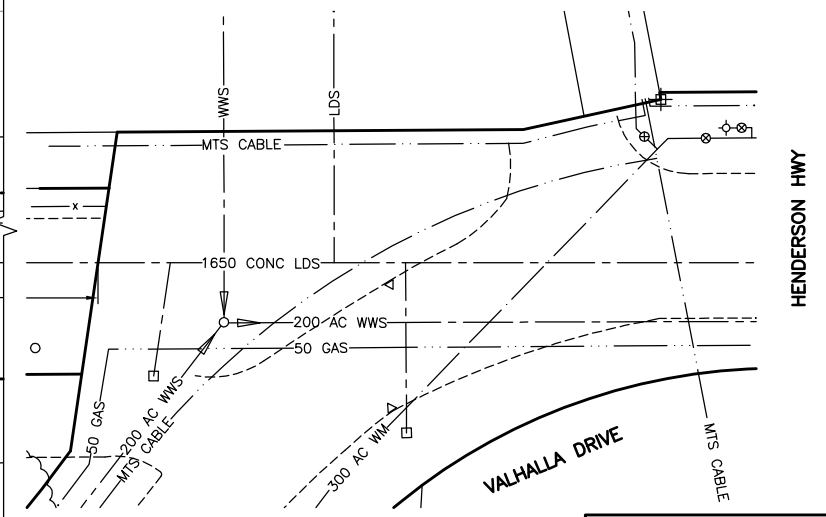
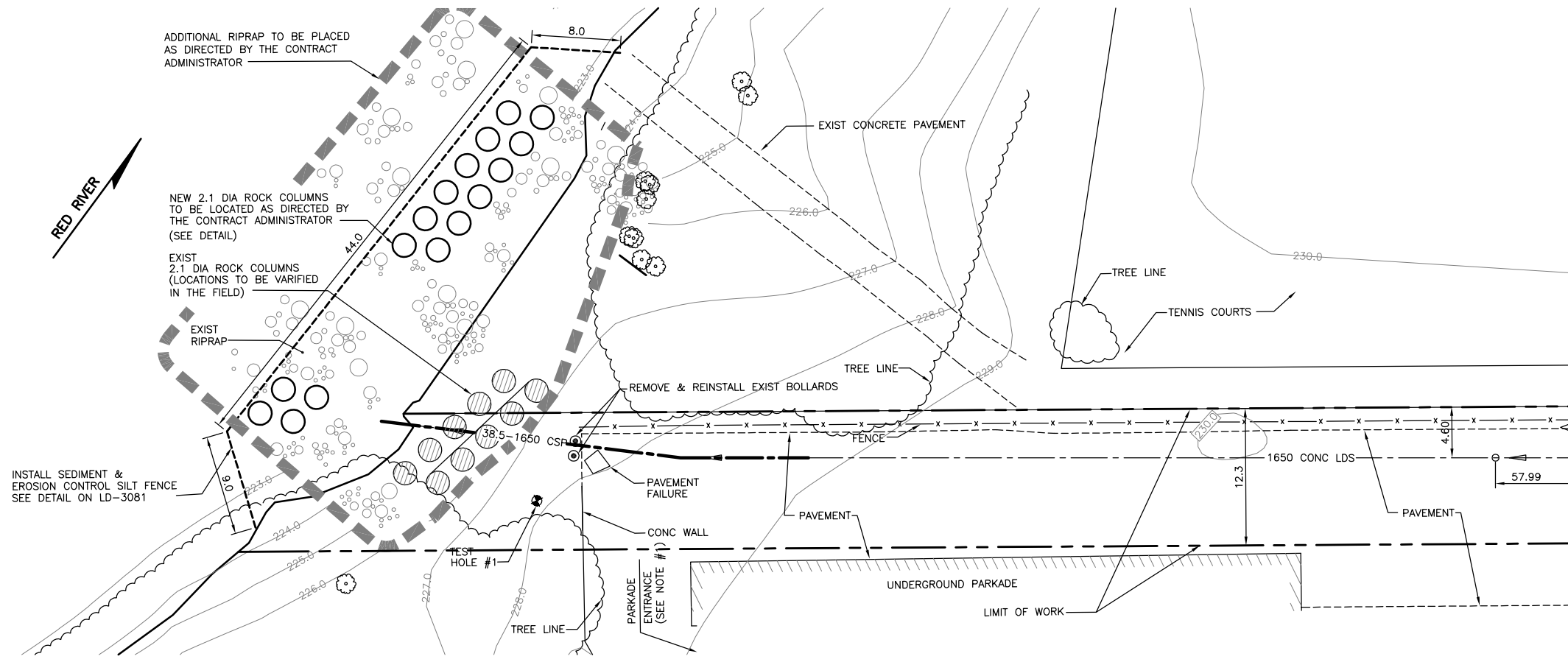

APEGN
Certificate of Authorization
KGS Group
No. 245 Expiry: April 30, 2005

EXISTING	LEGEND-PLAN	PROPOSED	EXISTING	LEGEND-PLAN	PROPOSED	EXISTING	LEGEND-PROFILE	PROPOSED
150 WM	WATERMAIN	150 WM	HYDRO	HYDRO	HYDRO			
300 LDS	LAND DRAINAGE SEWER	300 LDS	M.T.S.	M.T.S.	M.T.S.			
250 WWS	WASTE WATER SEWER	250 WWS	PROPERTY LINE	PROPERTY LINE	PROPERTY LINE			
MANHOLE	MANHOLE	MANHOLE	SURVEY BAR	SURVEY BAR	SURVEY BAR			
CATCH BASIN	CATCH BASIN	CATCH BASIN	LIGHT STANDARD	LIGHT STANDARD	LIGHT STANDARD			
CURB INLET	CURB INLET	CURB INLET	HYDRO POLE	HYDRO POLE	HYDRO POLE			
JUNCTIONS	JUNCTIONS	JUNCTIONS	GUY WIRE	GUY WIRE	GUY WIRE			
CULVERT	CULVERT	CULVERT	SIGN	SIGN	SIGN			
GAS	GAS	GAS	BUSH LINE	BUSH LINE	BUSH LINE			
			FENCE	FENCE	FENCE			
			ELEVATION	ELEVATION	ELEVATION			

LOCATION APPROVED UNDERGROUND STRUCTURES

SUPV. U/G STRUCTURES DATE COMMITTEE

NOTE:
LOCATION OF UNDERGROUND STRUCTURES AS SHOWN ARE BASED ON THE BEST INFORMATION AVAILABLE BUT NO GUARANTEE IS GIVEN THAT ALL EXISTING UTILITIES ARE SHOWN OR THAT THE GIVEN LOCATIONS ARE EXACT. CONFIRMATION OF EXISTENCE AND EXACT LOCATION OF ALL SERVICES MUST BE OBTAINED FROM THE INDIVIDUAL UTILITIES BEFORE PROCEEDING WITH CONSTRUCTION.

NO.	REVISIONS	DATE	BY
0	ISSUED FOR TENDER	25/11/04	RJH

KGS GROUP CONSULTING ENGINEERS & PROJECT MANAGERS
WINNIPEG (204) 896-1209
THUNDER BAY (807) 345-2233

DESIGNED BY: DGG
CHECKED BY: RJH
DRAWN BY: DMW
APPROVED BY: [Signature]

HOR. SCALE: 1:250
VERTICAL: 1:50

RELEASED FOR CONSTRUCTION: [Signature]
DATE: 24/06/04

ENGINEER'S SEAL
PROVINCE OF MANITOBA
R.J. HOUSTON
Member 4395
REGISTERED PROFESSIONAL ENGINEER

THE CITY OF WINNIPEG
WATER & WASTE DEPARTMENT

2004 OUTFALL REPAIRS
VALHALLA DRIVE OUTFALL (RR-103)
(DOUGLAS AVE. OUTFALL)

SHEET 06 OF 09
CAD FILE DRAWING NUMBER 04-0107-13
CITY DRAWING NUMBER LD-3078

COWLEND