

- NOTE:**
1. ALL MATERIALS & CONSTRUCTION SHALL BE IN ACCORDANCE WITH THE LATEST EDITION OF THE CITY OF WINNIPEG STANDARD CONSTRUCTION SPECIFICATION.
 2. CONTRACTOR IS RESPONSIBLE FOR CONFIRMING LOCATION OF ALL UTILITIES PRIOR TO THE COMMENCEMENT OF CONSTRUCTION.
 3. STORM SEWER PIPE TO BE PVC SDR-35, OR C-76-3 UNLESS OTHERWISE NOTED.
 4. ALL 600 mm AND 450 mm STORM SEWER TO BE CORED, UNLESS OTHERWISE NOTED.
 5. SAWCUT ALL ASPHALT AND CONCRETE AT LIMITS.
 6. TRANSVERSE JOINT SPACING TO BE 5.0m EXCEPT WHERE SHOWN OTHERWISE.
 7. CONTRACTOR TO PROTECT ALL SURVEY BARS FROM DAMAGE.

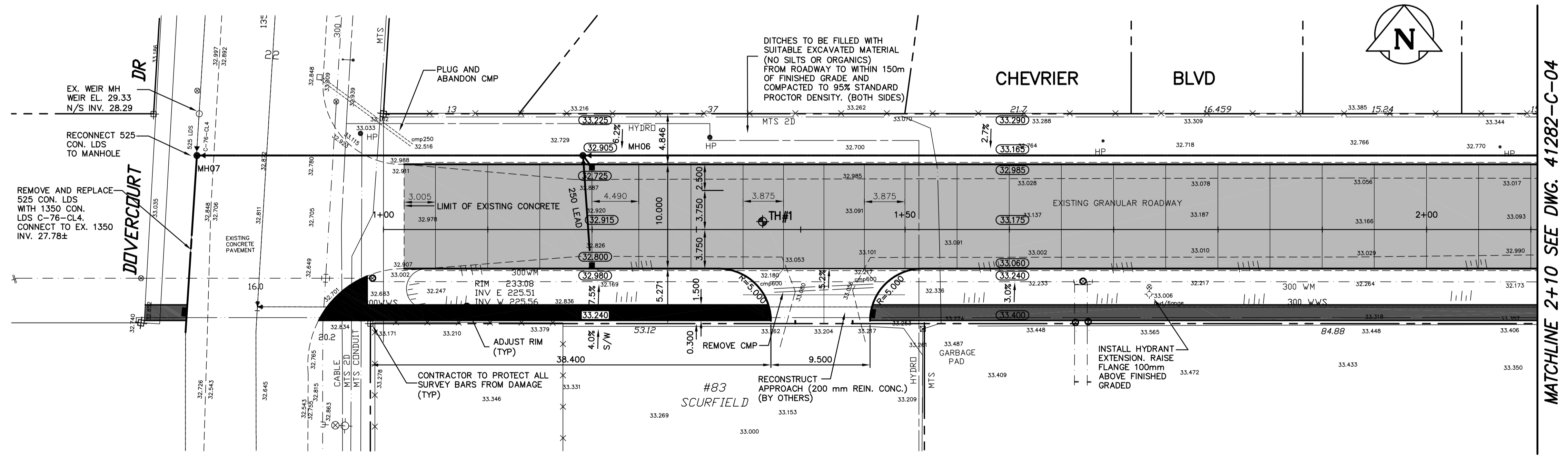
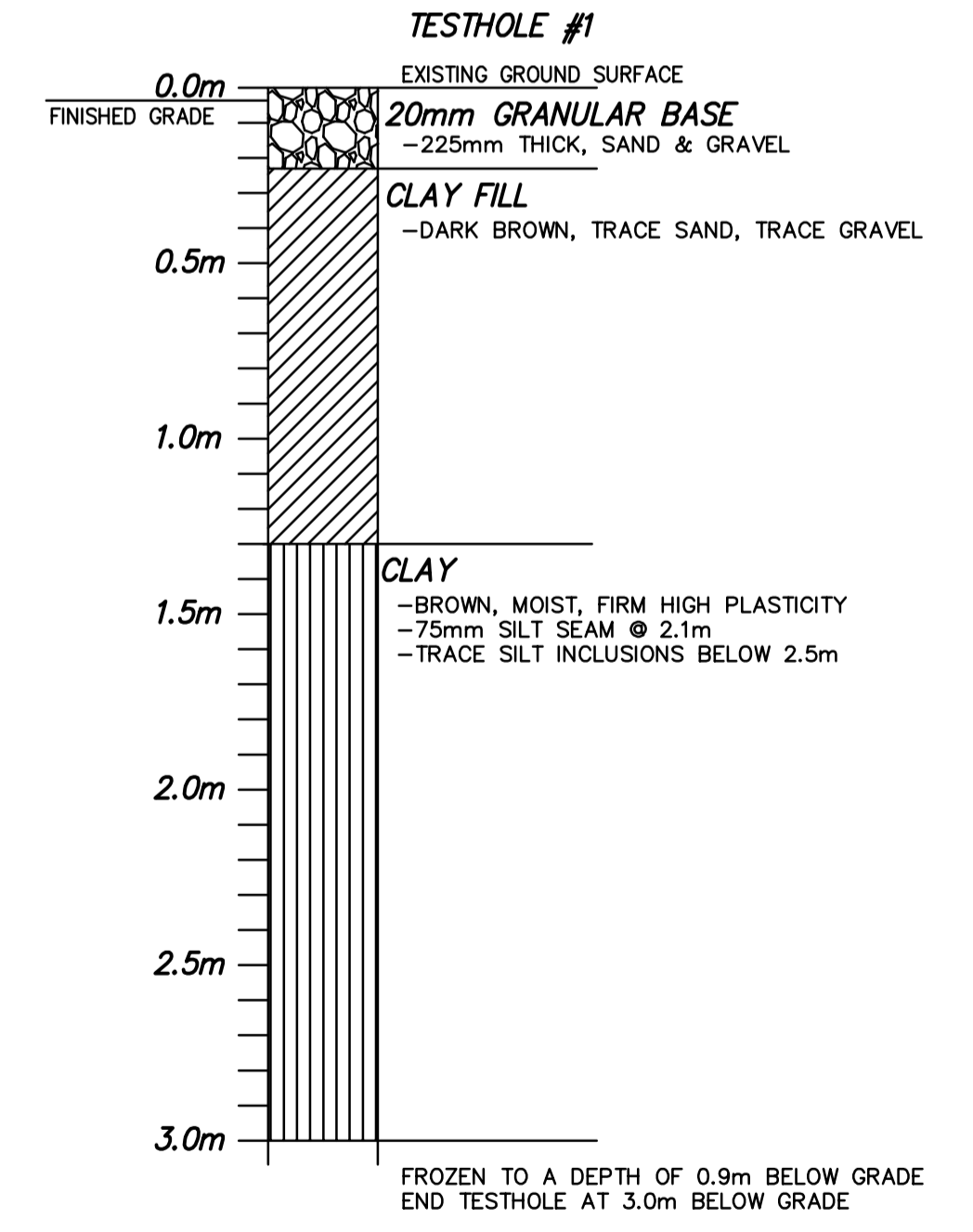
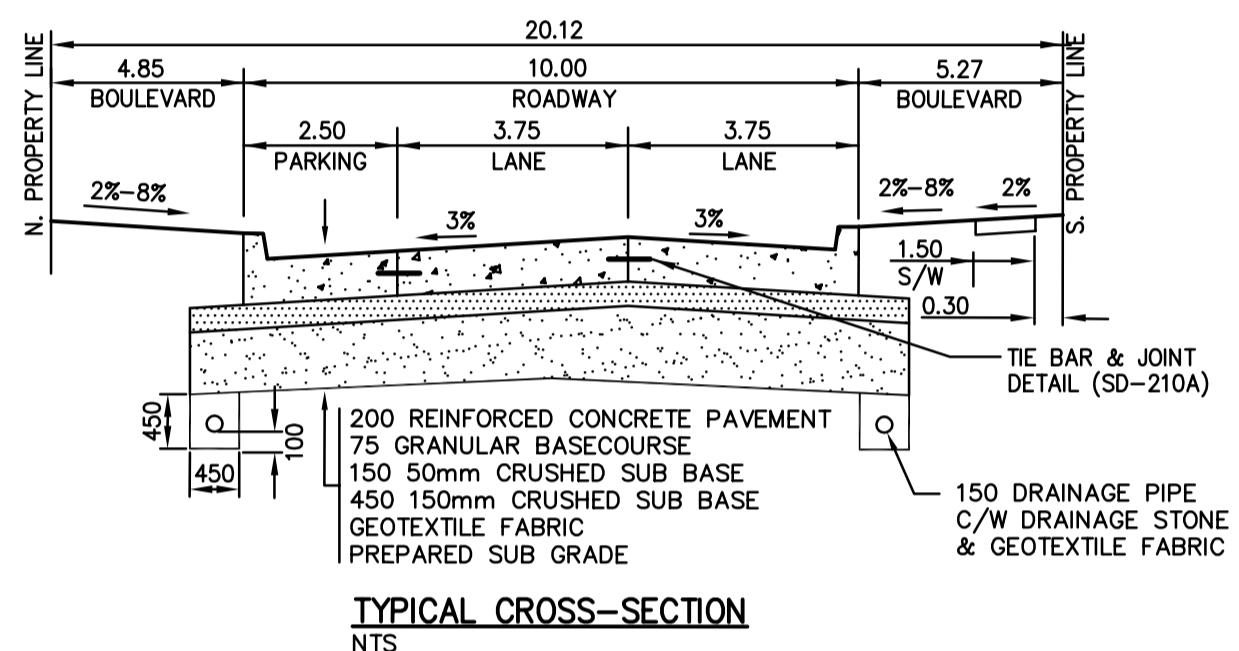

EXISTING	LEGEND-PLAN	PROPOSED	EXISTING	LEGEND-PLAN	PROPOSED	EXISTING	LEGEND-PROFILE	PROPOSED
—	WATERMAIN	—	—	M.T.S.	—	—	CENTRE LINE	—
—	HYDRANT	—	—	HYDRO POLE	—	—	NORTH PROPERTY	—
—	VALVE	—	—	PROPERTY LINE	—	—	SOUTH PROPERTY	—
—	LAND DRAINAGE SEWER	—	—	BARRIER CURB	—	—	NORTH GUTTER	—
—	WASTE WATER SEWER	—	—	LIGHT STANDARD	—	—	SOUTH GUTTER	—
—	MANHOLE	—	—	SIDEWALK RAMP	—	—		—
—	CATCH BASIN	—	—	ELEVATION	—	—		—
—	CURB INLET	—	—	CONCRETE SIDEWALK	—	—		—
—	UTILITIES ADJUSTED	—	—	ASPHALT PAVEMENT	—	—		—
—	SUBDRAIN	—	—	LIP CURB	—	—		—
—	GAS	—	—	200 REIN. CONC. PAV'T	—	—		—

LOCATIONS APPROVED UNDERGROUND STRUCTURES

SUPV	U/G STRUCTURES	DATE

LOCATION OF UNDERGROUND STRUCTURES AS SHOWN ARE BASED ON THE BEST INFORMATION AVAILABLE BUT NO GUARANTEE IS GIVEN THAT ALL EXISTING UTILITIES ARE SHOWN OR THAT THE GIVEN LOCATIONS ARE EXACT CONFIRMATION OF EXISTENCE AND EXACT LOCATION OF ALL SERVICES MUST BE OBTAINED FROM THE INDIVIDUAL UTILITIES BEFORE PROCEEDING

G.B.M. 66-011
ELEV. 232.966

NE Cor. McGillivray Blvd. & Lindenwood Dr.
Tabl. on top 0.05m sq. x 2.4m
from tube in valve box

NLEA Engineers & Planners Inc.
Suite 111-93 Lombard Avenue Winnipeg, Manitoba R3B 3B1
Phone (204) 943-3178 Facsimile (204) 943-4948

DESIGNED BY	MS	CHECKED BY	KVC
DRAWN BY	MS	APPROVED BY	RMB

HOR. SCALE 1:250
VERTICAL 1:25

ISSUED FOR APPROVAL MAR.04 KVC
DATE BY

RELEASSED FOR CONSTRUCTION
DATE

ENGINEER'S SEAL

PROVINCE OF MANITOBA
K.S. VAN CAMP
Member
10351
REGISTERED PROFESSIONAL ENGINEER

CONSULTANT ACAD DWG. NO.
41282-C-03

THE CITY OF WINNIPEG
PUBLIC WORKS DEPARTMENT
ENGINEERING SERVICES DIVISION

2004 LOCAL IMPROVEMENTS PROGRAM

PAVEMENT CONSTRUCTION
CHEVRIER BOULEVARD
DOVERCOURT to 2+10.000

CITY DRAWING NUMBER
SHEET 3 OF 9
Bid Opportunity No. 65-2004

MATCHLINE 2+10 SEE DWG. 41282-C-04