

WARNING
 IF POWER EQUIPMENT OR EXPLOSIVES ARE TO BE USED FOR EXCAVATION ON THIS PROJECT THE CONTRACTOR MUST:
 1. NOTIFY THE GAS COMPANY OF THE PROPOSED LOCATION OF EXCAVATION.
 2. TAKE PRECAUTION TO AVOID DAMAGE TO GAS COMPANY INSTALLATIONS - SEE PROVINCIAL REGULATION 210/72 FOR DETAILS

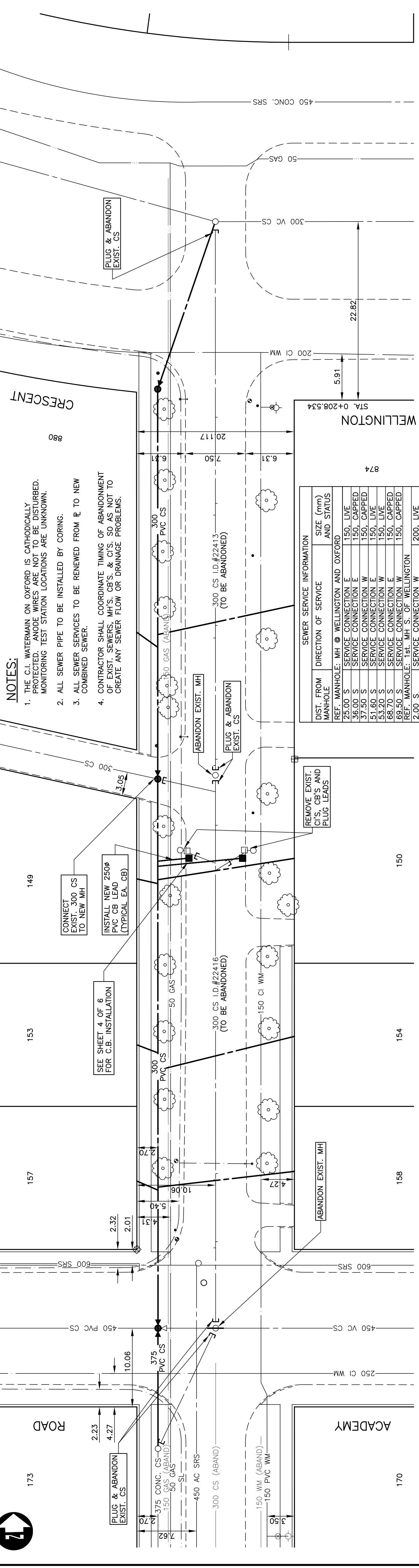

- NOTES:**
1. THE C.I. WATERMAIN ON OXFORD IS CATHODICALLY PROTECTED. ANODE WIRES ARE NOT TO BE DISTURBED. MONITORING TEST STATION LOCATIONS ARE UNKNOWN.
 2. ALL SEWER PIPE TO BE INSTALLED BY CORING.
 3. ALL SEWER SERVICES TO BE RENEWED FROM R. TO NEW COMBINED SEWER.
 4. CONTRACTOR SHALL COORDINATE TIMING OF ABANDONMENT OF EXIST. SEWERS, M.H.'S, C.B.'S, & C.I.'S, SO AS NOT TO CREATE ANY SEWER FLOW OR DRAINAGE PROBLEMS.

DIST. FROM MANHOLE	DIRECTION OF SERVICE	SIZE (mm) AND STATUS
25.00 S	SERVICE CONNECTION E	150. LIVE
36.00 S	SERVICE CONNECTION E	150. CAPPED
37.50 S	SERVICE CONNECTION W	150. CAPPED
51.60 S	SERVICE CONNECTION W	150. LIVE
53.20 S	SERVICE CONNECTION W	150. LIVE
68.70 S	SERVICE CONNECTION E	150. CAPPED
69.50 S	SERVICE CONNECTION W	150. CAPPED
2.00 S	SERVICE CONNECTION W	200. LIVE
6.40 S	SERVICE CONNECTION E	150. LIVE
11.6-43.8 S	SEWER COLLAPSED, NO INFO.	150. LIVE
50.90 S	SERVICE CONNECTION W	150. CAPPED
51.70 S	SERVICE CONNECTION E	150. CAPPED
59.80 S	SERVICE CONNECTION E	150. CAPPED
60.40 S	SERVICE CONNECTION W	150. CAPPED

NOTE: CHANGES ARE TAKEN ALONG THE E. R.

<p>THE CITY OF WINNIPEG PUBLIC WORKS DEPARTMENT</p>		<p>METRIC WHOLE NUMBERS INDICATE MILLIMETRES DECIMALIZED NUMBERS INDICATE METRES</p>	
<p>2004 RESIDENTIAL SEWER RENEWAL PROGRAM COMBINED SEWER RENEWAL</p>		<p>CITY DRAWING NUMBER 05378</p>	
<p>OXFORD STREET ACADEMY ROAD TO WELLINGTON CRESCENT STA. 0+074.55 TO STA. 0+231.31</p>		<p>SHEET 6 OF 6</p>	
<p>DILLON CONSULTING</p>		<p>ENGINEER'S SEAL PROVINCE OF MANITOBA P.M. KREITZ REGISTERED PROFESSIONAL ENGINEER</p>	
<p>DESIGNED BY: P.M. KREITZ DRAWN BY: A. PORCO CHECKED BY: P.M. KREITZ APPROVED BY:</p>		<p>CONSULTANT PROJECT NO. 03-2620-5000</p>	
<p>UNDERGROUND STRUCTURES SUPPLY, U/G STRUCTURES COMMITTEE</p>		<p>RELEASED FOR CONSTRUCTION DATE: 04/16/04</p>	
<p>NOTE: DRAWINGS BASED ON THE BEST AVAILABLE INFORMATION ON EXISTING UTILITIES. CONTRACTOR TO VERIFY LOCATION OF EXISTING UTILITIES BEFORE PROCEEDING WITH CONSTRUCTION.</p>		<p>ISSUED FOR TENDER (M/J/M) PMK DATE: 04/16/04</p>	
<p>HYDRO M.T.S. CONCRETE ASPHALT PLANNING SIDEWALK PAVING STONES CATCH BASIN CURB INLET JUNCTIONS CULVERT GAS</p>		<p>WATERMAIN HYDRANT VALVE LAND DRAINAGE SEWER WASTE WATER SEWER NORTH/WEST GUTTER SOUTH/EAST GUTTER</p>	
<p>PROPOSED EXISTING</p>		<p>PROPOSED EXISTING</p>	
<p>LEGEND-PLAN</p>		<p>LEGEND-PROFILE</p>	