

NOTE: CHAINAGES SHOWN ARE ALONG W. R. OF CORNELL DR.

WATER SERVICE INFORMATION

ADDRESS	SIZE(mm) & TYPE (STREET)	SIZE(mm) & TYPE (PROP)	SHORT & LONG MEASUREMENT	CORP. LOCATION	REMARKS
65 CORNELL DR RESIDENTIAL	19 COPPER	19	4.88 EWL HSE 22.86 E HYD	WL CORNELL	0.91 L OF S/C SERV. OFF FORDHAM
75 CORNELL DR RESIDENTIAL	19 COPPER	19	4.88 EWL HSE	-	SERV. OFF CORNELL
80 CORNELL DR RESIDENTIAL	19 COPPER	19	59.14 W HYD	NL FORDHAM	0.33 E OF S/C SERV. OFF BALDRY
2 BALDRY BAY RESIDENTIAL	19 COPPER	19	3.96 EWL HSE	-	-
3 BALDRY BAY RESIDENTIAL	19 COPPER	19	66.70 E HYD	#3 BALDRY	-
3 FORDHAM BAY RESIDENTIAL	19 COPPER	19	6.71 WEL HSE	-	SERV. OFF BALDRY
3 FORDHAM BAY RESIDENTIAL	19 COPPER	19	13.72 W HYD	WL CORNELL	-
3 FORDHAM BAY RESIDENTIAL	19 COPPER	19	8.38 E L/L	-	SERV. OFF BALDRY
3 FORDHAM BAY RESIDENTIAL	19 COPPER	19	18.90 FROM WB AT #7	-	-
3 FORDHAM BAY RESIDENTIAL	19 COPPER	19	9.75 FROM W R	-	1.52 L OF S/C SERV. OFF BALDRY
3 FORDHAM BAY RESIDENTIAL	19 COPPER	19	28.96 FROM WB AT #7	-	-

• SERVICES TO BE RENEWED TO R. ALL OTHERS TO BE RECONNECTED

CONSTRUCTION NOTES

1. EXPOSE EXISTING WATERMAIN & CONFIRM INVERTS PRIOR TO CONSTRUCTION.
2. LOCATION OF ALL SERVICES TO BE CONFIRMED IN THE FIELD.
3. INSTALL WATERMAIN BY TRENCHLESS METHODS.
4. TRENCHES AND EXCAVATIONS WITHIN 1 METRE OF A PAVED AREA INCLUDING SIDEWALKS SHALL BE CLASS 3 BACKFILL.
5. ALL MATERIALS SHALL CONFORM TO THE CITY OF WINNIPEG STANDARD CONSTRUCTION SPECIFICATIONS.
6. MINIMUM COVER TO TOP OF WATERMAIN SHALL BE 2.4 m.
7. REPLACE ALL EXISTING LEAD SERVICES FROM PROPOSED WATERMAIN TO R.
8. NOTIFY ALL AFFECTED RESIDENTS AND BUSINESSES 24 HOURS IN ADVANCE OF ANY WATER SHUTDOWNS OR DISRUPTION OF SERVICE.

METRIC

WHOLE NUMBERS INDICATE MILLIMETRES
DECIMALIZED NUMBERS INDICATE METRES

NOTE: ALL VALVES TO BE INSTALLED CLOCKWISE TO CLOSE

WARNING

IF POWER EQUIPMENT OR EXPLOSIVES ARE TO BE USED FOR EXCAVATION ON THIS PROJECT THE CONTRACTOR MUST:
1) NOTIFY THE GAS COMPANY OF THE PROPOSED LOCATION OF EXCAVATION.
2) TAKE PRECAUTION TO AVOID DAMAGE TO GAS COMPANY INSTALLATIONS.
SEE PROVINCIAL REGULATION 210/72 FOR DETAILS

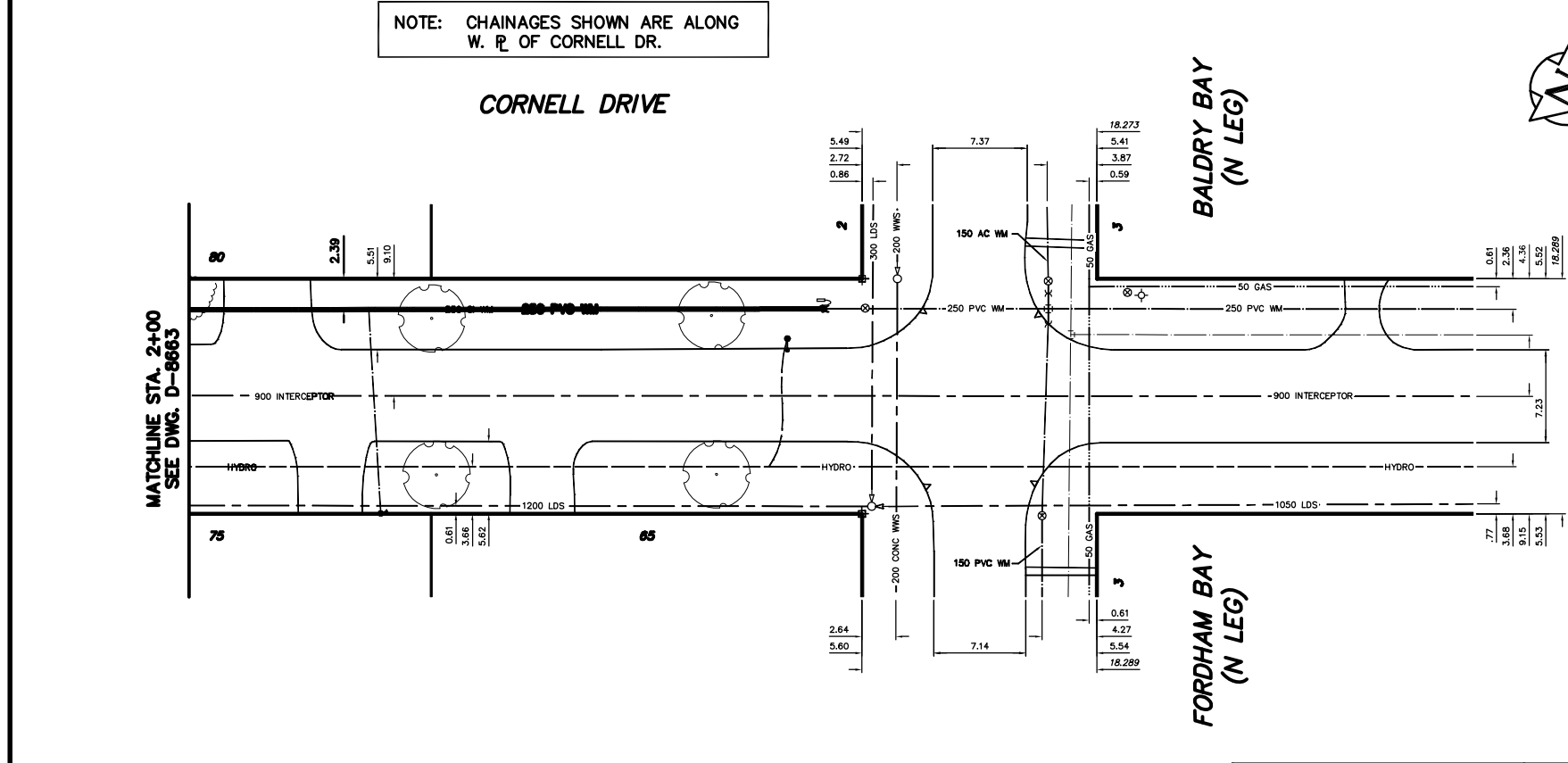
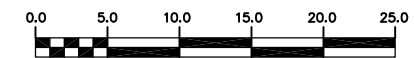

200 WM	WATERMAIN	200 WM	SL, HYDRO	150 WM	WATERMAIN	150 WM
⊕	HYDRANT	⊕	MTS	⊕	HYDRANT	⊕
⊕	VALVE	⊕	TRAFFIC SIGNALS	⊕	VALVE	⊕
525 LDS	LAND DRAINAGE SEWER	525 LDS	GAS	50 GAS	300 LDS	LAND DRAINAGE SEWER
375 WWS	WASTEWATER SEWER	375 WWS	SURVEY BAR	250 WWS	250 WWS	WASTEWATER SEWER
○	MANHOLE	○	FENCE	⊕	⊕	PROFILE
□	CATCH BASIN	□	POLE - HYDRO, MTS	⊕	⊕	GROUND ABOVE PIPE
▽	CURB INLET	▽	CURB STOP	⊕	⊕	
▽	REDUCER	▽	GUY ANCHOR	⊕	⊕	
X	COUPLING	X	LIGHT STANDARD	⊕	⊕	
⊕	ANODE	⊕	TREE	⊕	⊕	
EXISTING	LEGEND-PLAN	PROPOSED	EXISTING	LEGEND-PLAN	PROPOSED	EXISTING

LOCATION APPROVED UNDERGROUND STRUCTURES	DATE
SUPV. U/G STRUCTURES COMMITTEE	

NOTE:
LOCATION OF UNDERGROUND STRUCTURES AS SHOWN ARE BASED ON THE BEST INFORMATION AVAILABLE BUT NO GUARANTEE IS GIVEN THAT ALL EXISTING UTILITIES ARE SHOWN OR THAT THE GIVEN LOCATIONS ARE EXACT. CONFIRMATION OF EXISTENCE AND EXACT LOCATION OF ALL SERVICES MUST BE OBTAINED FROM THE INDIVIDUAL UTILITIES BEFORE PROCEEDING WITH CONSTRUCTION.

CITY OF WINNIPEG WATER AND WASTE ENGINEERING DIVISION

DESIGNED BY: SC
DRAWN BY: CJH
HOR. SCALE: 1:250
VERTICAL SCALE: 1:50
DATE: 2005 03 18

CHECKED BY: KZ
APPROVED BY: KZ
RELEASED FOR CONSTRUCTION: _____
DATE: _____

ENGINEER'S SEAL

ORIGINAL SIGNED BY K.R. ZUREK
03/04/23

BID OPPORTUNITY: 135-2005
FILENAME: D-8663_D-8664.dwg
PLOT DATE: 2005 03 21

THE CITY OF WINNIPEG WATER AND WASTE DEPARTMENT

2005 WATERMAIN RENEWALS

CORNELL DRIVE
23 m N BALDRY BY (S LEG) TO BALDRY BAY (N LEG)

SHEET 3 OF 18
CITY DRAWING NUMBER
D-8664