

DESCRIPTION	RIM	INVERT		
		NORTH	SOUTH	WEST
CP 5	32.520			31.570
CP 6	32.520		31.570	

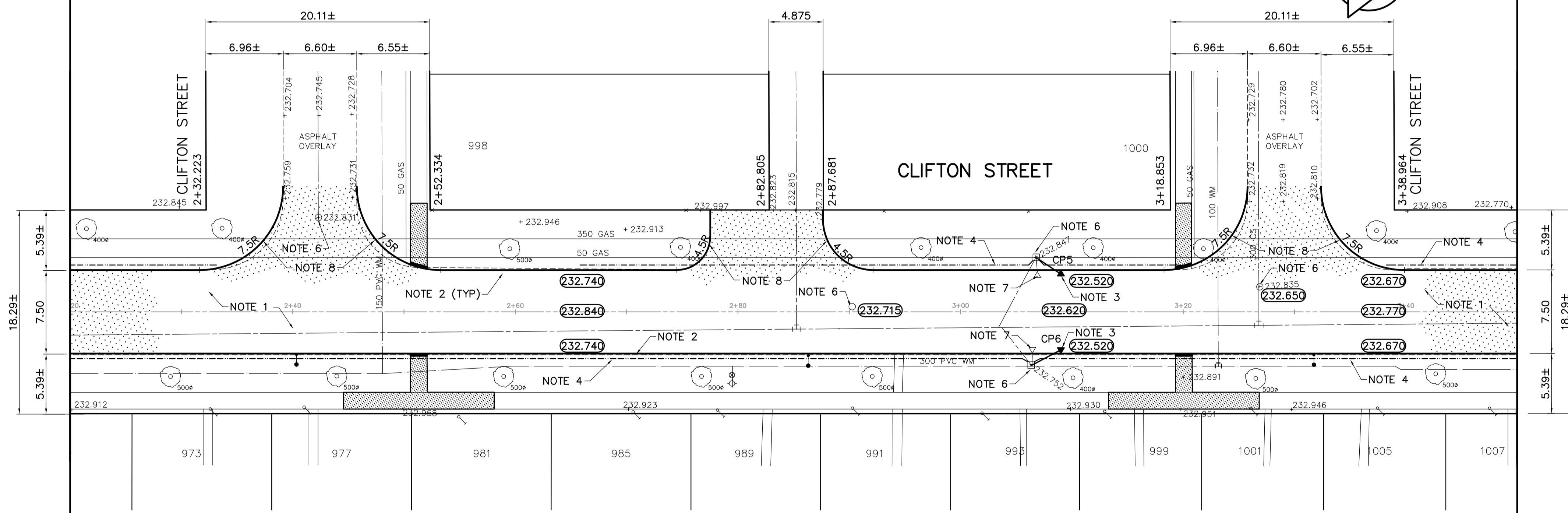

REFERENCE NOTES

- PAVEMENT DIMENSIONS ARE TO BACK OF CURB
- BASELINE IS CENTRE LINE RIGHT-OF-WAY
- PROPERTY LINES OBTAINED FROM CITY OF WINNIPEG L.B.I.S., AND NO SCALE FACTOR WAS APPLIED.

CONSTRUCTION NOTES

- REMOVE EXISTING PAVEMENT AND CONSTRUCT NEW 150mm REINFORCED CONCRETE PAVEMENT.
- CONSTRUCT NEW CONCRETE BARRIER CURB (SEPARATE).
- INSTALL NEW CURB AND GUTTER INLET (SD023) c/w NEW 250 LEAD TO EXISTING CATCHBASIN.
- INSTALL 150 SUBDRAIN.
- ADJUST EXISTING WATER VALVE TO GRADE.
- ADJUST EXISTING MANHOLE/CATCHBASIN TO GRADE.
- ABANDON EXISTING DRAINAGE INLET.
- CONSTRUCT NEW MODIFIED BARRIER CURB (INTEGRAL).

APEGN
 Certificate of Authorization
 Earth Tech Canada Inc.
 No. 730 Expiry: April 30, 2005

METRIC
 WHOLE NUMBERS INDICATE MILLIMETRES
 DECIMALIZED NUMBERS INDICATE METRES

EXISTING	LEGEND - PLAN	PROPOSED	EXISTING	LEGEND - PLAN	PROPOSED	EXISTING	LEGEND - PROFILE	PROPOSED
150 mm W.M.	WATERMAIN	150 mm W.M.	HYDRO	M.T.S.	150 mm W.M.	WATERMAIN	HYDRANT	150 mm W.M.
300mm L.D.S.	LAND DRAINAGE SEWER	300mm L.D.S.	CONCRETE	ASPHALT	300mm L.D.S.	LAND DRAINAGE SEWER	VALVE	300mm L.D.S.
250mm W.W.S.	WASTEWATER SEWER	250mm W.W.S.	PROPERTY LINE	SURVEY BAR	250mm W.W.S.	WASTE WATER SEWER	PROFILE	250mm W.W.S.
○	MANHOLE	○	ELEVATION	(32.750)	○	N/W GUTTER	○	○
□	CATCH BASIN	□	TREE	○	○	S/E GUTTER	○	○
▽	CURB INLET	▽	SIDEWALK RAMP	◇	◇	N/W PROPERTY LINE	◇	◇
+	JUNCTIONS	+	CONCRETE SIDEWALK	○	○	S/E PROPERTY LINE	○	○
—	CULVERT	—	FENCE					
—	GAS							

LOCATION APPROVED UNDERGROUND STRUCTURES

SUPV. U/G STRUCTURES COMMITTEE DATE _____

NOTE:
 LOCATION OF UNDERGROUND STRUCTURES AS SHOWN ARE BASED ON THE BEST INFORMATION AVAILABLE, BUT NO GUARANTEE IS GIVEN THAT ALL EXISTING UTILITIES ARE SHOWN OR THAT THE GIVEN LOCATIONS ARE EXACT. CONFIRMATION OF EXISTENCE AND EXACT LOCATION OF ALL SERVICES MUST BE OBTAINED FROM THE INDIVIDUAL UTILITIES BEFORE PROCEEDING WITH CONSTRUCTION.

B.M. 37-025 TBLT. IN W. CONC. FNDN. #919/925 WALL ST. 1m N. & 0.1m BELOW CONC. ELEV. 233.121 BLOCK OF S.W. CNR. BUILDING.

NO.	REVISIONS	DATE	BY
2	ISSUED FOR TENDER	05/04	BC
1	ISSUED FOR REVIEW	05/03/11	BC

EarthTech
 A Tyco International Ltd. Company

DESIGNED BY: BC/BK CHECKED BY: TGS
 DRAWN BY: BC APPROVED BY: ORIGINAL SIGNED
 HOR. SCALE: 1=250
 VERTICAL: 1=10
 2005/03/08

ENGINEER'S SEAL
 PROVINCE OF MANITOBA
 ORIGINAL SIGNED
T.G. SMITH
 April 25, 2005
 REGISTERED PROFESSIONAL ENGINEER

THE CITY OF WINNIPEG
 PUBLIC WORKS DEPARTMENT
 Winnipeg ENGINEERING DIVISION

CLIFTON STREET
 ELLICE AVENUE TO SARGENT AVENUE

PAVEMENT RECONSTRUCTION
 PLAN/PROFILE
 STATION 2+20 TO STATION 3+50

CITY DRAWING NUMBER
 SHEET 2 OF 3

CONSULTANT DRAWING NO. CT02