

ASPHALT OVERLAY SECTION
STA. 1+18.5 TO STA. 4+57.0

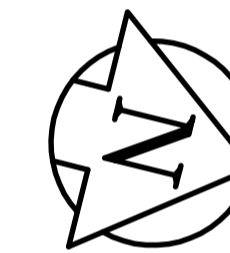

- REFERENCE NOTES**
- BASELINE IS CENTRED BETWEEN NORTHBOUND AND SOUTHBOUND GUTTER BACK OF CURB LINE.
 - LEGAL PLAN - L.B.I.S.
 - ADD 200.000 TO OBTAIN GEODETIC DATUM.
 - PAVEMENT DIMENSIONS ARE TO BACK OF CURB.
 - EARTH TECH FIELD BOOK NO. 4407.

- CONSTRUCTION NOTES**
- PLANE AND CONSTRUCT NEW ASPHALTIC CONCRETE OVERLAY.
 - REMOVE ASPHALT AND CONSTRUCT NEW ASPHALT SIDEWALK.
 - CONSTRUCT NEW 150mm REINFORCED CONCRETE PAVEMENT c/w ASPHALTIC CONCRETE OVERLAY.
 - CONSTRUCT NEW MONOLITHIC CONCRETE BULLNOSE.
 - CONSTRUCT NEW MONOLITHIC CONCRETE MEDIAN SLAB.
 - CONSTRUCT NEW MONOLITHIC CONCRETE SPLASH STRIP.
 - ADJUST EXISTING MANHOLE FRAME AND COVER.
 - ADJUST EXISTING CURB AND GUTTER INLET FRAME AND COVER.
 - ADJUST EXISTING WATERMAIN VALVE BOX TO GRADE.
 - OVERLAY EXISTING GRAVEL AND ASPHALT SHOULDER.
 - REGRADE EXISTING DITCH AND SEED.
 - PLANE EXIST. ASPHALT OVERLAY AND CONSTRUCT 100mm TYPE III ASPHALT BASE COURSE AND 50mm TYPE 1A ASPHALT SURFACE COURSE

APEGM
Certificate of Authorization
Earth Tech Canada Inc.
No. 730 Expiry: April 30, 2006

METRIC
WHOLE NUMBERS INDICATE MILLIMETRES
DECIMALIZED NUMBERS INDICATE METRES

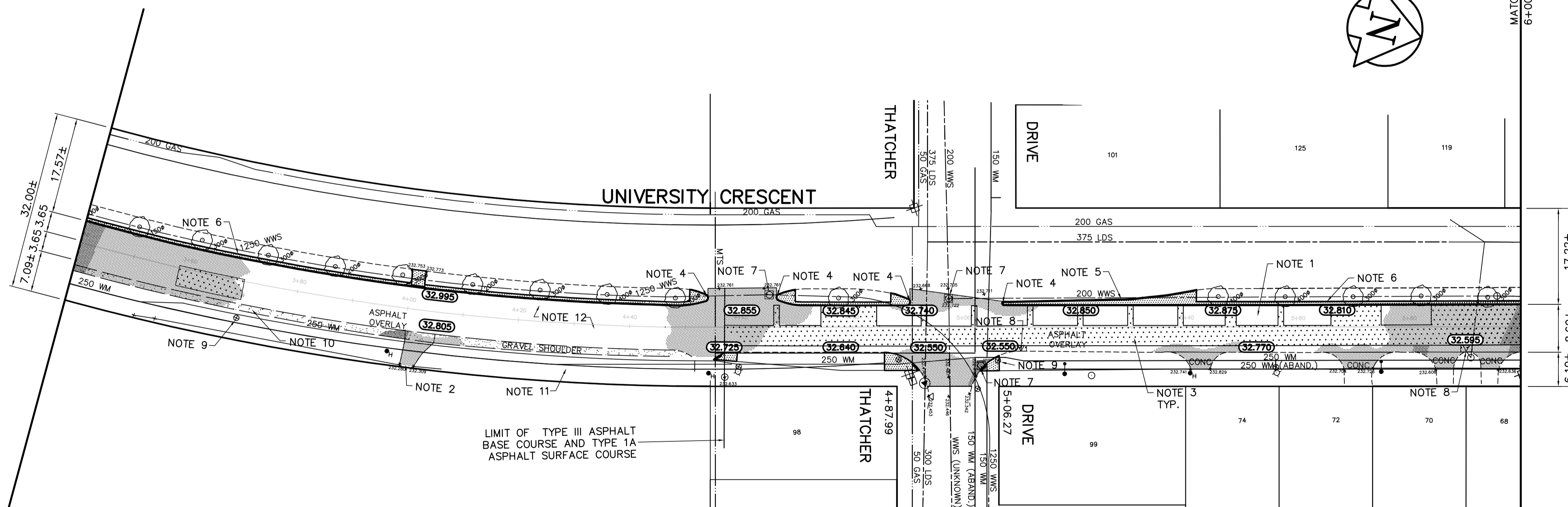

EXISTING	LEGEND - PLAN	PROPOSED	EXISTING	LEGEND - PLAN	PROPOSED	EXISTING	LEGEND - PROFILE	PROPOSED
150 mm W.M.	WATERMAIN	150 mm W.M.	HYDRO	HYDRO	---	⊙	PROFILE	---
⊙	HYDRANT	⊙	M.T.S.	M.T.S.	---	⊙	WEST MEDIAN GUTTER	---
⊙	VALVE	⊙	CONCRETE	CONCRETE	---	⊙	EAST MEDIAN GUTTER	---
300mm L.D.S.	LAND DRAINAGE SEWER	300mm L.D.S.	ASPHALT	ASPHALT	---	⊙	WEST GUTTER	---
250mm W.W.S.	WASTEWATER SEWER	250mm W.W.S.	PROPERTY LINE	PROPERTY LINE	---	⊙	EAST GUTTER	---
○	MANHOLE	○	SURVEY BAR	SURVEY BAR	---			
□	CATCH BASIN	□	ELEVATION	ELEVATION	(32.750)			
▽	CURB INLET	▽	TREE	TREE	---			
+	JUNCTIONS	+	SIDEWALK RAMP	SIDEWALK RAMP	---			
—	CULVERT	—	CONCRETE SIDEWALK	CONCRETE SIDEWALK	---			
—	GAS	—	FENCE	FENCE	---			

LOCATION APPROVED UNDERGROUND STRUCTURES
ORIGINAL SIGNED 03/29/05
SUPV. U/G STRUCTURES DATE COMMITTEE

NOTE:
LOCATION OF UNDERGROUND STRUCTURES AS SHOWN ARE BASED ON THE BEST INFORMATION AVAILABLE, BUT NO GUARANTEE IS GIVEN THAT ALL EXISTING UTILITIES ARE SHOWN OR THAT THE GIVEN LOCATIONS ARE EXACT. CONFIRMATION OF EXISTENCE AND EXACT LOCATION OF ALL SERVICES MUST BE OBTAINED FROM THE INDIVIDUAL UTILITIES BEFORE PROCEEDING WITH CONSTRUCTION.

B.M. 76-074 in median of Pembina Highway, S. of Bishop Grandin Blvd., 701 m. E. of 8.000 m. Conc. Box, 24.9 m S. of C.C. of bus exit lane located in median of Pembina Highway University Cres. at 1.1 m E. of W. curb of median.

NO.	REVISIONS	DATE	BY
1	ISSUED FOR TENDER	05/05	KR
A	ISSUED FOR REVIEW	02/05	BC

EARTH TECH
Earth Tech (Canada) Inc. Winnipeg, Manitoba 204.477.5381

DESIGNED BY	CHECKED BY
RC	BC/TGS
DRAWN BY	APPROVED BY
RC	
HOR. SCALE:	VERTICAL:
1=500	1=20
RELEASED FOR CONSTRUCTION BY:	DATE

ENGINEER'S SEAL
PROVINCE OF MANITOBA
ORIGINAL SIGNED
K.W.
RAE
MAY 30/05
REGISTERED PROFESSIONAL ENGINEER

THE CITY OF WINNIPEG
PUBLIC WORKS DEPARTMENT
ENGINEERING DIVISION

UNIVERSITY CRESCENT - NORTHBOUND
MARKHAM ROAD TO PEMBINA HIGHWAY
CONCRETE REPAIRS AND ASPHALT RESURFACING

CITY DRAWING NUMBER P-3260-03
SHEET 3 OF 5

PLAN-PROFILE
STA. 3+40 TO STA. 6+00

CONSULTANT DRAWING NO. CT07