

SHEET NO. A-5
 FILE NO. 2417
 DRAWN KLM
 DATE APR 19/05
 SCALE 1/8" = 1'0"

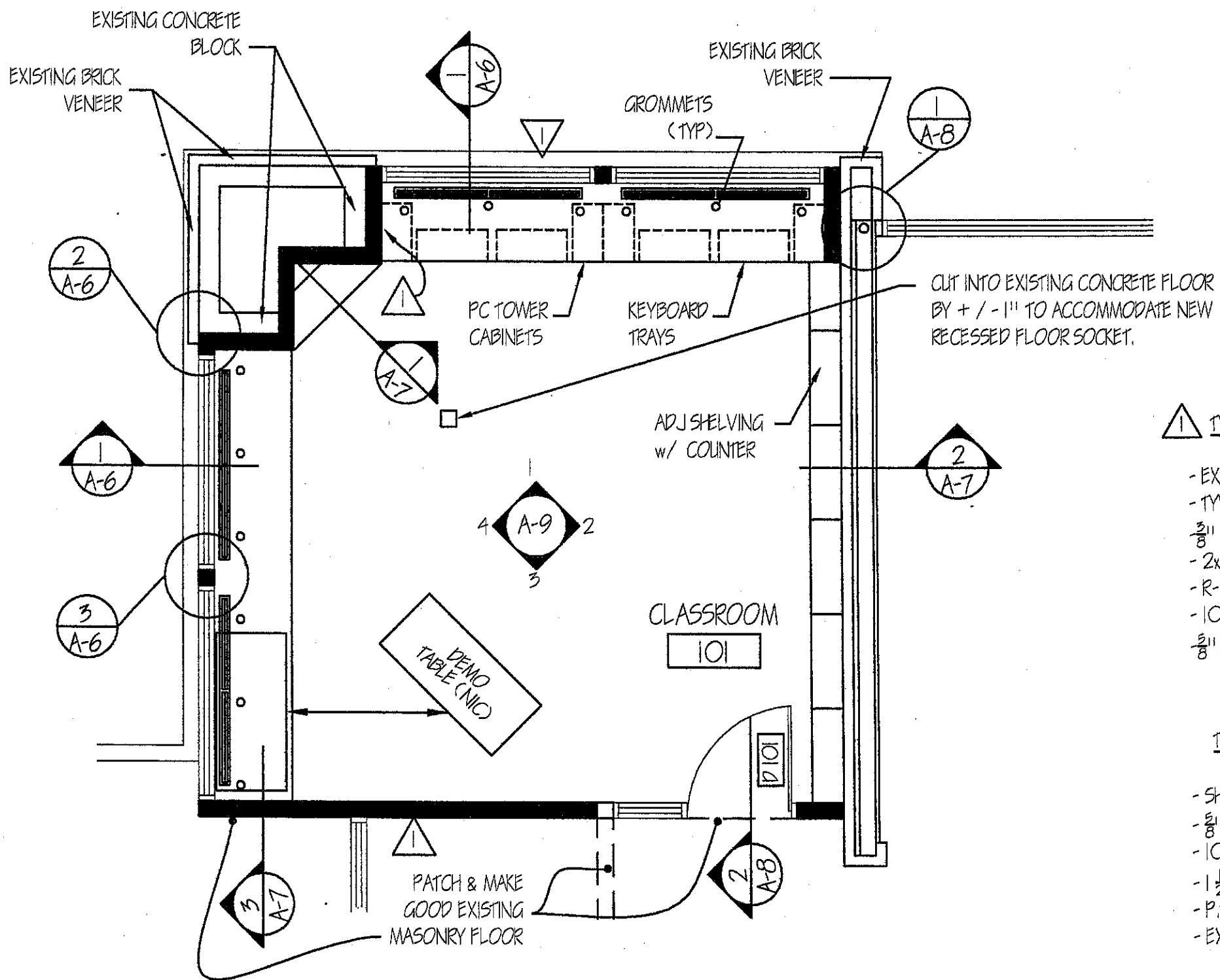

▲ TYPICAL EXTERIOR WALL

- EXTERIOR 1x6 T&G CEDAR FINISH
- TYVEK AIR BARRIER
- 5/8" PLYWOOD SHEATHING
- 2x6 @ 16" o/c
- R-20 BATT INSULATION
- 10mil POLY VAPOR BARRIER
- 5/8" DRYWALL

TYPICAL NEW FLOOR

- SHEET VINYL ON 1/4" G15 FIR PLYWOOD
- 5/8" T&G PLYWOOD (P.T.)
- 10mil POLY VAPOR BARRIER
- 1 1/2" RIGID INSULATION
- P.T. 2x3 @ 16" o/c
- EXISTING CONC. FLOOR

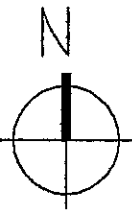

1 CLASSROOM PLAN
 A-5 1/4" = 1'0"

SHEET TITLE
CLASSROOM PLAN

PROJECT TITLE
LIVING PRAIRIE MUSEUM
2795 NESS AVE

218 OVERDALE STREET
 WINNIPEG, MB. R3J 2G3
 PHONE: (204)832-8666
 FAX: (204)889-1030

GERALD A. KORZENIOWSKI
ARCHITECT INC.

