

FAIRFIELD AVENUE
RIGHT OF WAY CROSS SECTION
HOR. 1 : 200, VER. 1 : 100

CIRCULAR CURVE DATA				
CURVE NO.	C1	C2	C3	C4
RADIUS	7.50	46.25	7.50	53.75
DELTA	101°09'36"	5°04'06"	82°58'00"	9°11'41"
TANGENT	9.12	2.05	6.63	4.32
LENGTH	13.24	4.09	10.86	8.63

- CONSTRUCTION NOTES:
- SEE DETAIL SHEET FOR CURB TYPE AND LOCATION.
 - ALL CATCHBASINS TO BE AS PER SD-024 UNLESS OTHERWISE NOTED.
 - ALL HYDRANTS TO BE AS PER SD-006/SD-007 AND 2.8m FROM PROPERTY LINE. UNLESS OTHERWISE NOTED.
 - ALL CATCHBASIN LEADS TO BE 250mm AT A MINIMUM 1.5% UNLESS OTHERWISE NOTED.
 - MODIFIED BARRIER CURB AT ALL INTERSECTION RADII. 3.0m TRANSITION.
 - ALL EXISTING UTILITIES USED FOR CONNECTIONS TO HAVE INVERTS VERIFIED PRIOR TO CONSTRUCTION.
 - ALL RADII AT INTERSECTIONS 7.5m UNLESS OTHERWISE NOTED.
 - ALL PIPE BACKFILL UNDER BOULEVARD TO BE CLASS 4 UNLESS OTHERWISE NOTED.
 - ALL PIPE UNDER EXISTING OR FUTURE PAVEMENT TO BE CORED OR HAVE CLASS 2 BACKFILL.
 - ALL WATER SERVICE CONNECTIONS TO BE 20mm DIA. AND ALL SEWER TO BE 150mm DIA. UNLESS OTHERWISE NOTED.
 - ALL EXISTING CULVERTS ARE TO BE REMOVED AND DISPOSED OF.

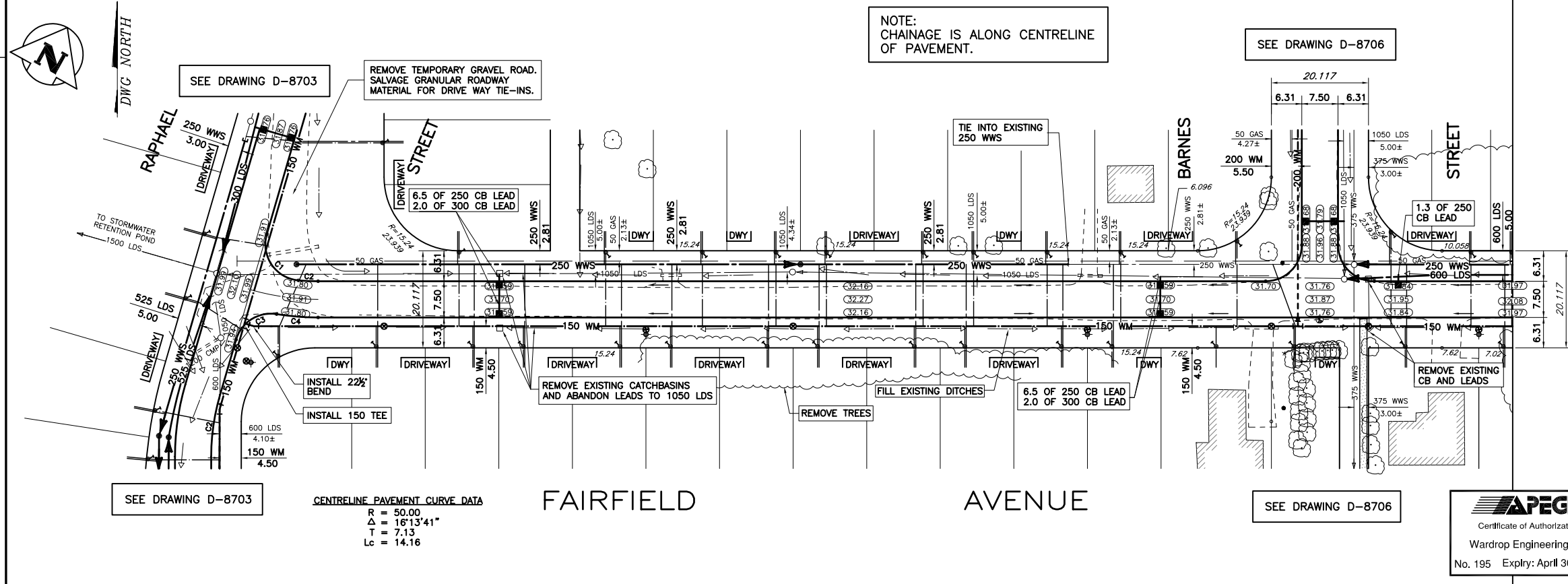

CENTRELINE PAVEMENT CURVE DATA

R = 50.00
Δ = 16°13'41"
T = 7.13
Lc = 14.16

SEE DRAWING D-8708

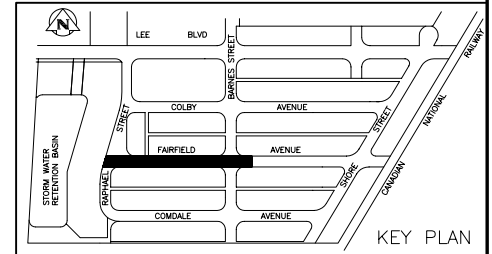

EXISTING	LEGEND-PLAN	PROPOSED	EXISTING	LEGEND-PLAN	PROPOSED	EXISTING	LEGEND-PLAN	PROPOSED
WATERMAIN	HYDRANT	VALVE	300 LDS	LAND DRAINAGE SEWER	250 WWS	MANHOLE	CATCHBASIN	CURB INLET
JUNCTIONS	CULVERT	LEGEND-PLAN	PROPOSED	EXISTING	LEGEND-PLAN	PROPOSED	EXISTING	LEGEND-PLAN
GAS	M.T.S.	CONCRETE	SIDEWALK	ASPHALT	CONCRETE CURB	SIDEWALK RAMP	GRAVEL	PROPERTY LINE
LOT LINE	PROPOSED	EXISTING	LEGEND-PLAN	PROPOSED	EXISTING	LEGEND-PLAN	PROPOSED	EXISTING
DITCH/SWALE	HYDRO POLE	LIGHT STANDARD	ANCHOR	TREE	BUSHLINE	SURVEY BAR	LEGAL UNIT	BUILDING
TEST HOLE	PROPOSED	EXISTING	LEGEND-PLAN	PROPOSED	EXISTING	LEGEND-PLAN	PROPOSED	EXISTING

LOCATION APPROVED UNDERGROUND STRUCTURES

DESIGNED BY: GL./L.L. CHECKED BY: G.S.

DRAWN BY: NL APPROVED BY:

ISSUED FOR TENDER: 05.04.11 GS

ISSUED FOR APPROVAL: 05.04.08 GS

DATE: 05.03.29

WARDROP Engineering Inc.

DESIGNED BY: GL./L.L. CHECKED BY: G.S.

DRAWN BY: NL APPROVED BY:

ISSUED FOR TENDER: 05.04.11 GS

ISSUED FOR APPROVAL: 05.04.08 GS

DATE: 05.03.29

L.G.P. CHAMBERS

REGISTERED PROFESSIONAL ENGINEER

CONSULTANT DRAWING NO. 05129401-DWG-C1010

THE CITY OF WINNIPEG

PLANNING, PROPERTY AND DEVELOPMENT

FAIRFIELD PARK LOCAL IMPROVEMENT DISTRICT STAGES II, III & IV

FAIRFIELD AVENUE RAPHAEEL STREET TO 30m EAST OF BARNES STREET

CITY DRAWING NUMBER: D-8707

SHEET: 10 OF 16

C1010