

PAVEMENT PROFILE
VERTICAL SCALE: 1:10

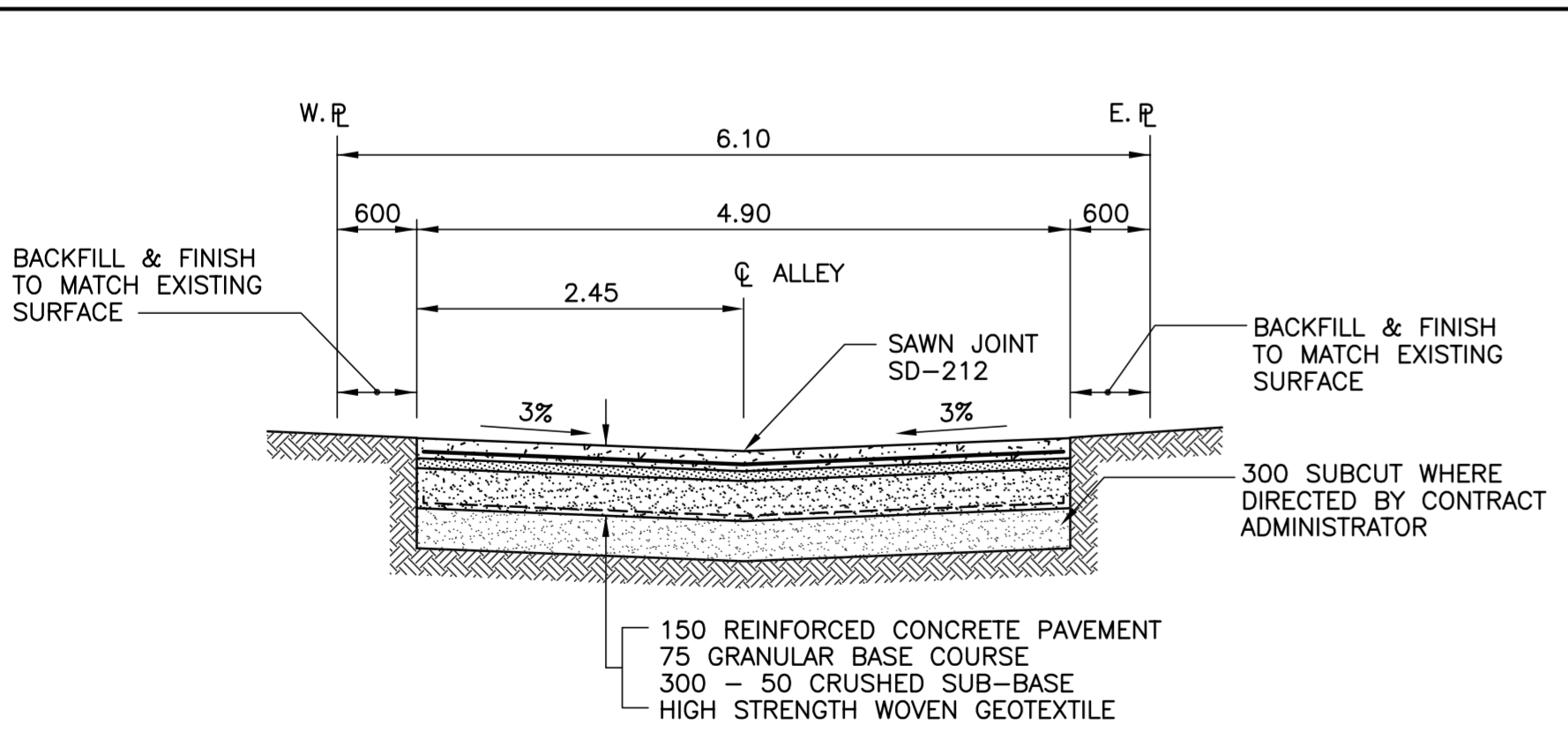

TYPICAL CROSS SECTION
SCALE: 1:50

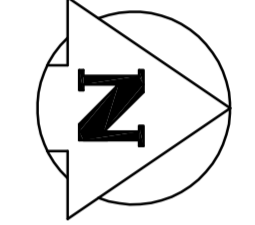
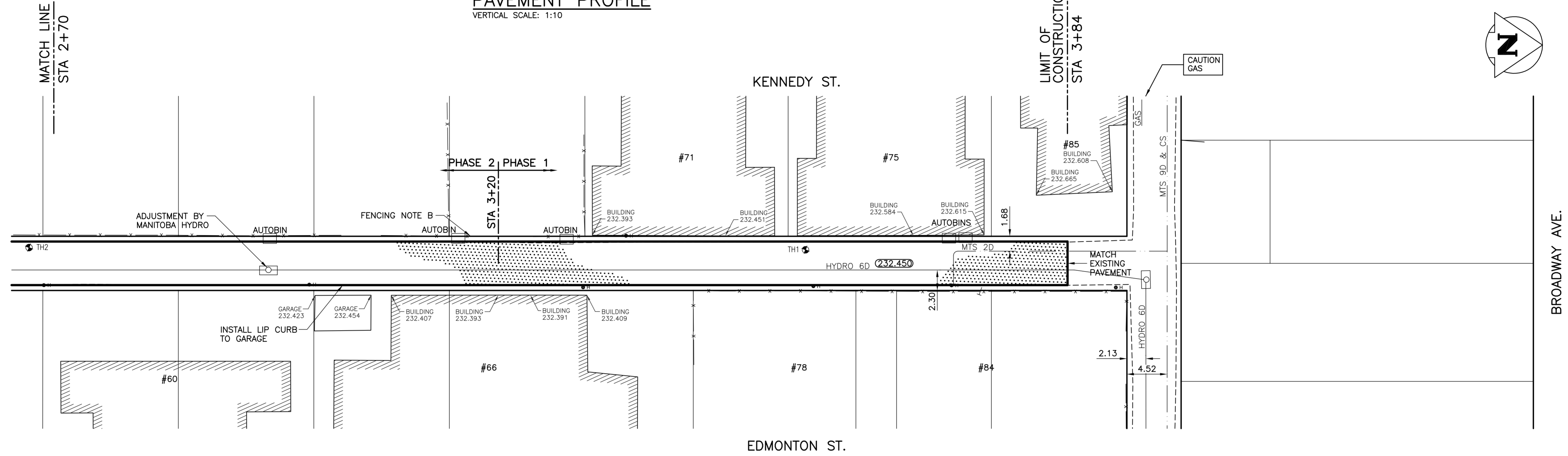
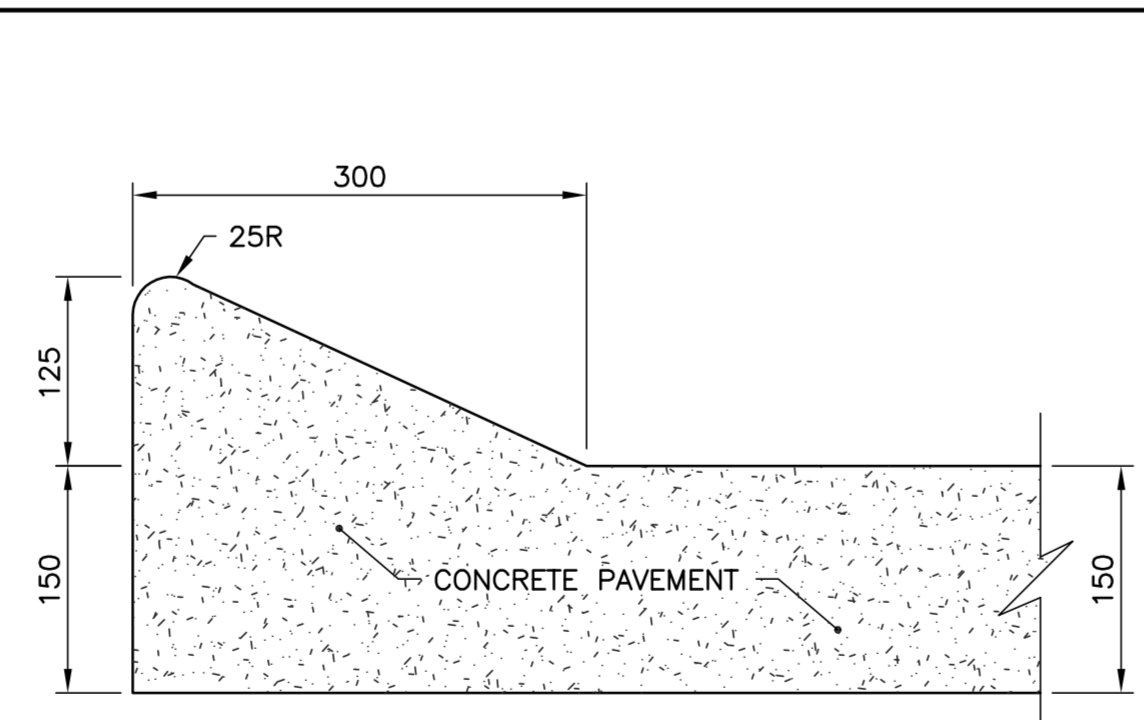

LIP CURB DETAIL
SCALE: 1:5

- FENCING NOTES:
- A. REMOVE AND RESTORE 3.00M POWERED WOOD FENCE.
 - B. REMOVE AND RESTORE 3.00M UNPOWERED WOOD FENCE.
 - C. REMOVE AND RESTORE 6.50M POWERED WOOD FENCE.
 - D. REMOVE AND RESTORE 5.00M POWERED WOOD FENCE.

- NOTES:
1. ADJUST MH AND CB RIMS TO NEW GRADES.
 2. AVOID DAMAGE TO EXISTING TREES WITHIN THE LIMITS OF CONSTRUCTION.
 3. REGRADE EXISTING PRIVATE SIDEWALKS AS REQUIRED.
 4. LIGHT STANDARDS, HYDRO POLES AND ANCHORS MAY REQUIRE TEMPORARY SUPPORT/REMOVAL OR REPLACEMENT AT THE CONTRACTORS EXPENSE.
 5. BE AWARE OF EXISTING OVERHEAD LINES WITHIN CONTRACT LIMITS.
 6. SUPPLY AND INSTALL 24 HOUR EARLY OPENING CONCRETE FOR KENNEDY / EDMONTON ALLEY.
 7. CHAINAGE ALONG ALLEY CENTERLINE.
 8. ISOLATE ALL POLES, BASES AND PILES WITHIN ALLEY RIGHT-OF-WAY (SD-228C)
 9. MOVE ALL AUTOBINS TO ACCESSIBLE AREAS FOR COLLECTION. RETURN AUTOBINS TO ORIGINAL LOCATIONS FOLLOWING CONSTRUCTION.

WARNING

IF POWER EQUIPMENT OR EXPLOSIVES ARE TO BE USED FOR EXCAVATION ON THIS PROJECT THE CONTRACTOR MUST:
 1) NOTIFY THE GAS COMPANY OF THE PROPOSED LOCATION OF EXCAVATION.
 2) TAKE PRECAUTION TO AVOID DAMAGE TO GAS COMPANY INSTALLATIONS.
 SEE PROVINCIAL REGULATION 210/72 FOR DETAILS.

METRIC

WHOLE NUMBERS INDICATE MILLIMETRES
 DECIMALIZED NUMBERS INDICATE METRES

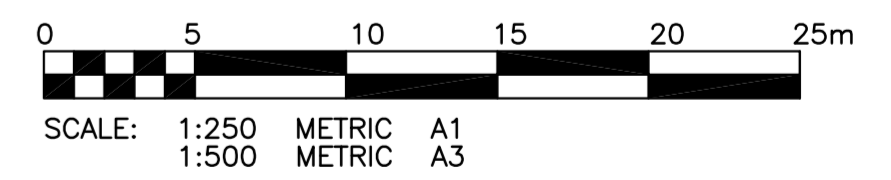

SUB-DRAIN		POLES	
300 LBS	LAND DRAINAGE SEWER	•	TEST HOLE
250 WWS	WASTE WATER SEWER	⊕	GUY WIRE
---	GAS	—+—	LIGHT STANDARD
---	HYDRO	---	BACK OF CURB
---	M.T.S.	---	CONCRETE
150 WM	WATERMAIN	---	ASPHALT
⊕	HYDRANT	---	SIDEWALK
⊙	VALVE	---	PROPERTY LINE
⊙	MANHOLE	⊕	SURVEY BAR
□	CATCH BASIN	⊕	GEODETIC BENCHMARK
▽	CURB INLET	231.334	ELEVATION
---	EXISTING	---	LEGEND-PLAN
---	PROPOSED	---	LEGEND-PROFILE

LOCATION APPROVED UNDERGROUND STRUCTURES

NOTE:
 LOCATION OF UNDERGROUND STRUCTURES AS SHOWN ARE BASED ON THE BEST INFORMATION AVAILABLE BUT NO GUARANTEE IS GIVEN THAT ALL EXISTING UTILITIES ARE SHOWN OR THAT THE GIVEN LOCATIONS ARE EXACT. CONFIRMATION OF EXISTENCE AND EXACT LOCATION OF ALL SERVICES MUST BE OBTAINED FROM THE INDIVIDUAL UTILITIES BEFORE PROCEEDING WITH CONSTRUCTION.

B.M. 35-014	ELEV. 232.527m	69M24 - D.B.M. IN LEGISLATIVE GROUNDS, 44.2m S. OF S. SIDEWALK OF BROADWAY, 18.6m W. OF W. SIDEWALK ON KENNEDY ST.	
NO.	ISSUED FOR TENDER	05/04/04	CR
NO.	REVISIONS	DATE	BY

KGS GROUP
 CONSULTING ENGINEERS & PROJECT MANAGERS
 WINNIPEG (204) 896-1209
 THUNDER BAY (807) 345-2233

DESIGNED BY: C.R.
 CHECKED BY:
 DRAWN BY: A.M.
 APPROVED BY:
 HOR. SCALE: 1:250
 VERTICAL: 1:10
 RELEASED FOR CONSTRUCTION:
 DATE: APRIL 04, 2005

ENGINEER'S SEAL

 CONSULTANT DRAWING NO. 04-0107-18

THE CITY OF WINNIPEG
 PUBLIC WORKS DEPARTMENT
 ENGINEERING SERVICES DIVISION

PROJECT TITLE: 2005 ALLEY RENEWAL PROGRAM
 KENNEDY / EDMONTON ALLEY PAVEMENT RECONSTRUCTION
 SURFACE PLAN AND PROFILE
 STA. 2+70 TO BROADWAY SOUTH ALLEY

SHEET	02	OF	08
COMPUTER FILE NAME	KENNEDY-PLOT-REV0.DWG		
CITY DRAWING NUMBER	0002		

P:\Projects\2004\04-0107-18\Wm\Drawings\20050404 - ISSUED FOR TENDER\KENNEDY-PLOT-REV0.DWG