

GENERAL NOTES:

1. Play structure components to be installed by supplier.
2. Contractor is responsible for co-ordinating installation and supplier.
3. Contractor is responsible for ensuring that components are installed as per CSA and manufacturer's instructions.

SURVEY SOURCE: SHEPHERD & STEVENS 04168315

No.	Revision	Date
7	ISSUED FOR TENDER	FEB 24/05
6	PRE-TENDER REVIEW	JAN 13/05
5	PRE-TENDER REVIEW	DEC 21/05
4	ISSUED FOR TENDER	SEP 15/05
3	MATERIALS & METHOD SUBMISSION	AUG 20/05
2	95% CD SUBMISSION	JULY 14/05
1	90% CD SUBMISSION	OCT 21/04



THIS DRAWING MUST NOT BE SCALED.  
 THE CONTRACTOR SHALL VERIFY ALL DIMENSIONS, DATUMS AND LEVELS PRIOR TO COMMENCEMENT OF WORK. ALL ERRORS AND OMISSIONS TO BE REPORTED IMMEDIATELY TO THE CONTRACT ADMINISTRATOR.  
 VARIATIONS & MODIFICATIONS TO WORK SHOWN ON THESE DRAWINGS SHALL NOT BE CARRIED OUT WITHOUT WRITTEN PERMISSION FROM THE CONTRACT ADMINISTRATOR.  
 THIS DRAWING IS THE EXCLUSIVE PROPERTY OF THE CONTRACT ADMINISTRATOR AND CAN BE REPRODUCED ONLY WITH THE PERMISSION OF THE CONTRACT ADMINISTRATOR. IN ANY CASE, THE REPRODUCTION MUST BEAR THEIR NAME AS CONTRACT ADMINISTRATOR.

VIMY RIDGE MEMORIAL PARK PLAYGROUND AREA

Project Title

SENIOR PLAY AREA LAYOUT

Drawing Title

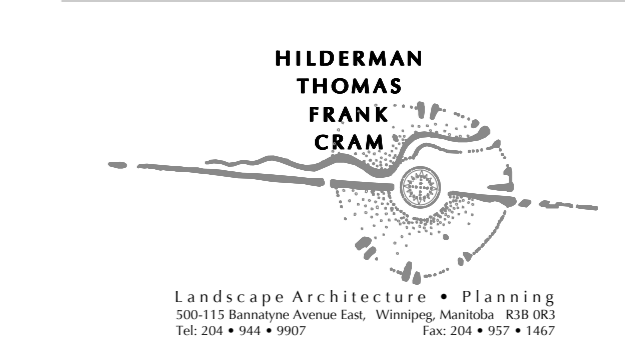

Drawn	TG/MB	Approved	HC
Scale	1:100	Date	3/3/06
Job	04 032	Drawing	L-06

**SENIOR PLAY COMPONENT LIST**

NO.	NAME	MANUFACTURER	MODEL NO.
①	2-SEAT 10' TRIPOD SWINGS	SPORTSPRAY	581-240
②	DOUBLE HUMPTY CLIMBER	LANDSCAPE STRUCTURES	100037A
③	MINI SPACE NET	LANDSCAPE STRUCTURES	3030

MANUFACTURER: LANDSCAPE STRUCTURES, SPORTSPRAY  
 SUPPLIER: PLAYGROUNDS-R-US  
 CONTACT: JODI MARR  
 250 TRANSPORT ROAD  
 WINNIPEG, MB  
 204-632-7000 (PH)  
 800-889-4305 (TOLL FREE)  
 204-632-7421 (FAX)

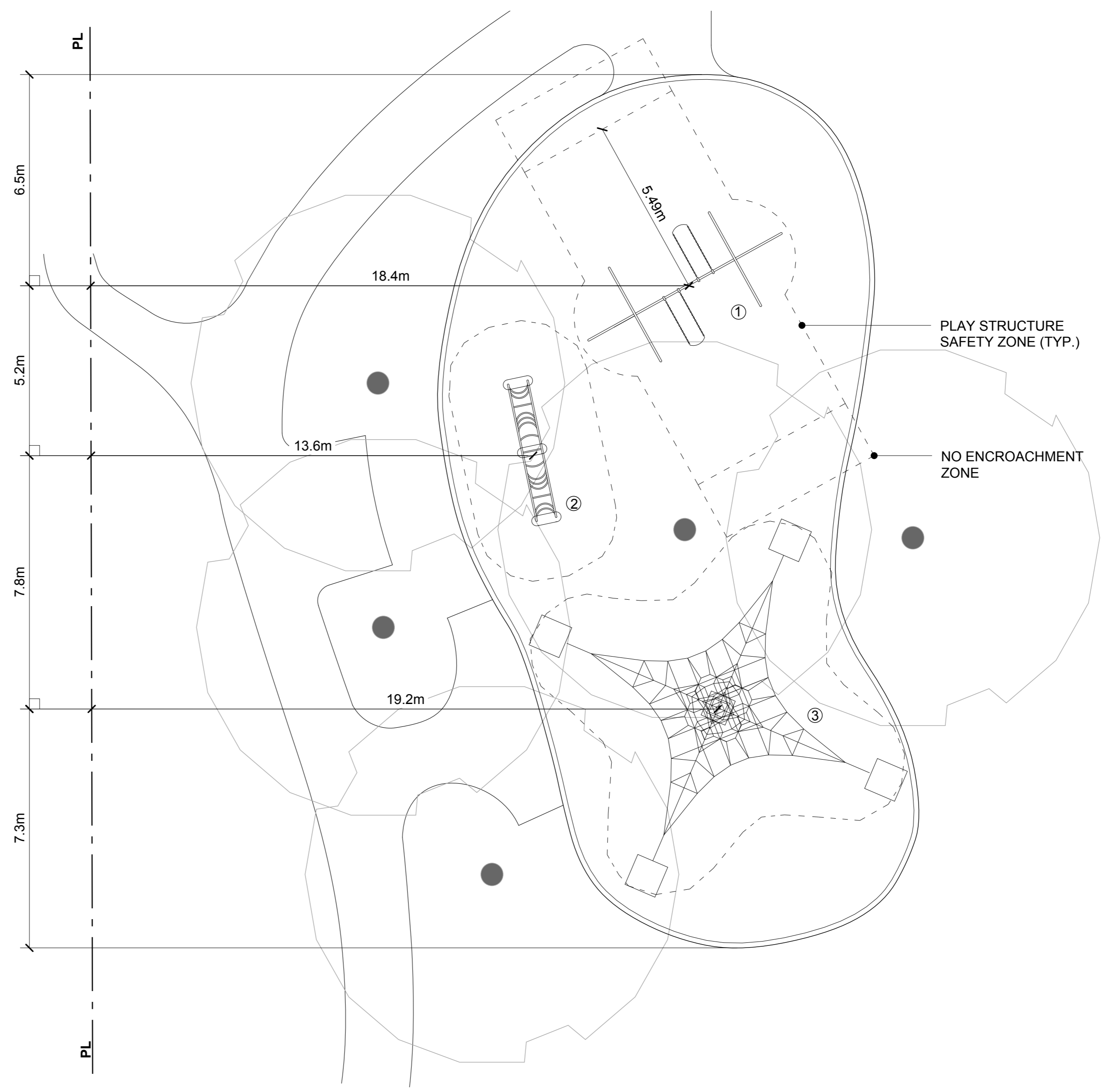

**2**  
**L-06** PLAY EQUIPMENT LAYOUT PLAN  
 SCALE: 1:100

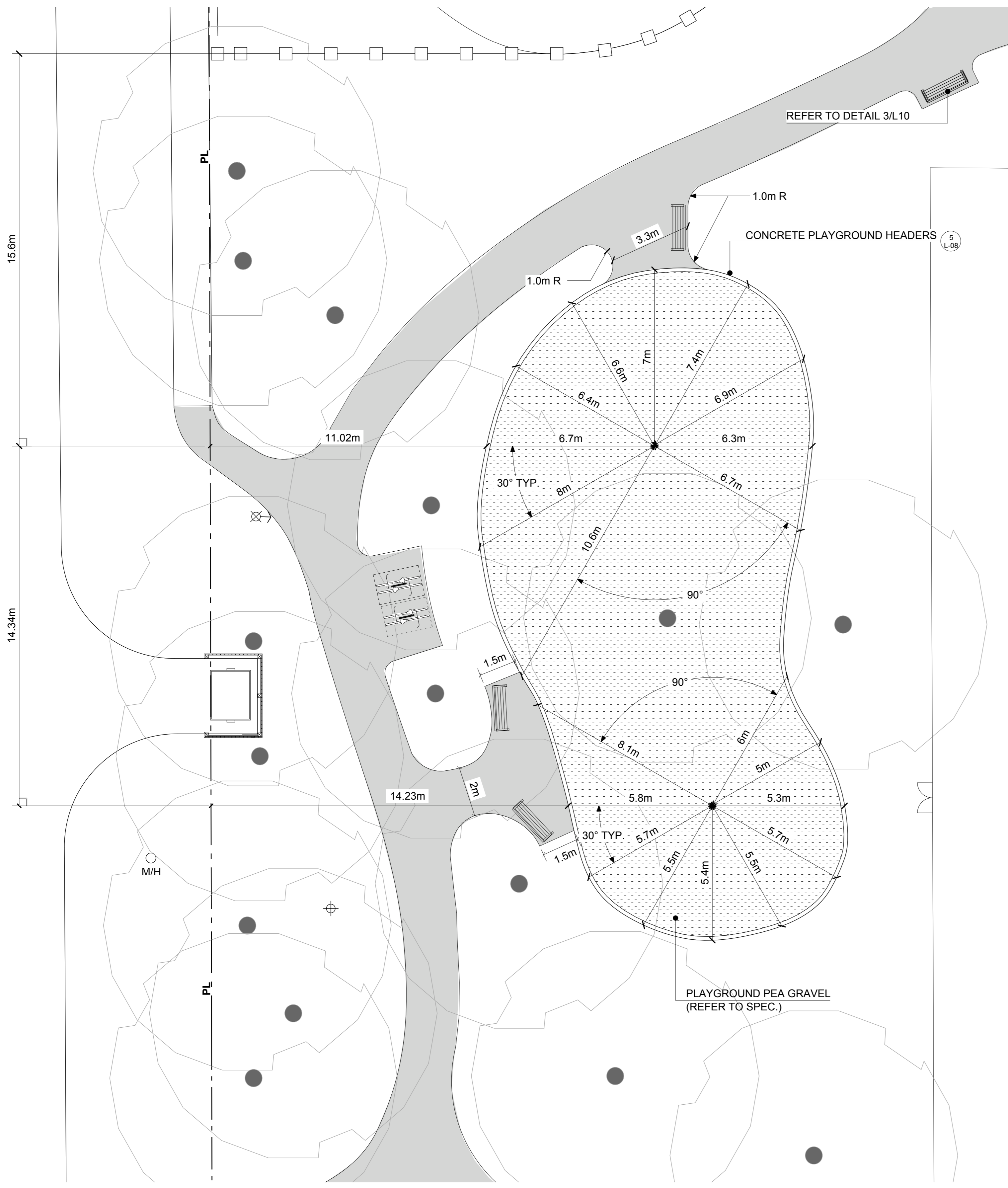

**1**  
**L-06** SENIOR PLAY AREA PLAN  
 SCALE: 1:100

**LEGEND**

	ASPHALT PAVING
	PEA GRAVEL