

AI SIZE 23.4" x 33.1" (594mm x 841mm)

PLOT: 05/06/03 2:06:30 PM

UMA FILE NAME: 0265-370-00_01-CT-004_RX.dwg Saved By: dtdozpod

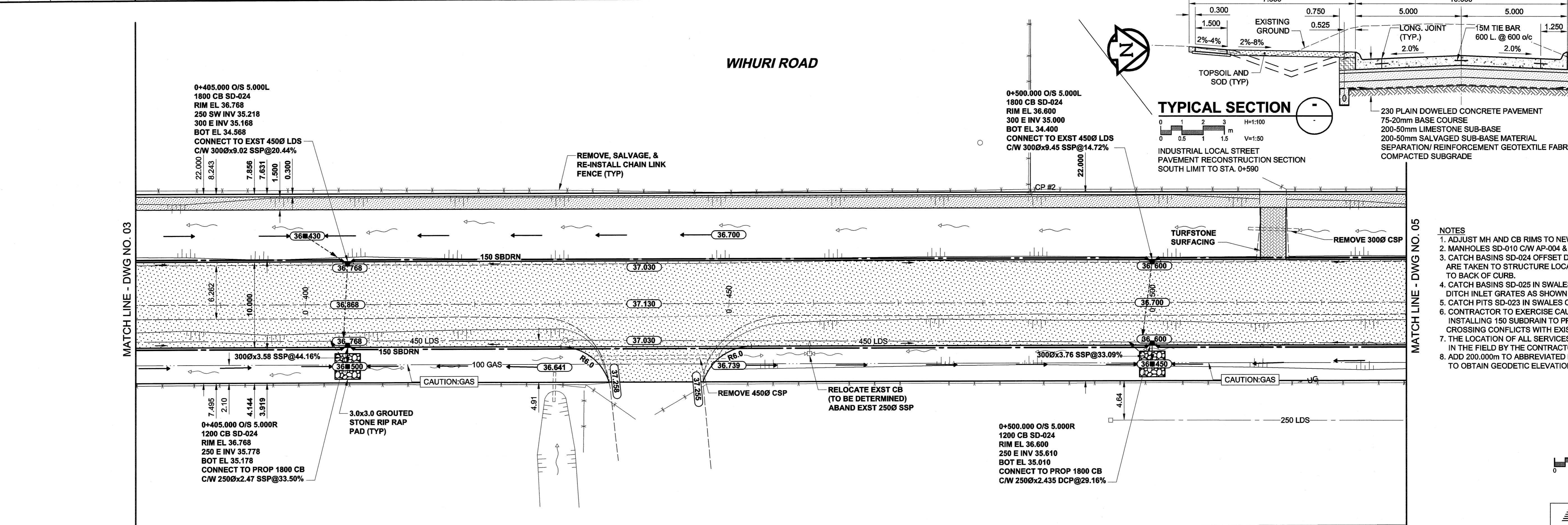
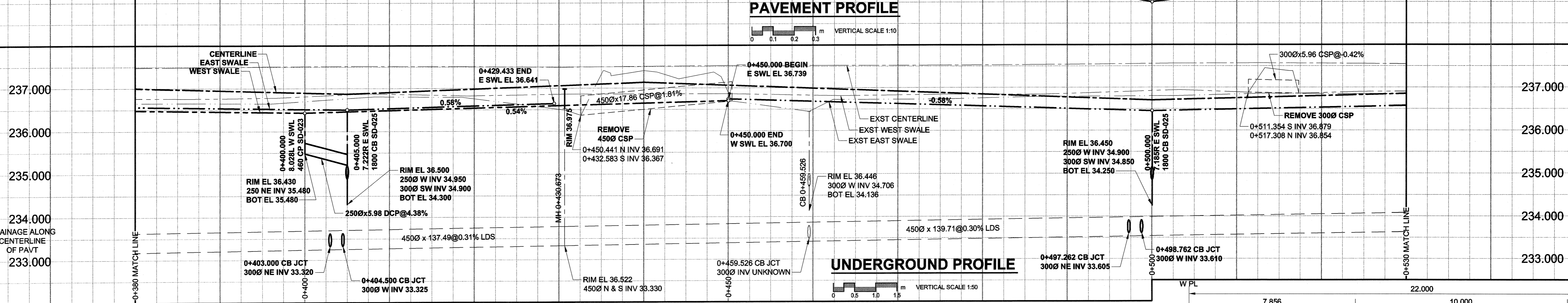
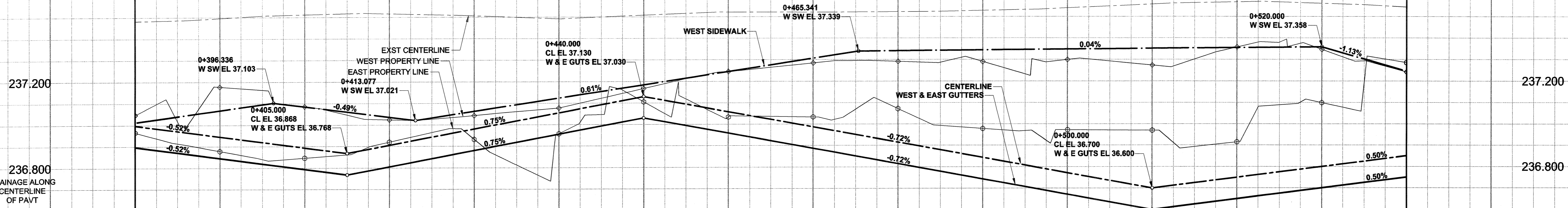

- NOTES**
- ADJUST MH AND CB RIMS TO NEW GRADES.
 - MANHOLES SD-010 C/W AP-004 & AP-005.
 - CATCH BASINS SD-024 OFFSET DIMENSIONS ARE TAKEN TO STRUCTURE LOCATIONS RELATIVE TO BACK OF CURB.
 - CATCH BASINS SD-025 IN SWALES C/W DITCH INLET GRATES AS SHOWN ON DRAWING 01
 - CATCH PITS SD-023 IN SWALES C/W AP-004 & AP-006.
 - CONTRACTOR TO EXERCISE CAUTION WHEN INSTALLING 150 SUBDRAIN TO PREVENT CROSSING CONFLICTS WITH EXISTING GAS SERVICES.
 - THE LOCATION OF ALL SERVICES TO BE CONFIRMED IN THE FIELD BY THE CONTRACTOR.
 - ADD 200.000m TO ABBREVIATED ELEVATIONS TO OBTAIN GEODETIC ELEVATIONS.

METRIC
WHOLE NUMBERS INDICATE MILLIMETRES
DECIMALIZED NUMBERS INDICATE METRES

NATURAL GAS	○	MANHOLE	●	CONCRETE PAVEMENT	[Pattern]	LOCATION APPROVED	BM 39-035 ELEV 236.740m
COMMUNICATION	□	CATCH BASIN / CATCH PIT	■	ASPHALT PAVEMENT	[Pattern]	UNDERGROUND STRUCTURES	
ELECTRICAL	⊕	C & G INLET WITH BOX	⊕	CONC. SIDEWALK/MEDIAN	[Pattern]		
CATV	⊕	TREE	⊕	PAVING STONE	[Pattern]	DATE	
TRAFFIC SIGNALS	⊕	TEST HOLE	⊕	TOPSOIL & SOD	[Pattern]	NOTE:	
LAND DRAINAGE SEWER	—	PROPERTY LINE	—	GRAVEL	[Pattern]	LOCATION OF UNDERGROUND STRUCTURES AS SHOWN ARE BASED ON THE BEST INFORMATION AVAILABLE. BUT NO GUARANTEE IS GIVEN THAT ALL EXISTING UTILITIES ARE SHOWN OR THAT THE GIVEN LOCATIONS ARE EXACT. CONFIRMATION OF EXISTENCE AND EXACT LOCATION OF ALL SERVICES MUST BE OBTAINED FROM THE INDIVIDUAL UTILITIES BEFORE PROCEEDING WITH CONSTRUCTION.	
SANITARY/COMBINED SEWER	—	SURVEY BAR	—	RAMP CURB	[Pattern]		
CATCHBASIN LEAD	—	FENCE	—	REMOVAL	[Pattern]		
WATERMAIN	—	BOC/EOPAVT	—				
SUBDRAIN	—	ELEVATION	33.100				
DITCH	—						
EXISTING	LEGEND - PLAN	NEW	EXISTING	LEGEND - PLAN	NEW	EXISTING	LEGEND - PLAN

DESIGNED BY	JGK	CHECKED BY	RB
DRAWN BY	DID	APPROVED BY	Barb
HOR. SCALE	1:250	RELEASED FOR CONSTRUCTION	Barb Deane
VERT. SCALE	AS SHOWN	DATE	JUNE 7, 2005
NO. REVISIONS		DATE	05/08/06

uma
An AECOM Company
2005 UMA ENGINEERING LTD. ALL RIGHTS RESERVED.

PROFESSIONAL'S SEAL
PROVINCE OF MANITOBA
J.G. KENNEDY
Member
22326
2005/06/07
REGISTERED PROFESSIONAL ENGINEER

CONSULTANT DRAWING NO. 04
0265-370-00

THE CITY OF WINNIPEG
PUBLIC WORKS DEPARTMENT
ENGINEERING DIVISION

WIHURI ROAD
PETER AVENUE TO SASKATCHEWAN AVENUE
NEW TRANSPORTATION FACILITY
ROAD CONSTRUCTION, LAND DRAINAGE SEWER,
AND ASSOCIATED WORKS
HORIZONTAL AND VERTICAL ALIGNMENT
FROM STA. 0+380 TO STA. 0+530

CITY DRAWING NUMBER
N/A

SHEET 4 OF 7

DRAWING No. 04

REV 0

BID OPPORTUNITY NO. 225-2005