

LINE No.	SIZE TYPE	DISTANCE TO PL	STOP COCK LOCATION		CORPORATION COCK LOC.	COMMENTS
			SIBERT	LONG		
252	30 COP	UNK	9.1 OUT 1.2 W OF E.H.	UNKNOWN	27.4 E OF HYD	
257	30 COP	0.3	1.1 W OF E.H.	9.4 OUT FROM EISE	42.7 E OF HYD	
258	30 COP	0.3	0.3 W OF E.H.	UNKNOWN	47.5 E OF HYD	
260	30 COP	0.3	3.7 W OF E.H.	UNKNOWN	57.9 E OF HYD	
262	30 COP	0.3	5.8 E OF W.H.	UNKNOWN	32.9 E OF HYD	
263	30 COP	0.3	8.2 E OF W COR EISE	UNKNOWN	57.9 E OF HYD	
266	30 COP	0.3	2.1 W OF E.H.	UNKNOWN	18.0 W OF HYD	
269	30 COP	0.3	7.6 E OF W COR EISE	UNKNOWN	27.4 W OF HYD	
270	30 COP	0.3	3.0 W OF E.H.	UNKNOWN	6.1 E OF HYD	
271	30 COP	0.2	0.9 W OF 1.0 COR EISE	UNKNOWN	12.5 W OF HYD	
273	30 COP	9.8 BLDG	0.3 E OF E.H.	UNKNOWN	2.4 W OF HYD	
274	30 COP	0.3	3.7 E OF W.H.	UNKNOWN	21.3 E OF HYD	
275	30 COP	0.3	8.4 E OF W COR EISE	UNKNOWN	9.1 E OF HYD	
277	30 COP	0.3	9.8 E OF W COR EISE	UNKNOWN	24.4 E OF HYD	
278	30 COP	0.3	2.7 W OF E.H.	UNKNOWN	33.5 E OF HYD	
279	30 COP	0.3	8.8 E OF W COR EISE	UNKNOWN	UNKNOWN	

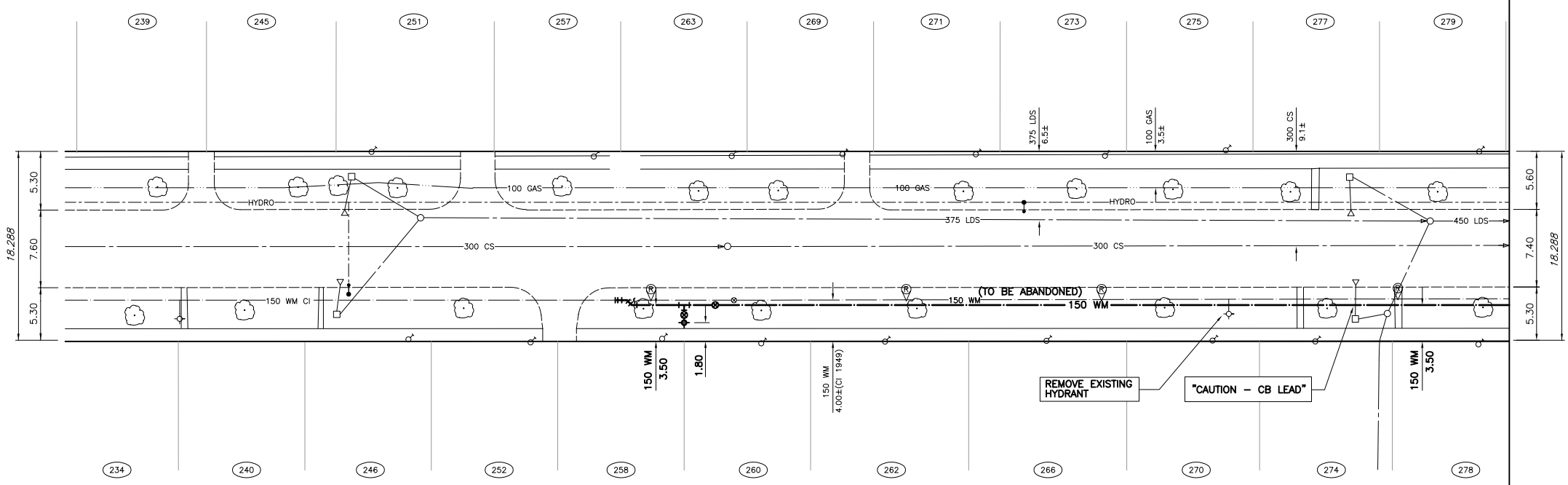

SEE DRAWING D-8803

- GENERAL NOTES:**
- CHAINAGE IS ALONG SOUTH PROPERTY LINE OF HELMSDALE AVENUE.
- CONSTRUCTION NOTES:**
- EXPOSE EXISTING WATERMAIN AT TIE-IN LOCATIONS AND CONFIRM INVERT PRIOR TO CONSTRUCTION.
 - INSTALL WATERMAIN BY TRENCHLESS METHODS.
 - ALL MATERIALS SHALL CONFORM TO THE CITY OF WINNIPEG STANDARD CONSTRUCTION SPECIFICATIONS.
 - MINIMUM COVER TO TOP OF WATERMAIN SHALL BE 2.4m.
 - NOTIFY ALL AFFECTED RESIDENTS AND BUSINESSES 24 HOURS IN ADVANCE OF ANY WATER SHUTDOWNS OR DISRUPTION OF SERVICE.

HELMSDALE AVENUE



EXISTING	LEGEND-PLAN	PROPOSED	EXISTING	LEGEND-PLAN	PROPOSED	EXISTING	LEGEND-PLAN	PROPOSED
150 WM	WATERMAIN	150 WM	BEND	ANCHOR	ANCHOR	400 FM	FEEDERMAIN	400 FM
300 LDS	LAND DRAINAGE SEWER	300 LDS	TEE	TREE	TREE	300 WWS	WASTEWATER SEWER	250 WWS
300 CS	COMBINED SEWER	300 CS	CURB STOP	LEGAL DIMENSION	LEGAL DIMENSION	300 FCM	FORCEMAIN	200 FCM
200 FCM	WATERMAIN	200 FCM	PLUG	SURVEY BAR	SURVEY BAR	HYDRANT	HYDRANT	HYDRANT
			MANHOLE	TRAFFIC SIGNAL	TRAFFIC SIGNAL	VALVE	VALVE	VALVE
			CATCHBASIN	GAS	GAS	REDUCER	REDUCER	REDUCER
			CURB INLET	HYDRO	HYDRO			
			ADDRESS	MTS	MTS			
			HYDRO POLE	SIDEWALK	SIDEWALK			
			LIGHT STANDARD	CURB	CURB			

LOCATION APPROVED UNDERGROUND STRUCTURES		B.M. CITY OF WINNIPEG 12-064 ELEV. 230.413m		F.B. 2091	
SUPV. U/G STRUCTURES	DATE	DESIGNED BY	GWC	CHECKED BY	
COMMITTEE		DRAWN BY	NL	APPROVED BY	
NOTE: LOCATION OF UNDERGROUND STRUCTURES AS SHOWN ARE BASED ON THE BEST INFORMATION AVAILABLE. BUT NO GUARANTEE IS GIVEN THAT ALL EXISTING UTILITIES ARE SHOWN OR THAT THE GIVEN LOCATIONS ARE EXACT. CONFIRMATION OF EXISTENCE AND EXACT LOCATION OF ALL SERVICES MUST BE OBTAINED FROM THE INDIVIDUAL UTILITIES BEFORE PROCEEDING WITH CONSTRUCTION.		ISSUED FOR TENDER	05.07.04	HAK	
		ISSUED FOR APPROVAL	05.06.29	HAK	
NO. REVISIONS		DATE		DATE	

WARDROP Engineering Inc.	
DESIGNED BY	GWC
CHECKED BY	
DRAWN BY	NL
APPROVED BY	
HOR. SCALE:	1 : 250
VERTICAL:	1 : 50
DATE	05.05.20
DATE	

ORIGINAL DRAWING	REVISION * * * SEALED BY
	H.A.K. KATZ
	05.06.30
CONSULTANT DRAWING NO.	0500120400-DWG-C4011

THE CITY OF WINNIPEG
WATER AND WASTE DEPARTMENT

2005 WATERMAIN RENEWALS
CONTRACT No. 9

HELMSDALE AVENUE
85m WEST OF BRAZIER STREET TO
175m WEST OF BRAZIER STREET

CITY DRAWING NUMBER
D-8802

SHEET **11** OF **14**

C4011