

SEWER SERVICE INFORMATION			
ADDRESS	SIZE	R DIST	JUNCTION TIE
215 GARRY STREET	-	-	1.83 E 1ST MH W FORT ST
215 GARRY STREET	-	-	NO INFORMATION AVEAVAILABLE
223 GARRY STREET	-	-	NO INFORMATION AVEAVAILABLE
223 GARRY STREET	-	-	NO INFORMATION AVEAVAILABLE
266 GRAHAM AVENUE	-	-	65.22 E OF MH @ COCKBURN
266 GRAHAM AVENUE	-	-	42.36 E OF MH @ COCKBURN
266 GRAHAM AVENUE	-	-	NO INFORMATION AVEAVAILABLE
266 GRAHAM AVENUE	-	-	27.13 E OF MH @ COCKBURN
266 GRAHAM AVENUE	-	-	19.50 E OF MH @ COCKBURN
250 ST MARY AVENUE	-	-	22.56 S OF MH @ ST. MARY AV
260 ST MARY AVENUE	-	-	NO INFORMATION AVEAVAILABLE
RESIDENTIAL	-	-	NO INFORMATION AVEAVAILABLE

SEWER JUNCTION INFORMATION *			
SEWER ID 3840			
DISTANCE FROM MH ID 3839			
7.40 S	150Ø	1	CN
11.30 S	150Ø	9	JN
14.60 S	250Ø	11	CN
18.10 S	150Ø	3	JN
22.00 S	150Ø	2	JN
28.00 S	150Ø	9	JN
30.30 S	150Ø	9	JN
30.80 S	200Ø	2	CN
31.50 S	150Ø	2	JN
32.20 S	150Ø	3	JN
37.10 S	150Ø	3	JN
45.00 S	150Ø	2	JN
51.80 S	200Ø	2	CN
52.80 S	150Ø	9	JN
60.40 S	200Ø	10	CN
68.50 S	200Ø	10	JN

* INFORMATION FROM SEWER VIDEO INSPECTION

NOTE: CHAINAGES SHOWN ARE ALONG
C OF GARRY ST.

GARRY STREET

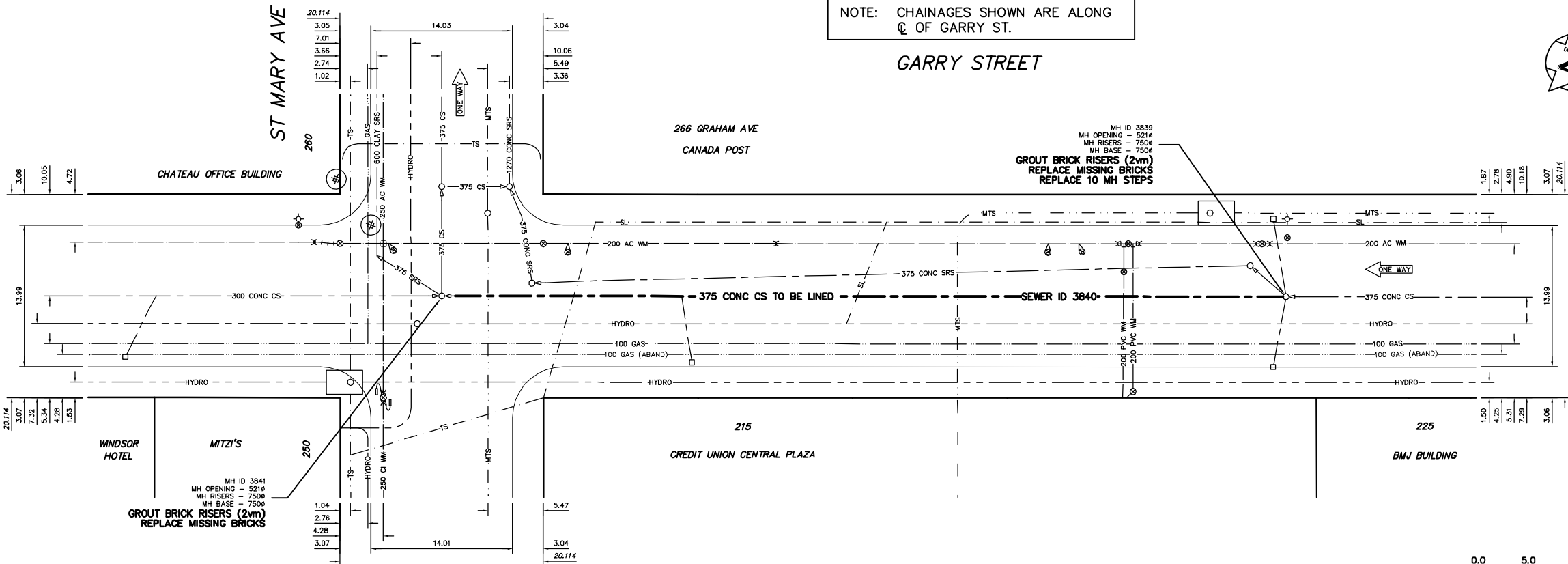

METRIC
WHOLE NUMBERS INDICATE MILLIMETRES
DECIMALIZED NUMBERS INDICATE METRES

WARNING
IF POWER EQUIPMENT OR EXPLOSIVES ARE TO BE USED FOR EXCAVATION ON THIS PROJECT THE CONTRACTOR MUST:
1) NOTIFY THE GAS COMPANY OF THE PROPOSED LOCATION OF EXCAVATION.
2) TAKE PRECAUTION TO AVEEOD DAMAGE TO GAS COMPANY INSTALLATIONS.
SEE PROVINCIAL REGULATION 210/72 FOR DETAILS

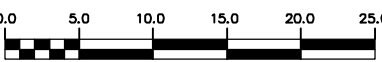

200 WM		200 WM		SL, HYDRO		150 WM		WATERMAIN		150 WM	
⊕	HYDRANT	⊕	HYDRANT	---	MTS	---	HYDRANT	⊕	HYDRANT	⊕	HYDRANT
⊙	VALVE	⊙	VALVE	---	TRAFFIC SIGNALS	---	VALVE	⊙	VALVE	⊙	VALVE
525 LDS	LAND DRAINAGE SEWER	525 LDS	50 GAS	---	GAS	---	50 GAS	525 LDS	LAND DRAINAGE SEWER	300 LDS	LAND DRAINAGE SEWER
375 WWS	WASTEWATER SEWER	375 WWS	300 WWS	---	SURVEY BAR	---	250 WWS	375 WWS	WASTEWATER SEWER	250 WWS	WASTEWATER SEWER
○	MANHOLE	○	FENCE	---	POLE - HYDRO, MTS	---	GROUND ABOVE PIPE	○	MANHOLE	○	MANHOLE
□	CATCH BASIN	□	CURB STOP	---	GUY ANCHOR	---	☞ DITCH (NORTH & WEST)	□	CATCH BASIN	□	CATCH BASIN
▽	CURB INLET	▽	GUY ANCHOR	---	LIGHT STANDARD	---	☞ DITCH (SOUTH & EAST)	▽	CURB INLET	▽	CURB INLET
—	JUNCTION	—	LIGHT STANDARD	---	TREE	---	☞ GUTTER (NORTH & WEST)	—	JUNCTION	—	JUNCTION
—	CULVERT	—	TREE	---	---	---	☞ GUTTER (SOUTH & EAST)	—	CULVERT	—	CULVERT
—	ANODE	—	---	---	---	---	---	—	ANODE	—	ANODE
EXISTING	LEGEND-PLAN	PROPOSED	EXISTING	LEGEND-PLAN	PROPOSED	EXISTING	LEGEND-PROFILE	PROPOSED	EXISTING	LEGEND-PROFILE	PROPOSED

LOCATION APPROVED
UNDERGROUND STRUCTURES

DATE: _____

NOTE:
LOCATION OF UNDERGROUND STRUCTURES AS SHOWN ARE BASED ON THE BEST INFORMATION AVAILABLE BUT NO GUARANTEE IS GIVEN THAT THE GIVEN LOCATIONS ARE EXACT. CONFIRMATION OF EXISTENCE AND EXACT LOCATION OF ALL SERVICES MUST BE OBTAINED FROM THE INDIVIDUAL UTILITIES BEFORE PROCEEDING WITH CONSTRUCTION.

B.M. ELEV.	FIELD BOOK #:
POSTED TO LBS	
NO. REVISIONS	DATE BY

CITY OF WINNIPEG
WATER AND WASTE
ENGINEERING DIVISION

DESIGNED BY: TW
DRAWN BY: C.J.H./BAW
HOR. SCALE: 1:250
VERTICAL: 1:50
DATE: 2005 06 29

CHECKED BY: KZ
APPROVED BY: KZ
RELEASED FOR CONSTRUCTION

ENGINEER'S SEAL
ORIGINAL SIGNED BY K.R. ZUREK
05/06/30

BID OPPORTUNITY: 385-2005
FILENAME: 05585_Garry.dwg
PLOT DATE: 2005 06 29

THE CITY OF WINNIPEG
WATER AND WASTE DEPARTMENT

2005 COMBINED SEWER RENEWALS
BY CIPP LINING
GARRY STREET
1st MH NORTH OF ST. MARY AVENUE
TO MH AT ST MARY AVENUE

SHEET 3 OF 7
CITY DRAWING NUMBER
05585