

1 TYPICAL SECTION - NEW PILES
S1/S2 SCALE: 1/2" = 1'-0"

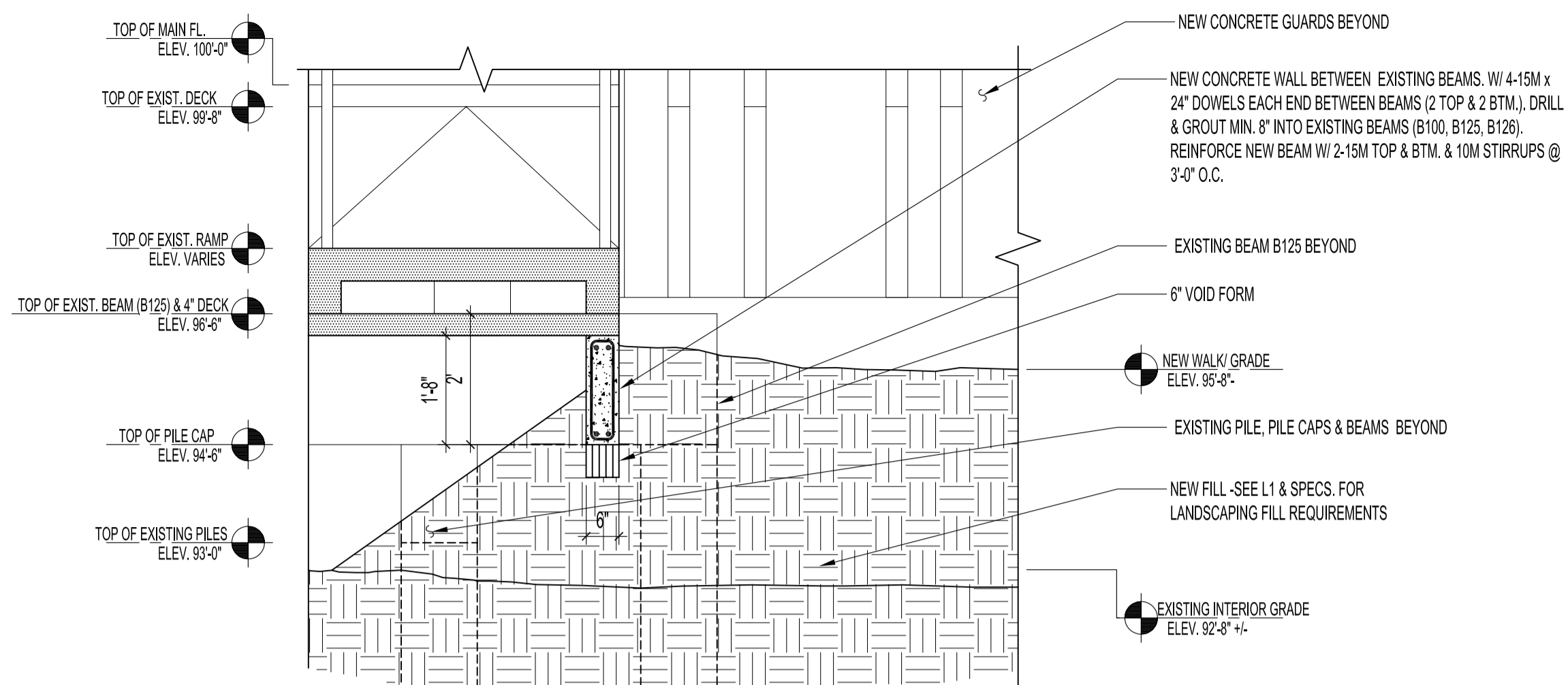

2 RAMP SECTION - NEW WALL
S1/S2 SCALE: 1/2" = 1'-0"

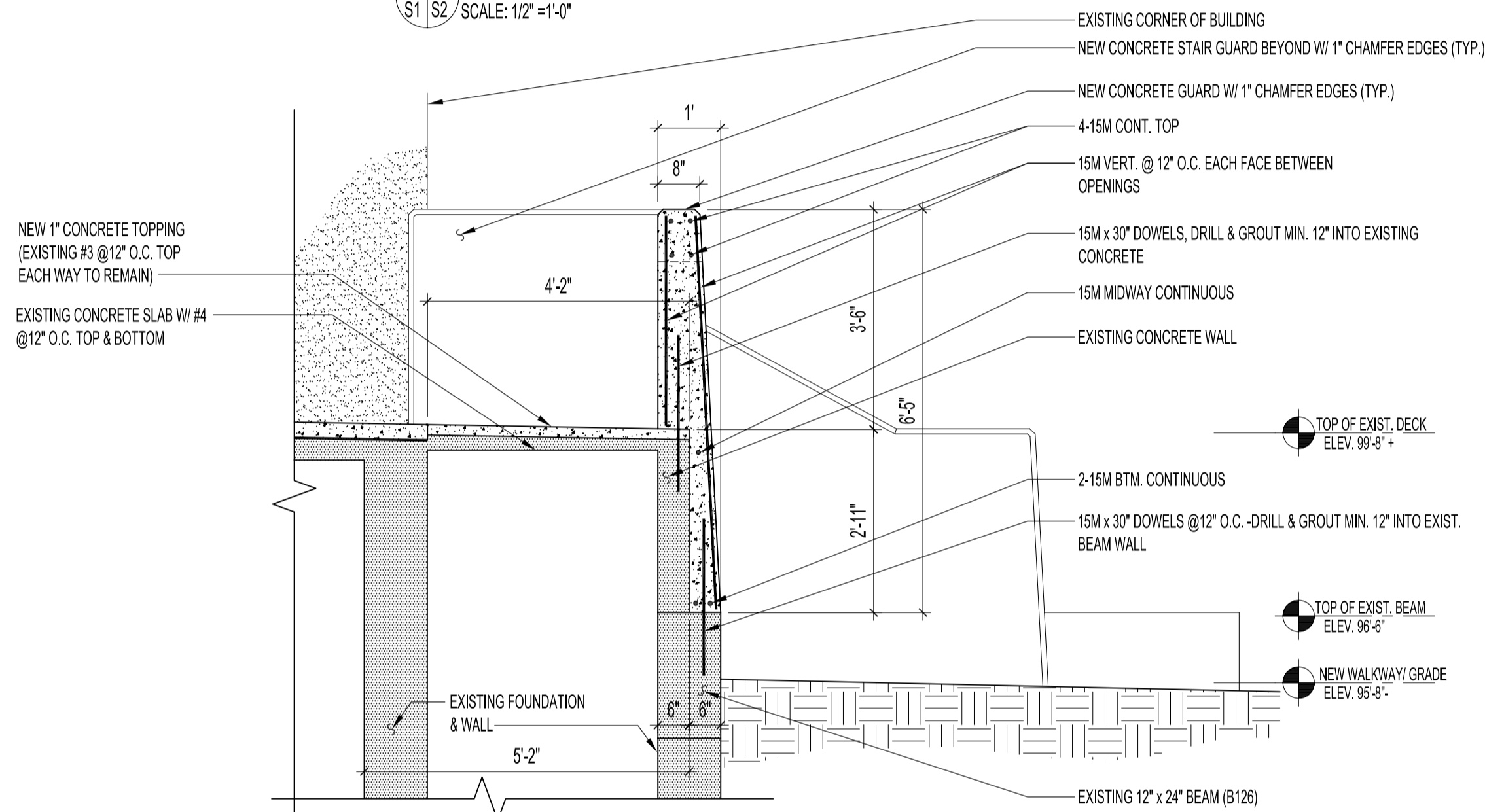

3 SECTION - NEW CONCRETE GUARDS
S1/S2 SCALE: 1/2" = 1'-0"

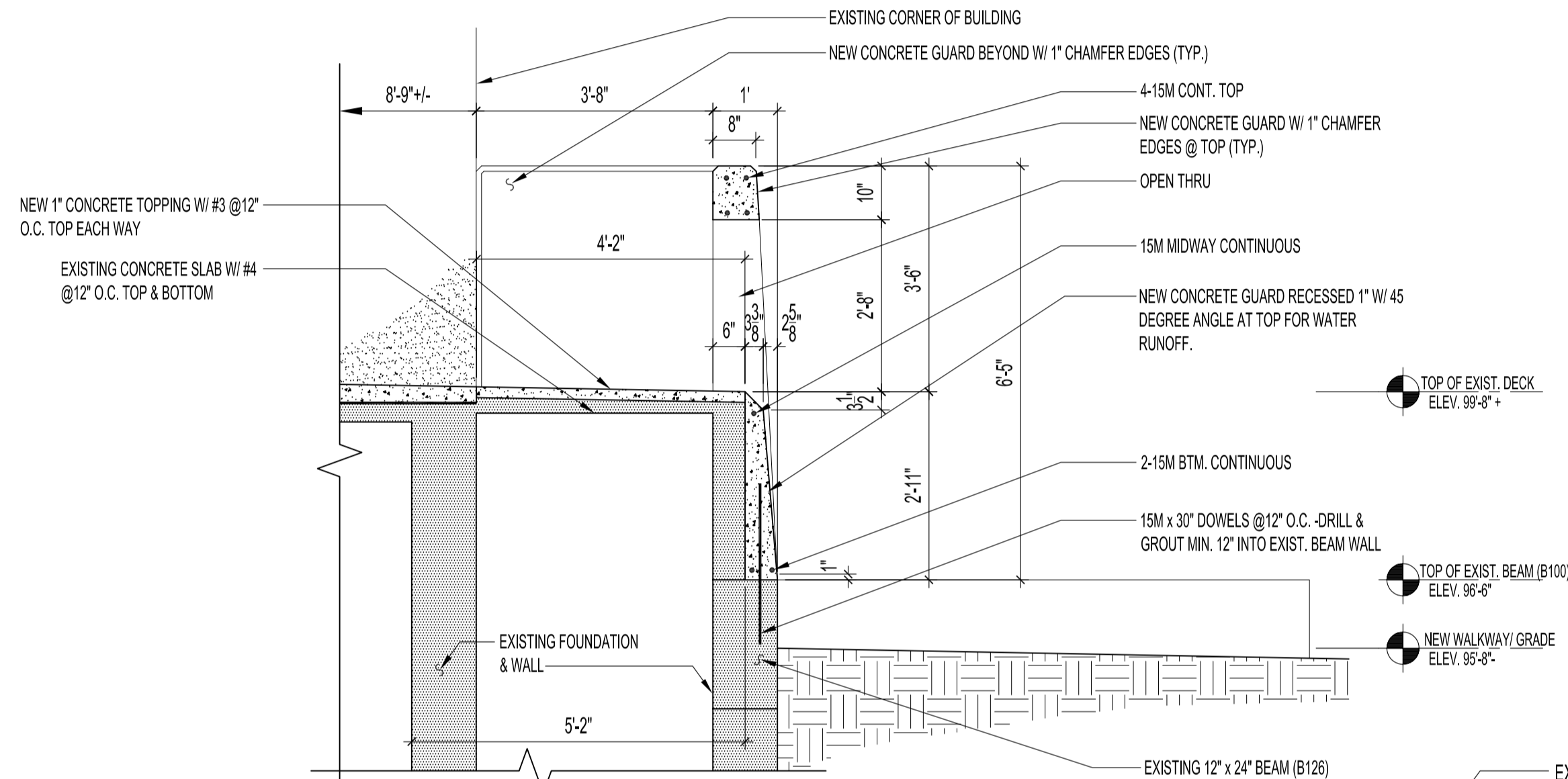

4 SECTION - NEW CONCRETE GUARDS @ OPENINGS
S1/S2 SCALE: 1/2" = 1'-0"

ORIGINAL SEALED BY:
B.T.M. Konzelman P. Eng.
Date: 2005.08.19

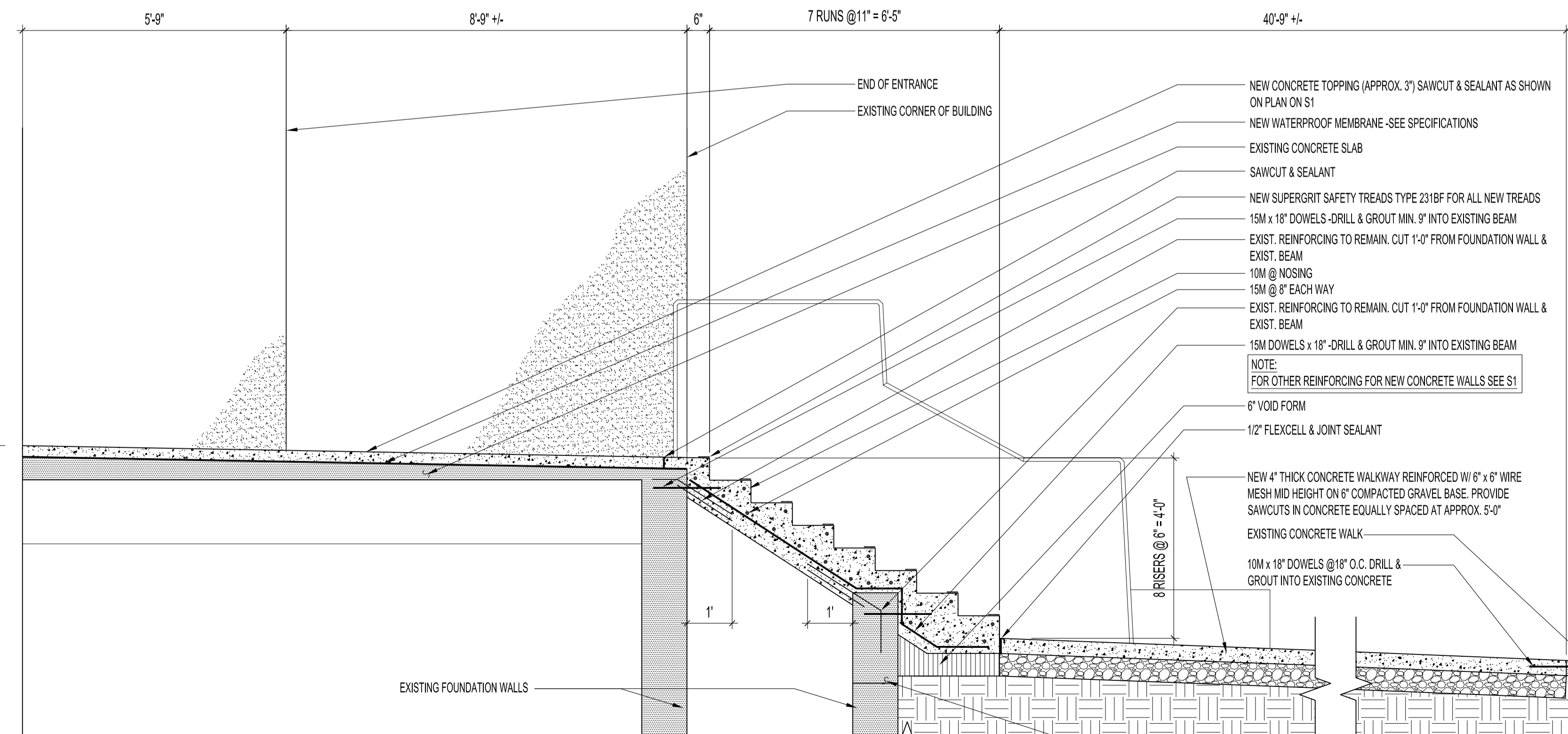

5 SECTION - NEW DECK TOPPING, STAIR & WALKWAY
S1/S2 SCALE: 1/2" = 1'-0"

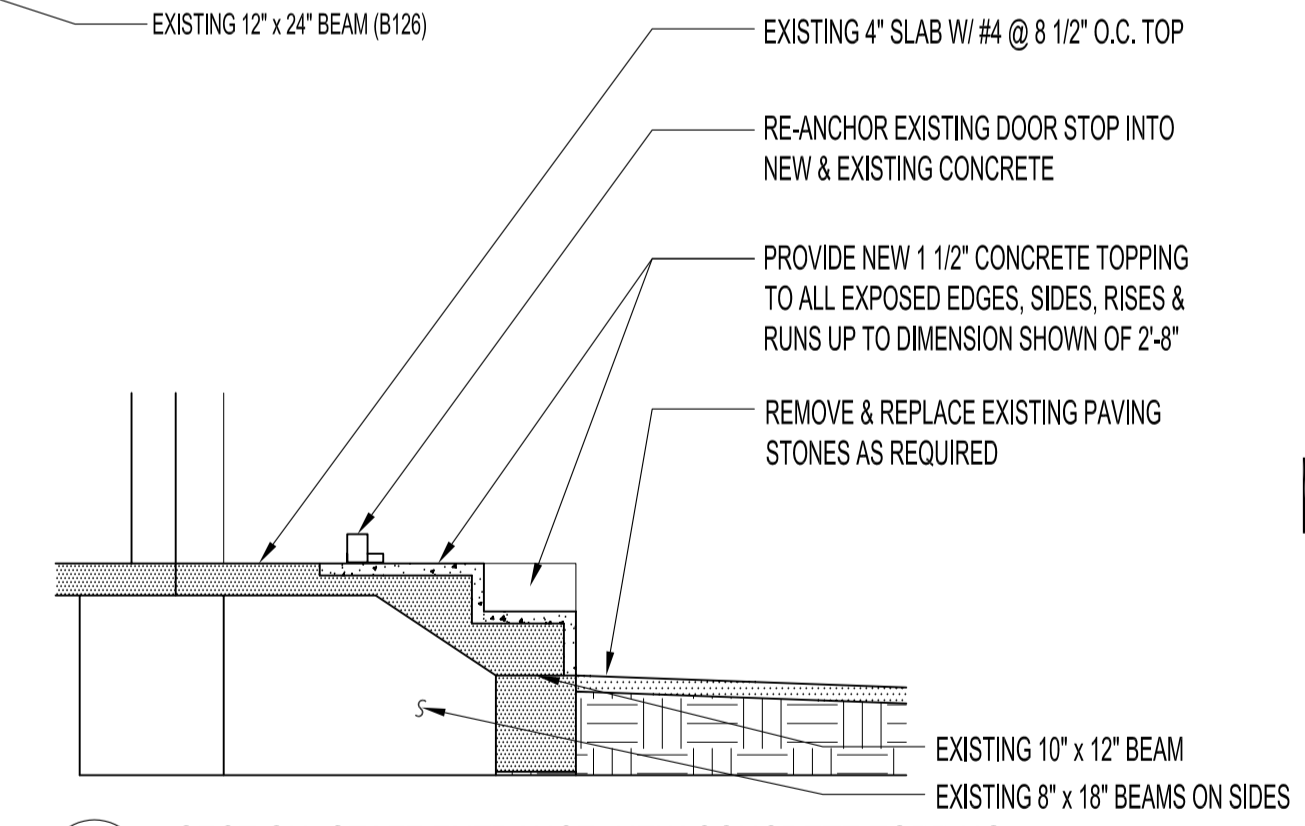

6 SECTION - STAFF ENTRANCE - NEW CONCRETE TOPPING
S1/S2 SCALE: 1/2" = 1'-0"

EXISTING BEAM SCHEDULE	
B100	12" 2 #5 TOP
	2 #4 MIDDLE EACH FACE
	2 #6 BOTTOM
42"	#3 STIRRUPS @ 12" O.C.
	#3 BOTTOM
B125	24" 2 #11 SPACING 1 @ 3', 2 @ 6', 1 @ 9', REMAINDER @ 12" O.C. B.E.
	#3 BOTTOM
B126	12" 2 #10 SPACING 1 @ 3', 2 @ 6', 1 @ 9', REMAINDER @ 12" O.C. B.E.
	24" #3

NO.	REVISION/DESCRIPTION	BY	DATE
SEALS			

DRAWN BY: MMK CHECKED BY: USER APPROVAL
DATE: 2005.08.19

CITY OF WINNIPEG
PLANNING, PROPERTY &
DEVELOPMENT DEPARTMENT
CIVIC ACCOMMODATIONS DIVISION
300 - 65 GARRY ST. R3C 4K4

PROJECT
DISTRICT 5 POLICE STATION
CONCRETE ENTRANCE DECK UPGRADE
(FRONT & REAR)

227 PROVENCHEUR BOULEVARD

SHEET TITLE

STRUCTURAL
SECTIONS

SCALE	PROJECT NO.	SHEET NO.
AS SHOWN	2002-136	S2