

HOUSE No.	SIZE	JUNCTION LOCATION	PL INV	LOCATION AT PROPERTY LINE	COMMENTS
No. 773	-	79.6 W OF 1ST MH W OF COCKBURN	-	12.9 WEL	Wyed service with 777 *
No. 777	150	SMS - 13.0 W OF 2ND MH E OF ARGUE	-	-	-
No. 779	-	20.7 W OF 2ND MH W OF COCKBURN	-	8.5 WEL	-
No. 781	-	21.2 W OF 2ND MH W OF COCKBURN	-	6.1 EWL	-
No. 785	-	35.9 W OF 2ND MH W OF COCKBURN	-	4.1 EWL	-
No. 789	-	42.9 W OF 2ND MH W OF COCKBURN	-	3.5 WEL	-
No. 790	-	-	-	-	-
No. 793	-	58.2 W OF 2ND MH W OF COCKBURN	-	5.9 EWL	-
No. 797	-	73.8 W OF 2ND MH W OF COCKBURN	-	8.2 WEL	-
No. 801	-	81.4 W OF 2ND MH W OF COCKBURN	-	9.8 EWL	-

* TO BE DETERMINED IN FIELD IF SERVICES CAN BE SEPARATED

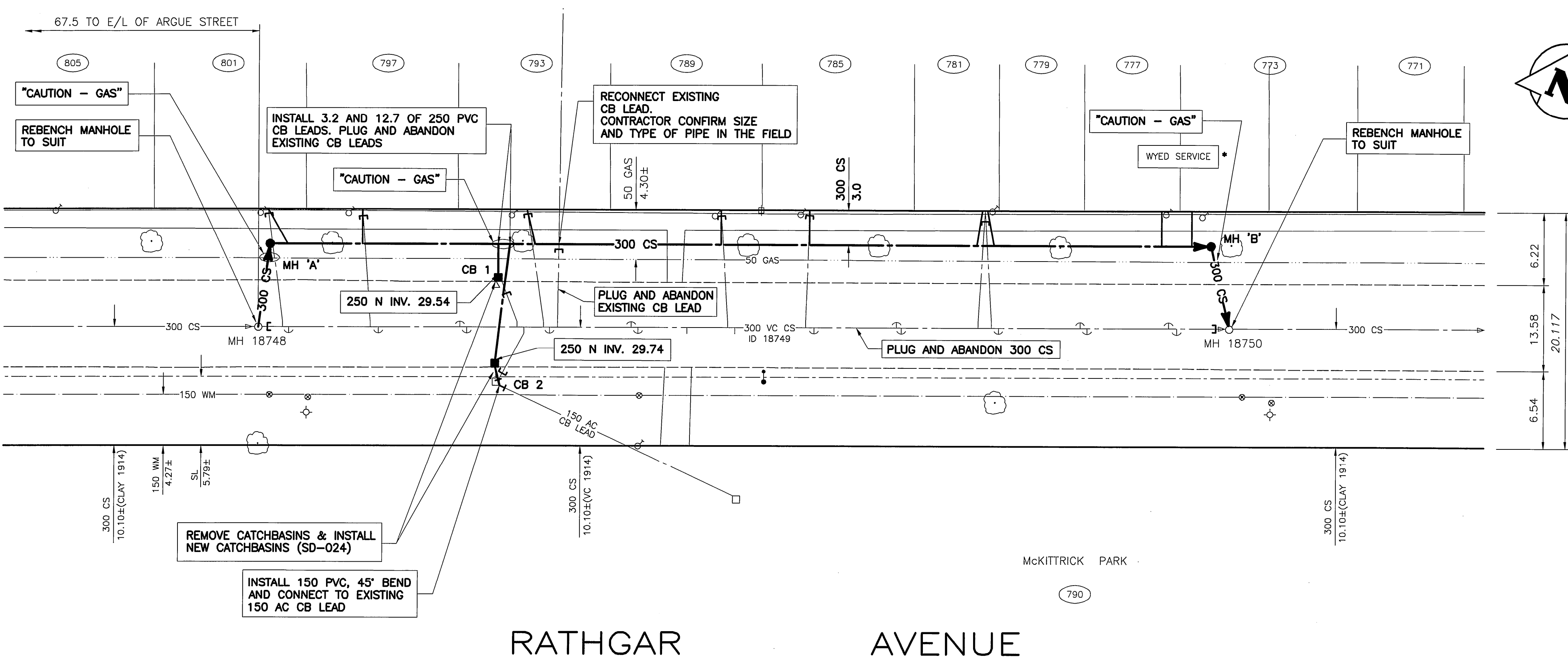

MANHOLE INFORMATION		
MANHOLE NUMBER	MANHOLE TYPE	WORK REQUIRED
18748	PRECAST	GROUT TOP 1m
18750	PRECAST	REPLACE TOP 1.0 RISER WITH RUNGS

CATCHBASIN INFORMATION	
CATCHBASIN NUMBER	WORK REQUIRED
CB 1	REMOVE AND REPLACE
CB 2	REMOVE AND REPLACE, RECONNECT AC CB LEAD

- GENERAL NOTES:**
- CHAINAGE IS ALONG NORTH PROPERTY LINE OF RATHGAR AVENUE.
- CONSTRUCTION NOTES:**
- ALL BACKFILL IN BOULEVARDS TO BE CLASS 5.
 - ALL BACKFILL IN PAVEMENT TO BE CLASS 3.
 - INSTALL SEWER USING TRENCHLESS METHODS.
 - INSTALL NEW SEWER SERVICES TO PROPERTY LINE.
 - ALL CATCHBASIN LEADS ARE 250 PVC AT A MINIMUM 1.0% UNLESS OTHERWISE NOTED.
 - CONFIRM LOCATION OF ALL SEWER SERVICES WITHIN RENEWAL LIMITS.

APEGM
 Certificate of Authorization
 Wardrop Engineering Inc.
 No. 195 Expiry: April 30, 2006

EXISTING	LEGEND-PLAN	PROPOSED	EXISTING	LEGEND-PLAN	PROPOSED	EXISTING	LEGEND-PLAN	PROPOSED
150 WM	WATERMAIN	150 WM	BEND			ANCHOR		
400 FM	FEEDERMAIN	400 FM	TEE			TREE		
300 LDS	LAND DRAINAGE SEWER	300 LDS	CURB STOP			LEGAL DIMENSION		
250 WWS	WASTEWATER SEWER	250 WWS	PLUG			SURVEY BAR		
300 CS	COMBINED SEWER	300 CS	MANHOLE			TRAFFIC SIGNAL		
200 FCM	FORCEMAIN	200 FCM	CATCHBASIN			GAS		
	JUNCTIONS		CURB INLET			HYDRO		
	HYDRANT		ADDRESS			MTS		
	VALVE		HYDRO POLE			SIDEWALK		
	REDUCER		LIGHT STANDARD			CURB		

LOCATION APPROVED UNDERGROUND STRUCTURES

SUPV. U/G STRUCTURES DATE COMMITTEE

NOTE: LOCATION OF UNDERGROUND STRUCTURES AS SHOWN ARE BASED ON THE BEST INFORMATION AVAILABLE. BUT NO GUARANTEE IS GIVEN THAT ALL EXISTING UTILITIES ARE SHOWN OR THAT THE GIVEN LOCATIONS ARE EXACT. CONFIRMATION OF EXISTENCE AND EXACT LOCATION OF ALL SERVICES MUST BE OBTAINED FROM THE INDIVIDUAL UTILITIES BEFORE PROCEEDING WITH CONSTRUCTION.

NO.	REVISIONS	DATE	BY
-	ISSUED FOR TENDER	05.10.27	LC
-	REVISED AS PER CITY COMMENTS	05.09.30	GS
-	ISSUED FOR APPROVAL	05.08.15	GS

WARDROP Engineering Inc.

DESIGNED BY: GWC
 CHECKED BY: [Signature]
 DRAWN BY: NL
 APPROVED BY: [Signature]
 HOR. SCALE: 1 : 250
 VERTICAL: 1 : 50
 DATE: 05.05.20

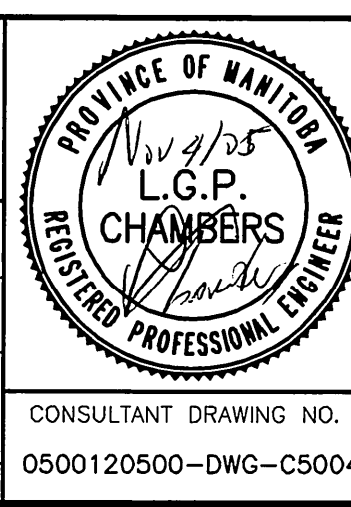

THE CITY OF WINNIPEG
 WATER AND WASTE DEPARTMENT

2005 COMBINED SEWER RENEWALS AND SEWER REPAIRS - CONTRACT No. 16

RATHGAR AVENUE
 1st MH EAST OF ARGUE ST TO
 2nd MH EAST OF ARGUE ST

CITY DRAWING NUMBER: 05636
 SHEET: 4 OF 11
 C5004

CONSULTANT DRAWING NO. 0500120500-DWG-C5004