

LOCATION PLAN
N.T.S.

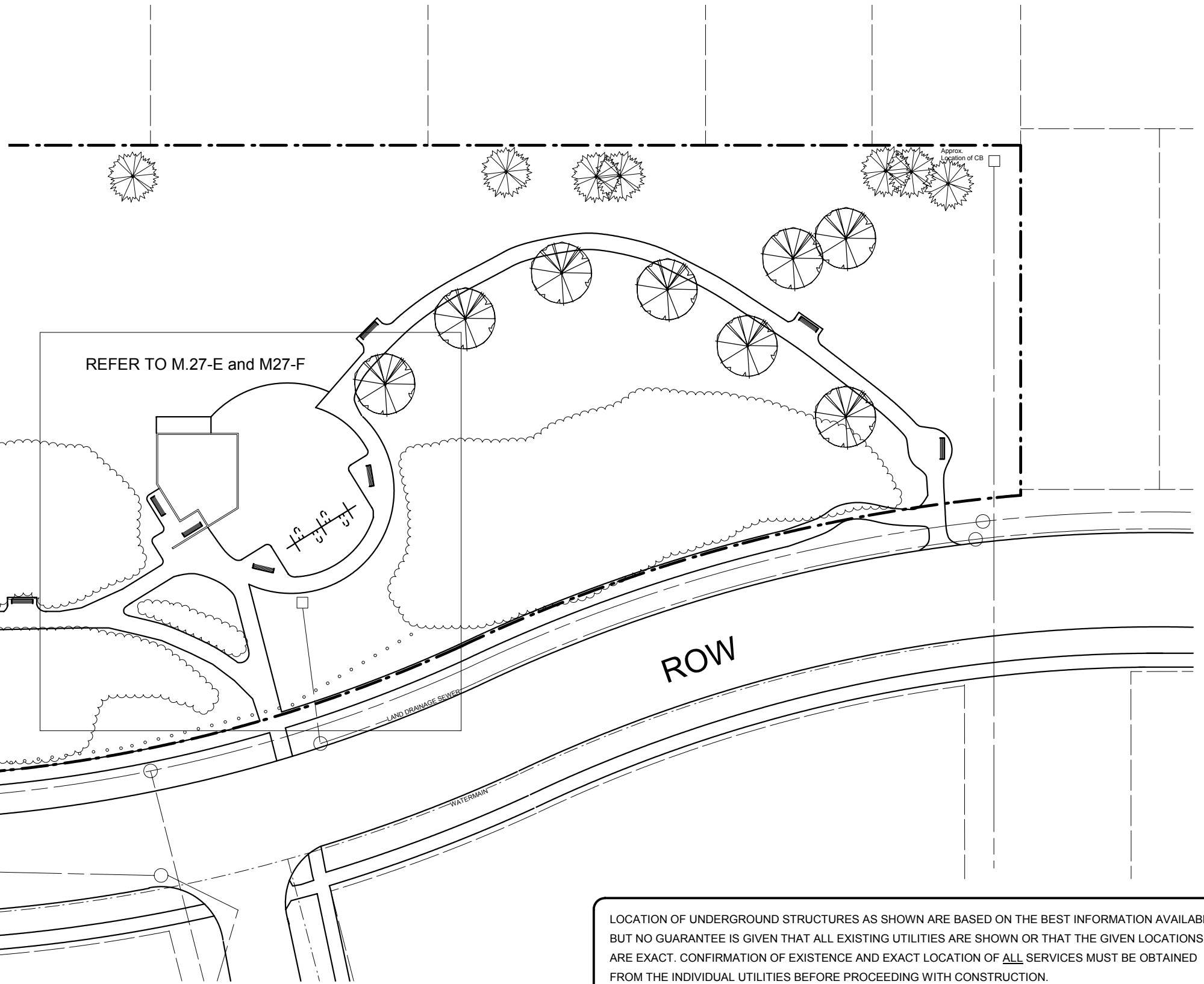

LOCATION OF UNDERGROUND STRUCTURES AS SHOWN ARE BASED ON THE BEST INFORMATION AVAILABLE BUT NO GUARANTEE IS GIVEN THAT ALL EXISTING UTILITIES ARE SHOWN OR THAT THE GIVEN LOCATIONS ARE EXACT. CONFIRMATION OF EXISTENCE AND EXACT LOCATION OF ALL SERVICES MUST BE OBTAINED FROM THE INDIVIDUAL UTILITIES BEFORE PROCEEDING WITH CONSTRUCTION.



THE CITY OF WINNIPEG
Planning, Property and Development Department
Planning and Land Use Division
Unit 15 - 30 Fort Street, Winnipeg, MB, (R3C 4X5)

DESIGNED BY	SF/BB	CHECKED BY	APPROVED BY
DRAWN BY	ST	RELEASED FOR CONSTRUCTION	
HORIZ. SCALE	1 : 500		
VERT. SCALE			
DATE	JULY/05	MANAGER, PLANNING AND LAND USE DIVISION	DATE

DRAWING TITLE
**MILDRED PARK
Site Plan**

CAD DRAWING NO.
DRAWING NO.
M-27.D