

NOTES:

1. CONTRACTOR TO VERIFY LIMITS OF SEWER REPAIRS PRIOR TO EXCAVATION BY MEANS OF VIDEO INSPECTION.

2. CONTRACTOR TO PROVIDE VIDEO INSPECTION OF SEWER SERVICES WITHIN LIMITS OF REPAIR OR RENEWAL IN PRESENCE OF CONTRACT ADMINISTRATOR TO DETERMINE IF SERVICE RENEWAL IS REQUIRED.

SEWER SERVICE INFORMATION

ADDRESS	SIZE	R DIST JUNCTION TIE
1050 WELLINGTON CR RESIDENTIAL	-	SERVICED FROM ASH

**SEWER JUNCTION INFORMATION
WITHIN PROPOSED SEWER REPAIR**

DISTANCE FROM 1st MH (ID #589) W OF OAK			
39.9	W	-	EAST UNKNOWN LOCATION

INFORMATION FROM SEWER VIDEO INSPECTION

WELLINGTON CRESENT

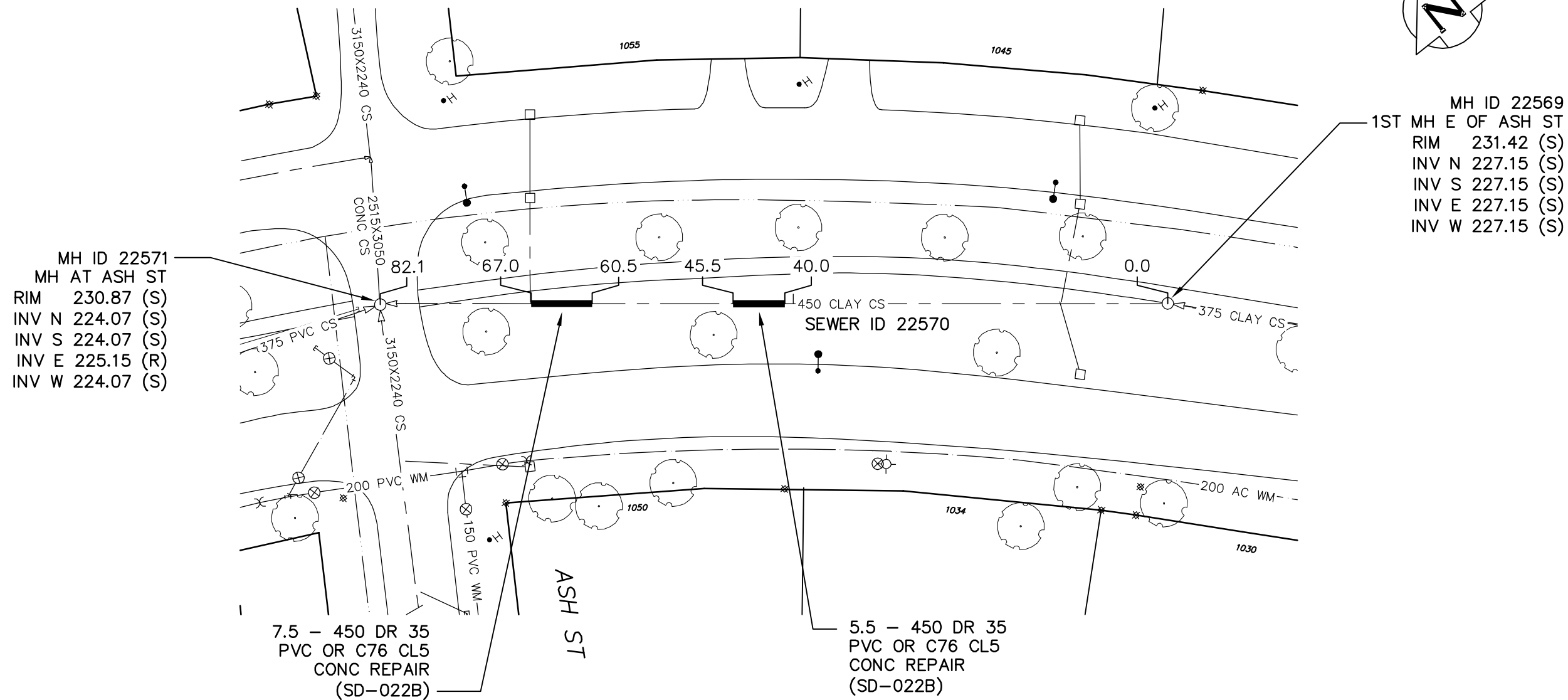

MH ID 22571
MH AT ASH ST
RIM 230.87 (S)
INV N 224.07 (S)
INV S 224.07 (S)
INV E 225.15 (R)
INV W 224.07 (S)

MH ID 22569
1ST MH E OF ASH ST
RIM 231.42 (S)
INV N 227.15 (S)
INV S 227.15 (S)
INV E 227.15 (S)
INV W 227.15 (S)

ENGINEER'S SEAL

ORIGINAL SIGNED
BY
S.R.J. COURNOYER
05/10/14

BID OPPORTUNITY No: 577-2005
FILENAME : 05666A_Wellington.dwg
PLOT DATE : 2005 10 14

LEGEND:

52.0 | MEASUREMENT TO REPAIR FROM REFERENCE MH SHOWN THUS... 0.0

METRIC

WHOLE NUMBERS INDICATE MILLIMETRES
DECIMALIZED NUMBERS INDICATE METRES

B.M. ELEV.	FIELD BOOK #	CITY OF WINNIPEG WATER AND WASTE ENGINEERING DIVISION		THE CITY OF WINNIPEG WATER AND WASTE DEPARTMENT	
POSTED TO LBIS		DESIGNED BY SC	CHECKED BY TW	2005 COMBINED SEWER RENEWALS AND SEWER REPAIRS	
		DRAWN BY PB	APPROVED BY TW	WELLINGTON CRESCENT (CL)	
		HOR. SCALE 1:500	RELEASED FOR CONSTRUCTION	1ST MH W OF OAK STREET TO MH AT ASH STREET	
		VERTICAL	DATE 2005 10 14	SHEET 15 OF 15	
NO. REVISIONS	DATE BY			CITY DRAWING NUMBER 05666A	