

- NOTES:**
- CONTRACTOR TO VERIFY LIMITS OF SEWER REPAIRS PRIOR TO EXCAVATION BY MEANS OF VIDEO INSPECTION.
 - CONTRACTOR TO PROVIDE VIDEO INSPECTION OF SEWER SERVICES WITHIN LIMITS OF REPAIR OR RENEWAL IN PRESENCE OF CONTRACT ADMINISTRATOR TO DETERMINE IF SERVICE RENEWAL IS REQUIRED.

SEWER SERVICE INFORMATION		
ADDRESS	SIZE	R DIST JUNCTION TIE
484 WAVERLEY ST RESIDENTIAL		- 93.4 N MH AT CORYDON
487 WAVERLEY ST RESIDENTIAL		- 89.1 N 1MH AT CORYDON

SEWER JUNCTION INFORMATION WITHIN PROPOSED SEWER REPAIR			
DISTANCE FROM MH (ID #589) AT CORYDON			
94.3	N	-	EAST UNKNOWN LOCATION

INFORMATION FROM SEWER VIDEO INSPECTION

WAVERLEY STREET

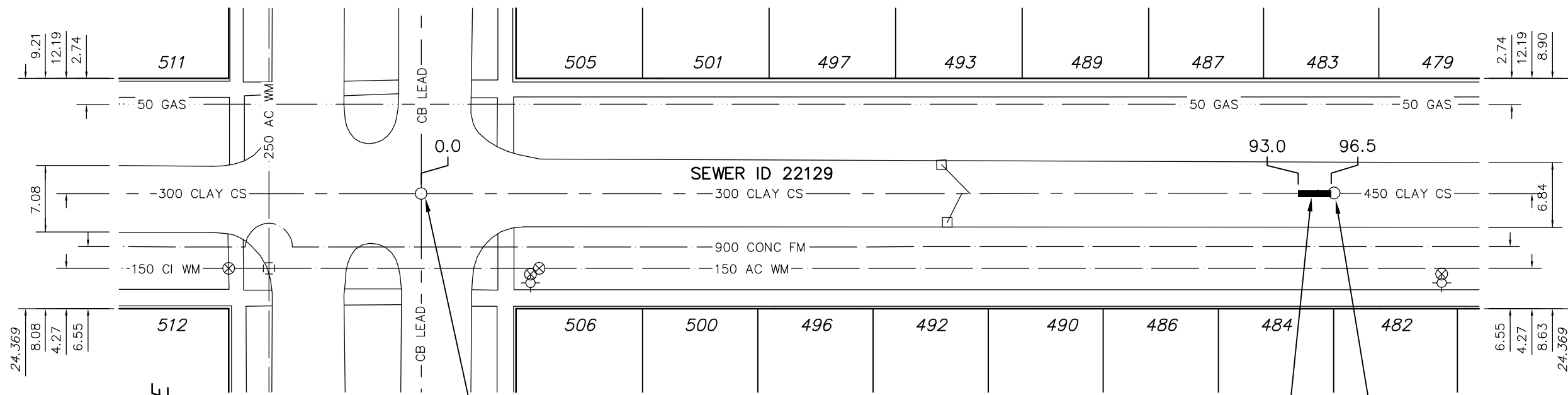

MH ID 21912
MH AT CORYDON
RIM 232.79 (S)
INV N 229.48 (S)
INV S 229.48 (S)
INV E 229.48 (S)
INV W 229.48 (S)

MH ID 22130
1ST MH N OF CORYDON
RIM 232.68 (S)
INV N 228.83 (S)
INV S 228.83 (S)

ENGINEER'S SEAL

ORIGINAL SIGNED
BY
S.R.J. COURNOYER
05/10/14

BID OPPORTUNITY No: 577-2005
FILENAME : 05666_Waverly.dwg
PLOT DATE : 2005 10 14

LEGEND:

52.0 | MEASUREMENT TO REPAIR FROM REFERENCE MH SHOWN THUS... 0.0

METRIC
WHOLE NUMBERS INDICATE MILLIMETRES
DECIMALIZED NUMBERS INDICATE METRES

B.M. ELEV.	FIELD BOOK #:	CITY OF WINNIPEG WATER AND WASTE ENGINEERING DIVISION	THE CITY OF WINNIPEG WATER AND WASTE DEPARTMENT
POSTED TO LBIS			
DESIGNED BY	SC	CHECKED BY	TW
DRAWN BY	PB	APPROVED BY	TW
HOR. SCALE	1:500	RELEASED FOR CONSTRUCTION	
VERTICAL			
NO. REVISIONS	DATE	BY	DATE
			2005 10 14

2005 COMBINED SEWER RENEWALS
AND SEWER REPAIRS
WAVERLEY STREET
MH AT CORYDON AVENUE TO
1ST MH N OF CORYDON AVENUE

SHEET **14** OF **15**
CITY DRAWING NUMBER
05666