

ROOF PLAN  
1:100

- NOTES:**
- DESIGN SNOW LOAD ON DOUBLE TEES IS 1.56 kPa.
  - SUPERIMPOSED DEAD LOAD IS 1.0 kPa.
  - PARAPET WALLS TO BE PROVIDED IN SEPARATE CONTRACT ALONG ALL EXTERIOR WALLS AND ALONG ALL EXPANSION JOINTS. FOR DOWEL DETAIL SEE .
  - CONNECTIONS BETWEEN TEES TO BE SPACED BY PRECAST SUPPLIER AS PER LOADS. SEE .
  - CAST-IN PLACE ANGLE IN UPSTAND BEAM DESIGNED AND SUPPLIED BY PRECAST SUPPLIER, AND INSTALLED BY GENERAL CONTRACTOR, SEE .
  - NOTE THAT MAY BE USED TO SUPPORT LIGHT FIXTURES INSTALLED UNDER SEPARATE CONTRACT. COORDINATE NUMBER AND LOCATION.
  - PROVIDE 20mm  $\phi$  SLEEVES IN ALL DOUBLE TEE STEMS  $\frac{1}{2}$   $\phi$  c/c.
  - REFER TO "GENERAL NOTES" ON DRAWING WM-S9002 FOR OPENINGS AND BLOCK OUTS NOT IDENTIFIED ON THIS DRAWING.

**REBAR LEGEND:**  
 TOP BARS  
 BOTTOM BARS

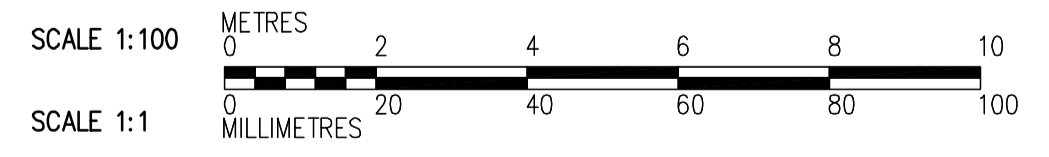
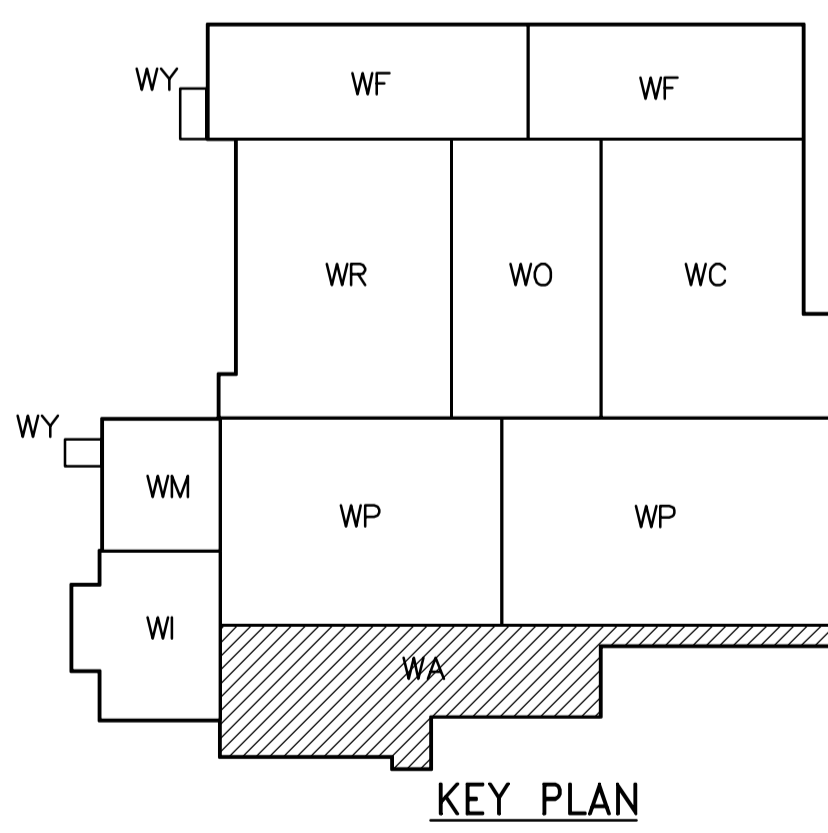

 Certificate of Authorization CH2M HILL Canada Ltd. No. 1441 Expiry: April 30, 2006	 Frederickson Cooper ARCHITECTS		 A Tyco International Ltd. Company		ENGINEER'S SEAL  ORIGINAL SIGNED BY D. KRUGER 2006/02/06	 THE CITY OF WINNIPEG WATER AND WASTE DEPARTMENT ENGINEERING DIVISION  WATER TREATMENT PLANT ADMINISTRATION FOUNDATIONS AND CONCRETE STRUCTURES  STRUCTURAL ADMINISTRATION AREA ROOF PLAN	CITY FILE NUMBER
	DESIGNED BY MC CHECKED BY AP		DRAWN BY RL APPROVED BY DJT		CONSULTANT DRAWING NO. WA-S0146		SHEET OF
	SCALE: 1:100 RELEASED FOR CONSTRUCTION BY: R. SOROKOWSKI		DATE 2005/07/04 DATE 2006/02/08		CITY DRAWING NUMBER 1-0601A-A-00146-001-0D		
	B.M. ELEV.						