

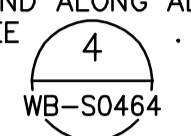

ROOF PLAN
1:100

NOTES:

1. DESIGN SNOW LOAD AS NOTED.
2. SUPERIMPOSED DEAD LOAD IS 1.0 kPa.
3. PARAPET WALLS TO BE PROVIDED IN SEPARATE CONTRACT ALONG ALL EXTERIOR WALLS AND ALONG ALL EXPANSION JOINTS. FOR DOWEL DETAIL SEE 
4. CONNECTIONS BETWEEN TEES TO BE SPACED BY PRECAST SUPPLIER AS PER LOADS. SEE 
5. CAST-IN PLACE ANGLE IN UPSTAND BEAM DESIGNED AND SUPPLIED BY PRECAST SUPPLIER, AND INSTALLED BY GENERAL CONTRACTOR, SEE 
6. NOTE THAT  MAY BE USED TO SUPPORT LIGHT FIXTURES INSTALLED UNDER SEPARATE CONTRACT. COORDINATE NUMBER AND LOCATION.
7. PROVIDE 20mm ϕ SLEEVES IN ALL DOUBLE TEE STEMS 1200mm C/C.
8. REFER TO "GENERAL NOTES" ON DRAWING WM-S9002 FOR OPENINGS AND BLOCK OUTS NOT IDENTIFIED ON THIS DRAWING.

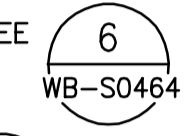
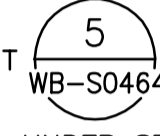
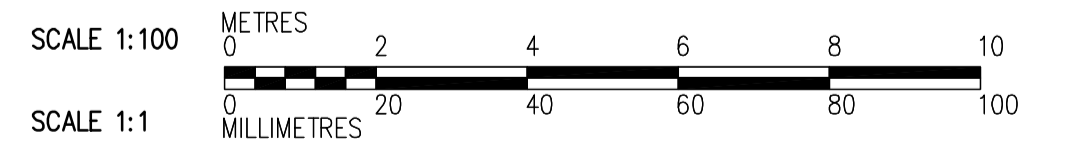
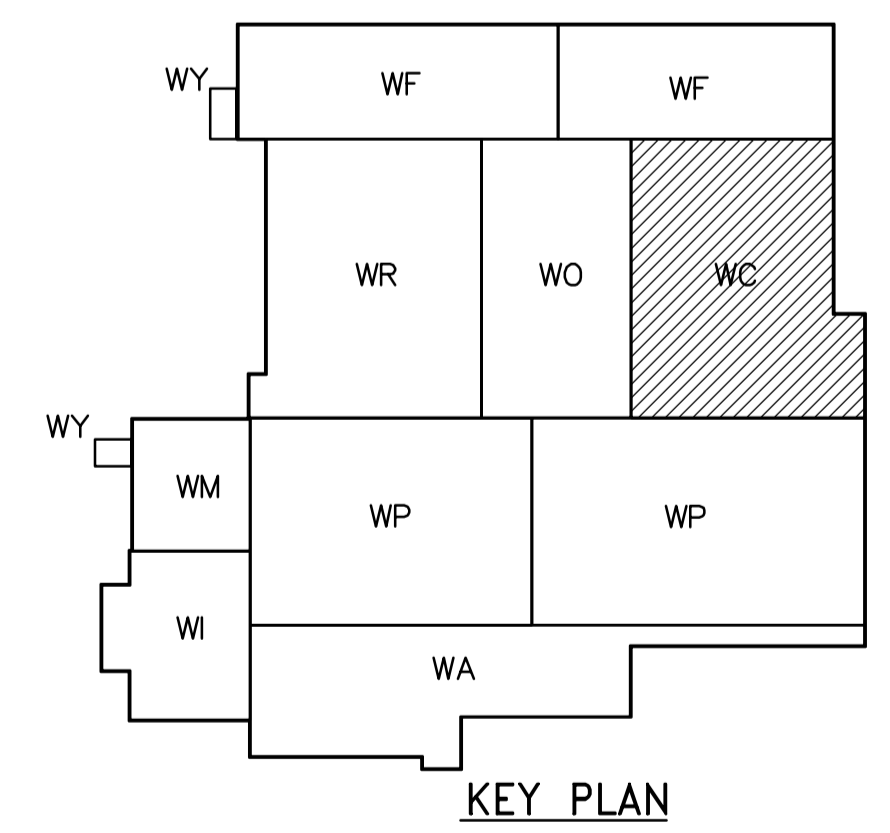

APECA
Certificate of Authorization
CH2M HILL Canada Ltd.
No. 1441 Expiry: April 30, 2006

NO.	REVISIONS	DATE	BY
01	583-2005 ADDENDUM 3	06/03/10	DK
00	ISSUED FOR TENDER	2006/02/03	DK

DESIGNED BY	DK	CHECKED BY	AP
DRAWN BY	PM	APPROVED BY	DJT
SCALE:	1:100	RELEASED FOR CONSTRUCTION BY:	R. SOROKOWSKI
DATE	2005/08/28	DATE	2006/02/08

ENGINEER'S SEAL
ORIGINAL SIGNED BY
D. KRUGER
2006/02/06
CONSULTANT DRAWING NO.
WC-S0146

THE CITY OF WINNIPEG
WATER AND WASTE DEPARTMENT
ENGINEERING DIVISION

WATER TREATMENT PLANT
CHEMICAL FEED SYSTEMS
FOUNDATIONS AND CONCRETE STRUCTURES

STRUCTURAL
CHEMICAL AREA
ROOF PLAN

CITY FILE NUMBER
SHEET OF
CITY DRAWING NUMBER
1-0601C-A-8046-001-0D