

- NOTES:**
- FOR BEAM AND COLUMN SCHEDULE SEE DWG. WF-S0515
  - PARAPET WALL TO BE PROVIDED AT ALL EXTERIOR WALLS AND ALONG ALL EXPANSION JOINTS. FOR DETAIL SEE

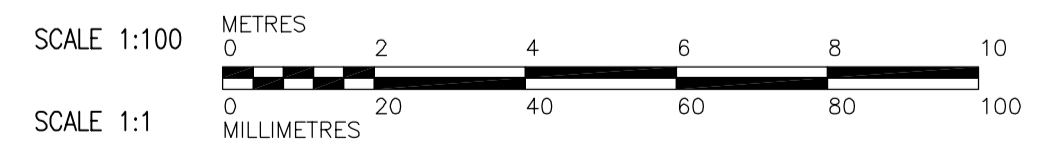
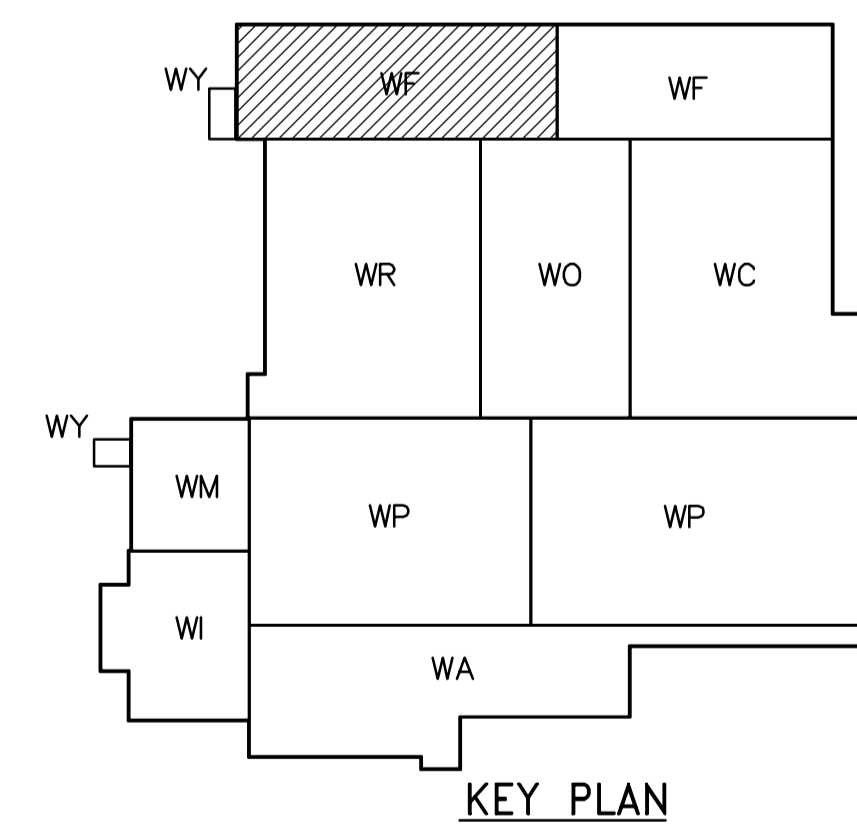

<p><b>Certificate of Authorization</b> CH2M HILL Canada Ltd. No. 1441 Expiry: April 30, 2006</p>	<p>Frederickson Cooper ARCHITECTS</p>	<p>A Geo International Ltd. Company</p>	ENGINEER'S SEAL ORIGINAL SIGNED BY D. KRUGER 2006/02/06	<p><b>THE CITY OF WINNIPEG</b> WATER AND WASTE DEPARTMENT ENGINEERING DIVISION</p>
			DESIGNED BY: KA CHECKED BY: AP DRAWN BY: PM APPROVED BY: DJT SCALE: 1:100 RELEASED FOR CONSTRUCTION BY: R. SOROKOWSKI	
B.M. ELEV.			CONSULTANT DRAWING NO. WF-S0141	CITY FILE NUMBER SHEET OF CITY DRAWING NUMBER 1-060F-A-30141-001-00D
00 ISSUED FOR TENDER 2006/02/03 KA		DATE 2005/08/10	DATE 2006/02/08	