

D SIZE 22" x 34" (559mm x 864mm)

PLOT: 05/11/01 11:00:35 AM

UMA FILE NAME: D265-177-02 02-C-1014.FX.dwg Saved By: aleippi

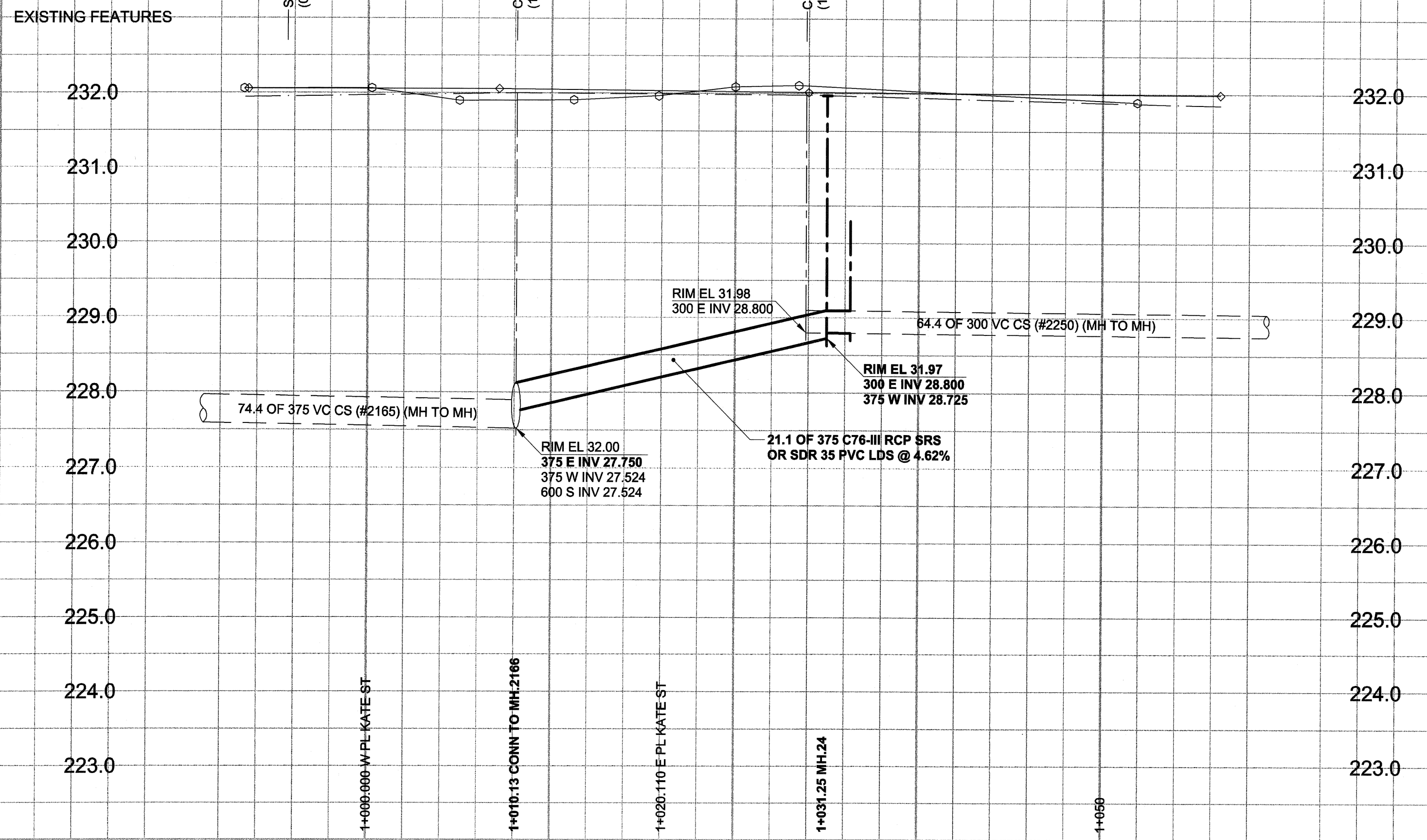

CHAINAGE ALONG S PL

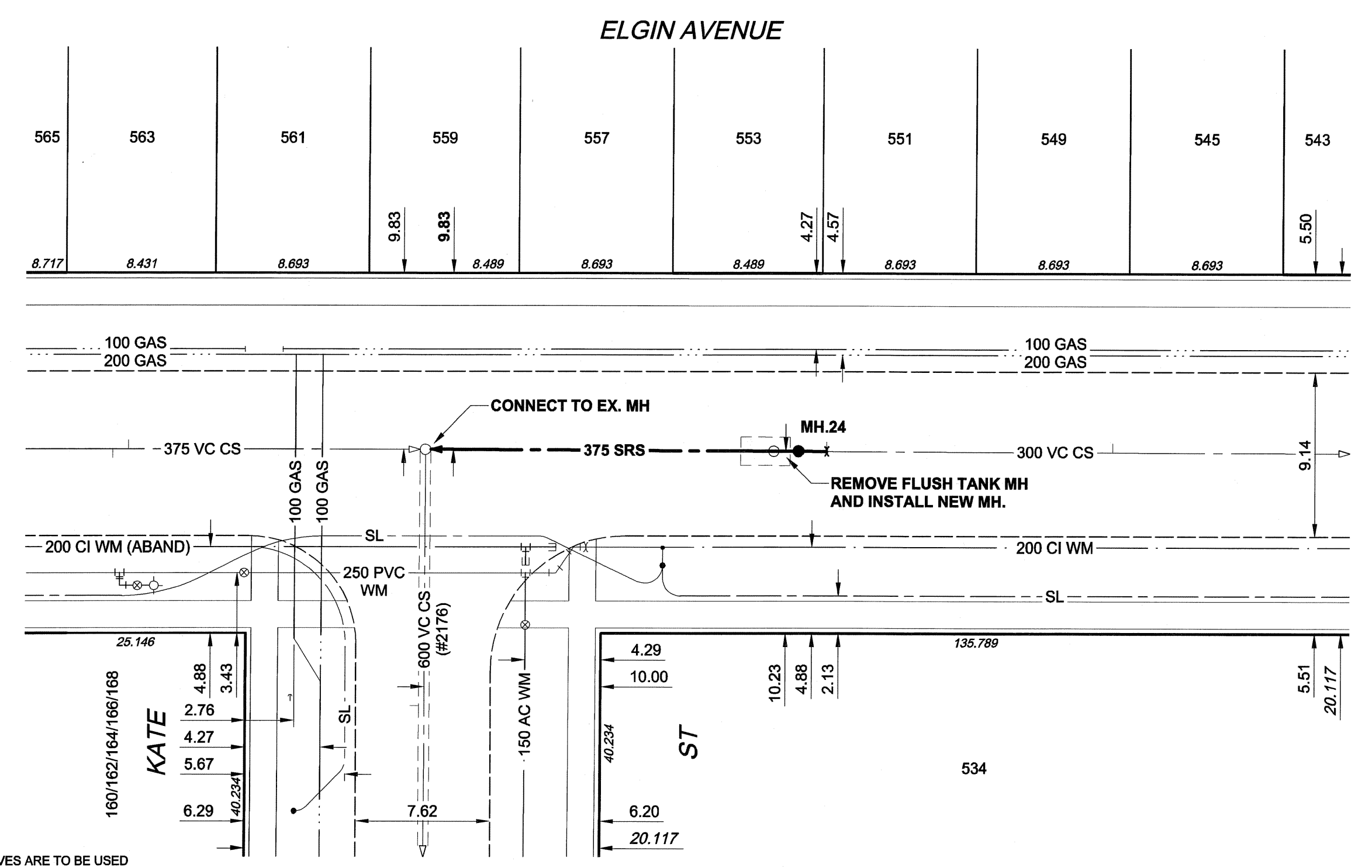

WARNING
IF POWER EQUIPMENT OR EXPLOSIVES ARE TO BE USED FOR EXCAVATION ON THIS PROJECT, THE CONTRACTOR MUST:
1) NOTIFY THE GAS COMPANY OF THE PROPOSED LOCATION OF EXCAVATION.
2) TAKE PRECAUTION TO AVOID DAMAGE TO GAS COMPANY INSTALLATIONS.
SEE PROVINCIAL REGULATION 140/92 FOR DETAILS

150 mm WM	WATERMAIN	150 mm WM	150 mm WM	CURB STOP	150 mm WM	WATERMAIN	150 mm WM
	HYDRANT		VALVE			HYDRANT	
	LAND DRAINAGE SEWER		WASTE WATER SEWER			LAND DRAINAGE SEWER	WASTE WATER SEWER
	MANHOLE		CATCH BASIN			WASTE WATER SEWER	PAVEMENT CROWN
	CURB INLET		CULVERT				N/W PROPERTY LINE
	PIPE ABANDONMENTS		SURVEY BAR				S/E PROPERTY LINE
	EXISTING		NEW				LEGEND - PROFILE
	LEGEND - PLAN		NEW				LEGEND - PROFILE

LOCATION APPROVED
UNDERGROUND STRUCTURES

DATE

NOTE:
LOCATION OF UNDERGROUND STRUCTURES AS SHOWN ARE BASED ON THE BEST INFORMATION AVAILABLE. BUT NO GUARANTEE IS GIVEN THAT ALL EXISTING UTILITIES ARE SHOWN OR THAT THE GIVEN LOCATIONS ARE EXACT. CONFIRMATION OF EXISTENCE AND EXACT LOCATION OF ALL SERVICES MUST BE OBTAINED FROM THE INDIVIDUAL UTILITIES BEFORE PROCEEDING WITH CONSTRUCTION.

NO.	REVISIONS	DATE	BY
0	ISSUED FOR CONSTRUCTION	05/11/03	ADL

DESIGNED BY	GEB	CHECKED BY	DATE
DRAWN BY	ADL	APPROVED BY	DATE
HOR. SCALE	1:250	RELEASED FOR CONSTRUCTION	DATE
VERT. SCALE	1:50		

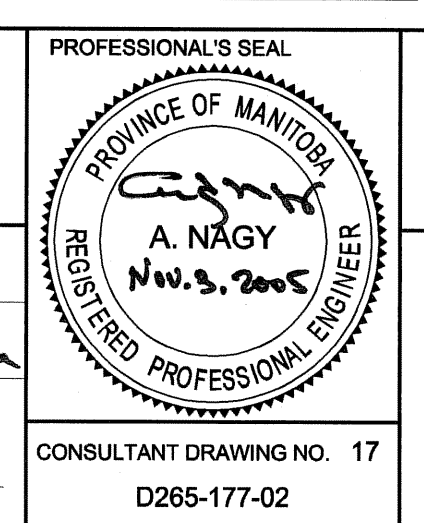
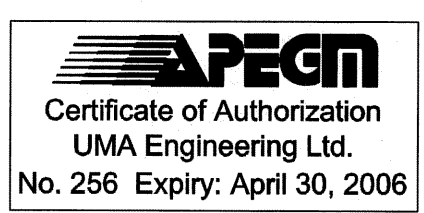

THE CITY OF WINNIPEG
WATER AND WASTE DEPARTMENT

ALEXANDER/BANNATYNE
COMBINED SEWER RELIEF
CONTRACT 2B

ELGIN AVENUE
KATE AVENUE
TO 135m WEST OF ISABEL STREET

SHEET 14 OF 17
CITY DRAWING NUMBER
REV 0
LD-3217

BID OPPORTUNITY NO. 584-2005

- CONSTRUCTION NOTES:**
1. FOR DETAILED TEST HOLE INFORMATION, SEE SPECIFICATION.
 2. THE LOCATION OF ALL SERVICES IS TO BE CONFIRMED IN THE FIELD.
 3. INSTALL NEW SEWERS AND CATCHBASIN LEADS BY TRENCHLESS METHODS WHEREVER POSSIBLE.
 4. RENEW/REHABILITATE CATCHBASINS & RENEW CATCHBASIN LEADS WHERE NOTED.