

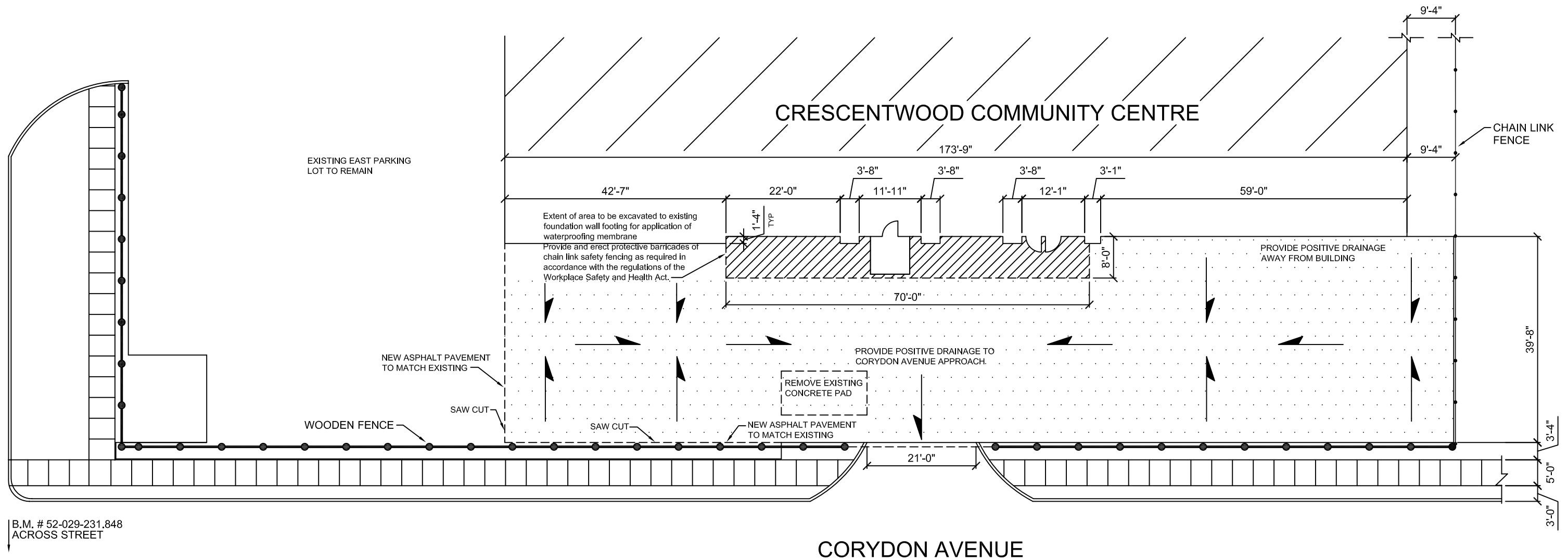





ROCKWOOD STREET



PROPOSED SITE PLAN/GRADING PLAN

SCALE: NOT TO SCALE

DRAWING LEGEND:

-  AREA OF NEW ASPHALT CONSTRUCTION
-  AREA OF NEW WATERPROOFING MEMBRANE APPLICATION TO FOUNDATION WALL
-  FINISHED ASPHALT GRADING DIRECTION

75mm THICK TYPE 1A ASPHALT PAVEMENT
 150mm LIMESTONE BASE COURSE (20mm AGG.)
 300mm LIMESTONE SUB-BASE COURSE (50mm AGG.)
 GEOTEXTILE FABRIC (AS SPECIFIED)
 SCARIFY 150mm AND COMPACT SUITABLE SUBGRADE

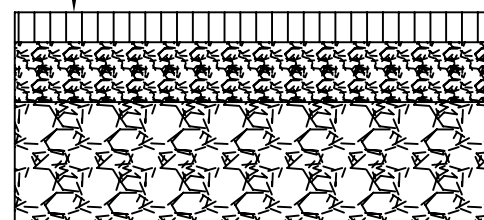

HEAVY DUTY PAVEMENT STRUCTURE

SCALE: NOT TO SCALE

NOTE:
 DIMENSIONS ONLY APPROXIMATE
 CONTRACTOR TO VERIFY ALL SITE
 CONDITIONS AND DIMENSIONS
 PRIOR TO ANY CONSTRUCTION

S-2	
CRESCENTWOOD COMMUNITY CENTRE 1170 CORYDON AVE. WINNIPEG, MANITOBA	
DATE: AUGUST 11, 2005	SCALE: NTS
PROPOSED SITE PLAN / GRADING PLAN	

 <i>Embrace the Spirit • Vivez l'esprit</i>	<p>THE CITY OF WINNIPEG PUBLIC WORKS DEPARTMENT BUILDING SERVICES DIVISION 100 MAIN STREET WINNIPEG, MANITOBA R3C 1A4</p> <p>PHONE: (204) 986-7266 FAX: (204) 986-7311</p>
---	--