

SEWER SERVICE INFORMATION			
ADDRESS	PL TIE (SHORT/LONG)	JUNCTION TIE	REMARKS
259 QUEENSTON ST	3.35 SNPL	11.13 S OF MH AT KINGSWAY	
245 QUEENSTON ST	44.30 NSPL	44.20 N OF MH AT NW PL OF KINGSWAY	
250 QUEENSTON ST	1.80 SNPL	22.40 N OF MH AT NW PL OF KINGSWAY	
252 QUEENSTON ST	2.81 SNPL	6.20 N OF MH AT NW PL OF KINGSWAY	
258 QUEENSTON ST	4.98 SNPL	11.89 S OF MH AT KINGSWAY	
262 QUEENSTON ST		36.73 S OF MH AT KINGSWAY	WY'ED SERVICE WITH #266
263 QUEENSTON ST	2.13 SNPL	23.47 S OF MH AT KINGSWAY	
266 QUEENSTON ST			SEE #262
267 QUEENSTON ST	2.13 SNPL	35.97 S OF MH AT KINGSWAY	
270 QUEENSTON ST	3.81 SNPL	49.88 S OF MH AT KINGSWAY	
271 QUEENSTON ST		49.07 S OF MH AT KINGSWAY	
274 QUEENSTON ST	4.57 SNPL	57.81 S OF MH AT KINGSWAY	
275 QUEENSTON ST	4.27 SNPL	59.74 S OF MH AT KINGSWAY	
278 QUEENSTON ST	3.05 SNPL	73.00 S OF MH AT KINGSWAY	
279 QUEENSTON ST	10.06 NSPL	85.80 S OF MH AT KINGSWAY	WY'ED SERVICE WITH #283

WATER SERVICE INFORMATION			
ADDRESS	DISTANCE	SHORT & LONG PROPERTY MEASUREMENT	REMARKS
245 QUEENSTON ST (COMMERCIAL)	0.91	N OF S EDGE BLDG	
	8.84	N OF HYD	
250 QUEENSTON ST (RESIDENTIAL)	0.61	SNHL	
	2.13	N OF HYD	
252 QUEENSTON ST (RESIDENTIAL)	2.44	SNHL	
	7.01	N HYD	
258 QUEENSTON ST (RESIDENTIAL)	6.40	NSHL	
	5.49	SSL KINGSWAY	
259 QUEENSTON ST (RESIDENTIAL)	1.52	SNHL	
	3.35	SSL KINGSWAY	
262 QUEENSTON ST (RESIDENTIAL)	1.52	NNHL #266	
	26.52	SSL KINGSWAY	
263 QUEENSTON ST (RESIDENTIAL)	1.52	SNHL	
	15.85	SSL KINGSWAY	
266 QUEENSTON ST (RESIDENTIAL)	1.52	NNHL	
	28.52	SSL KINGSWAY	
267 QUEENSTON ST (RESIDENTIAL)	0.91	SNHL	
	28.04	SSL KINGSWAY	
270 QUEENSTON ST (RESIDENTIAL)	2.13	SNHL	
	40.84	SSL KINGSWAY	
271 QUEENSTON ST (RESIDENTIAL)	3.05	SNHL	
	41.45	SSL KINGSWAY	
274 QUEENSTON ST (RESIDENTIAL)	0.00	OPP NL FRONT STEPS	
	54.88	SSL KINGSWAY	
275 QUEENSTON ST (RESIDENTIAL)	0.00	OPP NL WINDOW	
	55.47	SSL KINGSWAY	
278 QUEENSTON ST (RESIDENTIAL)	1.33	SSL BASEMENT	
	66.45	SSL KINGSWAY	
279 QUEENSTON ST (RESIDENTIAL)	0.46	NNHL #283	
	74.37	SSL KINGSWAY	

SEWER JUNCTION INFORMATION*			
REF. MH	DIST FROM	SIZE	CLOCK AT
22218	11.00	1500	10
22218	12.60	1500	02
22218	14.30	1500	02
22218	23.70	1500	02
22218	36.10	1500	02
22218	36.90	1500	10
22218	42.30	1500	02
22218	43.00	1500	10
22218	46.90	1500	02
22218	47.60	1500	10
22218	60.00	1500	02
5650	10.60	1500	02
5650	11.70	1500	10
5650	17.80	1500	02
5650	23.20	1500	02
5650	35.70	1500	02

*JUNCTION LOCATION FROM VIDEO INSPECTION

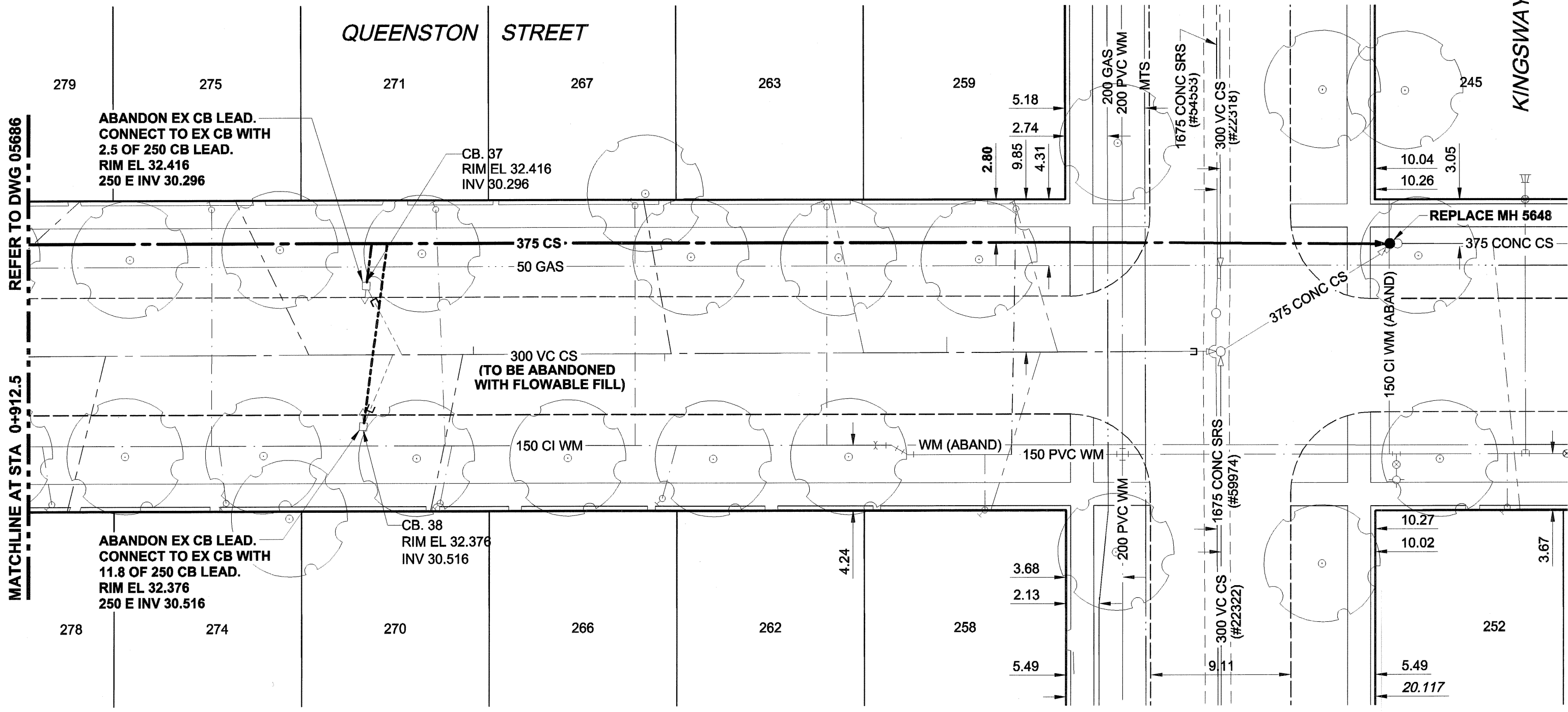

WARNING
 IF POWER EQUIPMENT OR EXPLOSIVES ARE TO BE USED FOR EXCAVATION ON THIS PROJECT, THE CONTRACTOR MUST:
 1) NOTIFY THE GAS COMPANY OF THE PROPOSED LOCATION OF EXCAVATION.
 2) TAKE PRECAUTION TO AVOID DAMAGE TO GAS COMPANY INSTALLATIONS.
 SEE PROVINCIAL REGULATION 140/92 FOR DETAILS

METRIC
 WHOLE NUMBERS INDICATE MILLIMETRES
 DECIMALIZED NUMBERS INDICATE METRES

APEGM
 Certificate of Authorization
 UMA Engineering Ltd.
 No. 256 Expiry: April 30, 2006

CONSTRUCTION NOTES

- INSTALL NEW SEWER BY TRENCHLESS METHODS.
- RENEW BUILDING CONNECTIONS TO PROPERTY LINE.
- ALL SEWER & WATER SERVICES TO LOCATED IN THE FIELD BY THE CONTRACTOR.
- SEWERS AND CB LEADS TO BE ABANDONED SHALL BE FILLED WITH CEMENT STABILIZED FLOWABLE FILL.

BID OPPORTUNITY NO. 598-2005

150 mm WM	WATERMAIN	150 mm WM	CURB STOP	150 mm WM	WATERMAIN	150 mm WM
	HYDRANT		REDUCER		HYDRANT	
	VALVE		COUPLING		VALVE	
	LAND DRAINAGE SEWER		ANODE		LAND DRAINAGE SEWER	
	WASTE WATER SEWER		HYDRO		WASTE WATER SEWER	
	MANHOLE		MTS		PAVEMENT CROWN	
	CATCH BASIN		N/W PROPERTY LINE		S/E PROPERTY LINE	
	CURB INLET		N/W GUTTER		S/E GUTTER	
	CULVERT		TREE			
	PIPE ABANDONMENTS					
	SURVEY BAR					
EXISTING	LEGEND - PLAN	NEW	LEGEND - PLAN	NEW	LEGEND - PROFILE	NEW

LOCATION APPROVED
 UNDERGROUND STRUCTURES

SUPR. U/G STRUCTURES DATE COMMITTEE

NOTE:
 LOCATION OF UNDERGROUND STRUCTURES AS SHOWN ARE BASED ON THE BEST INFORMATION AVAILABLE. BUT NO GUARANTEE IS GIVEN THAT ALL EXISTING UTILITIES ARE SHOWN OR THAT THE GIVEN LOCATIONS ARE EXACT. CONFIRMATION OF EXISTENCE AND EXACT LOCATION OF ALL SERVICES MUST BE OBTAINED FROM THE INDIVIDUAL UTILITIES BEFORE PROCEEDING WITH CONSTRUCTION.

BM 51-037	N.W. Cor. Kingsway & Queenston St.
ELEV 232.446m	Brass plug in 12.8 m Conc. Pile,
	4.5 m S of N.L. Kingsway &
	2.5 m E. of W.L. Queenston St.

UMA AECOM	
© 2005 UMA ENGINEERING LTD. ALL RIGHTS RESERVED.	
DESIGNED BY	MJR
CHECKED BY	<i>[Signature]</i>
DRAWN BY	KMB
APPROVED BY	<i>[Signature]</i>
HOR. SCALE	1:250
VERT. SCALE	1:50
RELEASER FOR CONSTRUCTION	<i>[Signature]</i>
DATE	05/10/14
DATE	05/10/14

PROFESSIONAL'S SEAL
 PROVINCE OF MANITOBA
 REGISTERED PROFESSIONAL ENGINEER
 A. NAGY
 Oct 14, 2005
 CONSULTANT DRAWING NO. 21
 D265-195-03

THE CITY OF WINNIPEG
WATER AND WASTE DEPARTMENT

2005 COMBINED SEWER RENEWALS
BY EXTERNAL POINT REPAIRS AND REPLACEMENTS
CONTRACT 17
QUEENSTON STREET
 1ST MH S OF KINGSWAY
 TO MH AT KINGSWAY

SHEET 21 OF 21
 CITY DRAWING NUMBER
05687
 REV 0