

1 WALL PENETRATION NO. 1
- N.T.S.

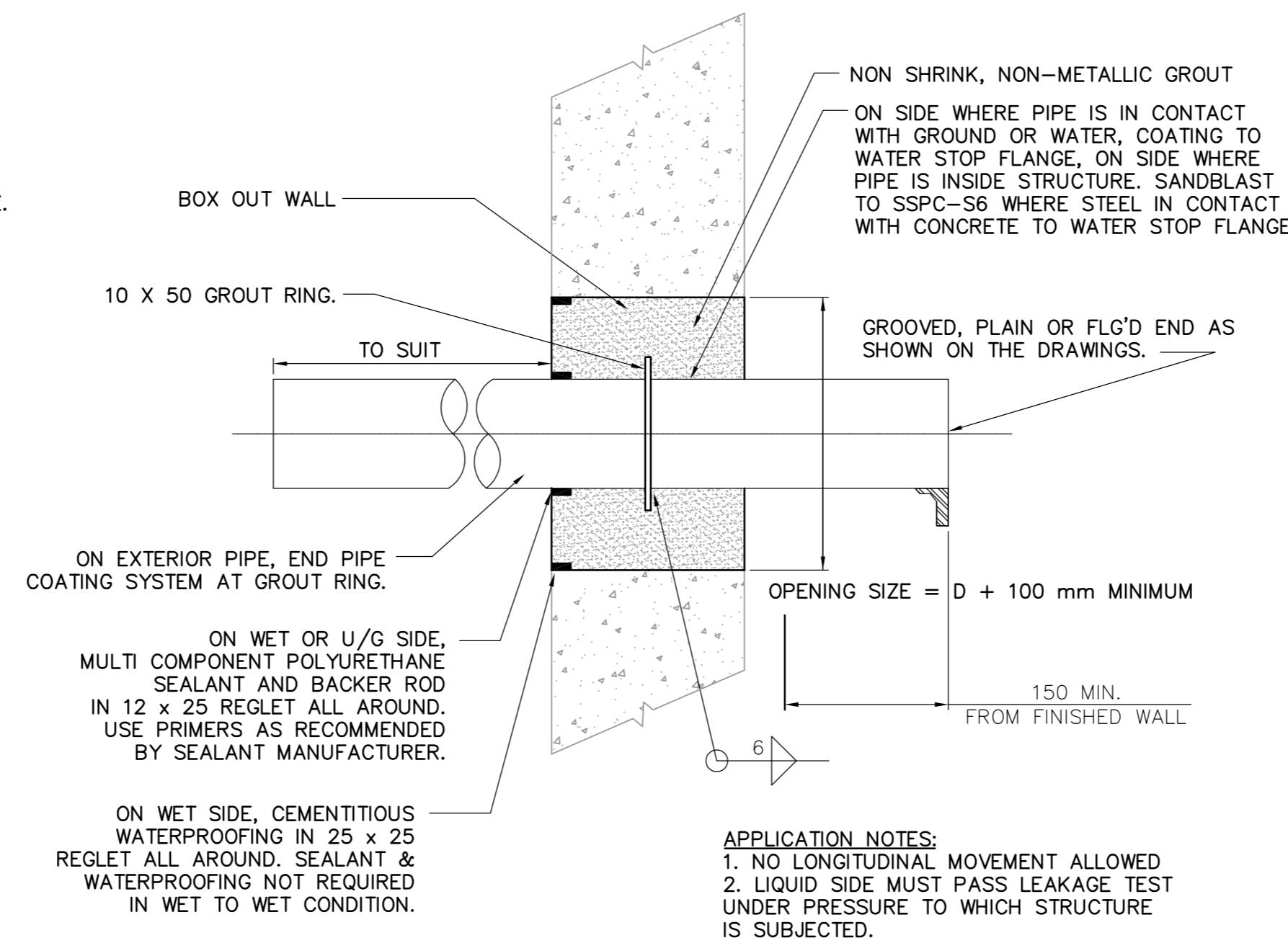

2 WALL PENETRATION NO. 2
- N.T.S.

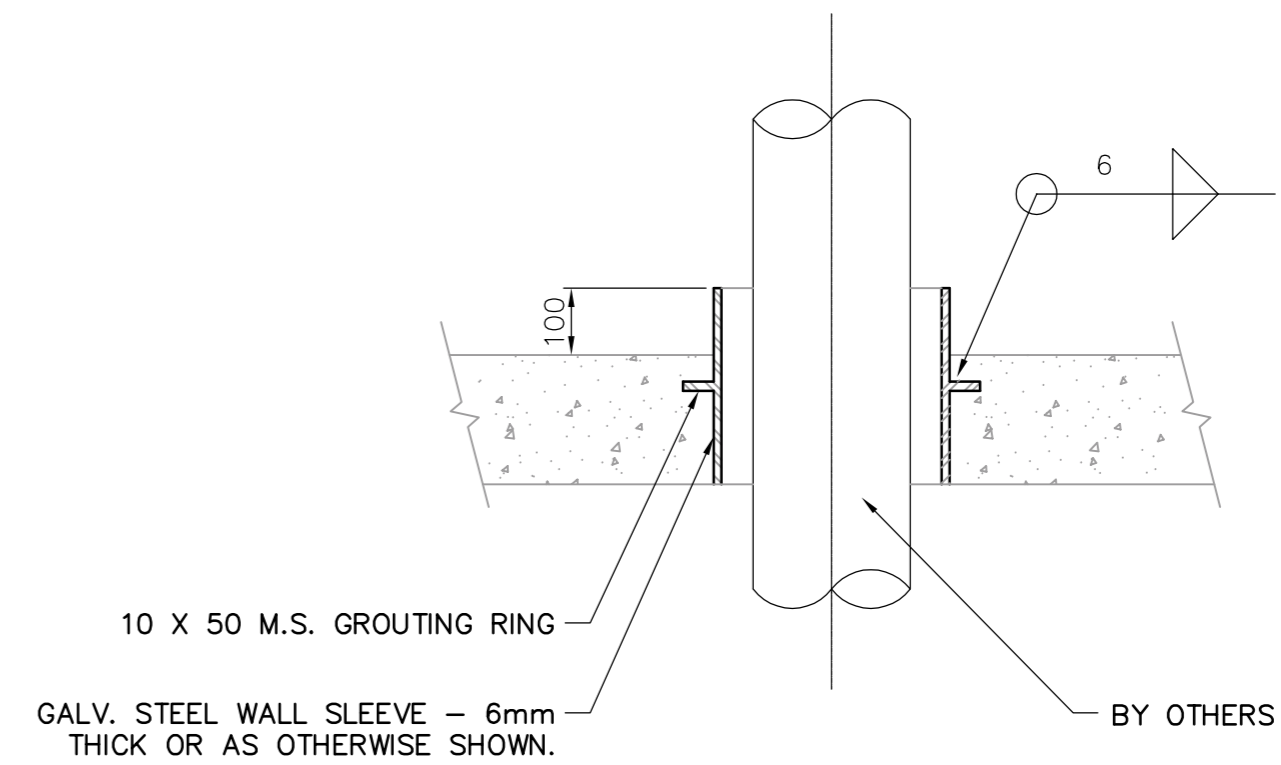

3 FLOOR PENETRATION DETAILS
- N.T.S.

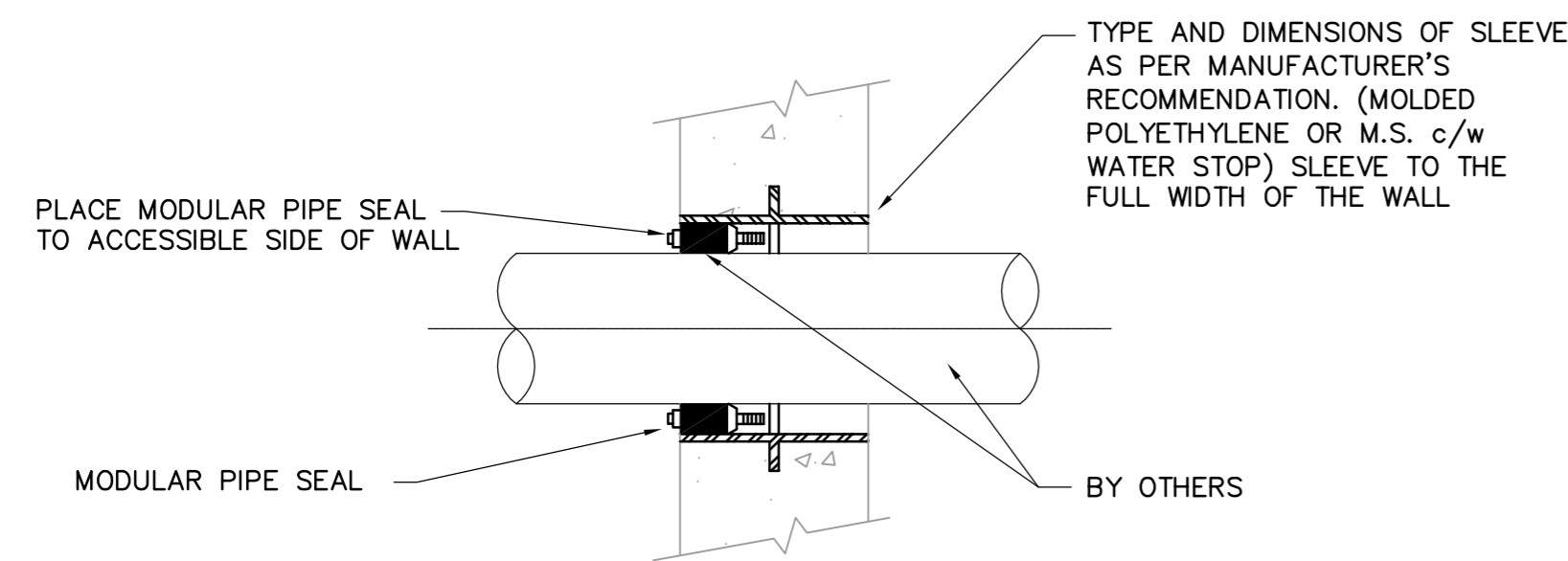

APPLICATION NOTES
1. GROUT RING REQ'D ONLY FOR PENETRATION IN WET AREAS OR BELOW GRADE.
2. LIQUID SIDE MUST PASS LEAKAGE TEST UNDER PRESSURE TO WHICH STRUCTURE IS SUBJECTED
3. FOR PENETRATIONS THROUGH EXISTING STRUCTURES CORE AND INSTALL SEAL PER MANUFACTURER'S SPEC'S (NO SLEEVE REQUIRED)
4. SUPPORT PIPE ON BOTH SIDES OF WALL PENETRATION.
5. USE STAINLESS STEEL HARDWARE.

4 WALL & FLOOR PENETRATION NO. 4
- N.T.S.

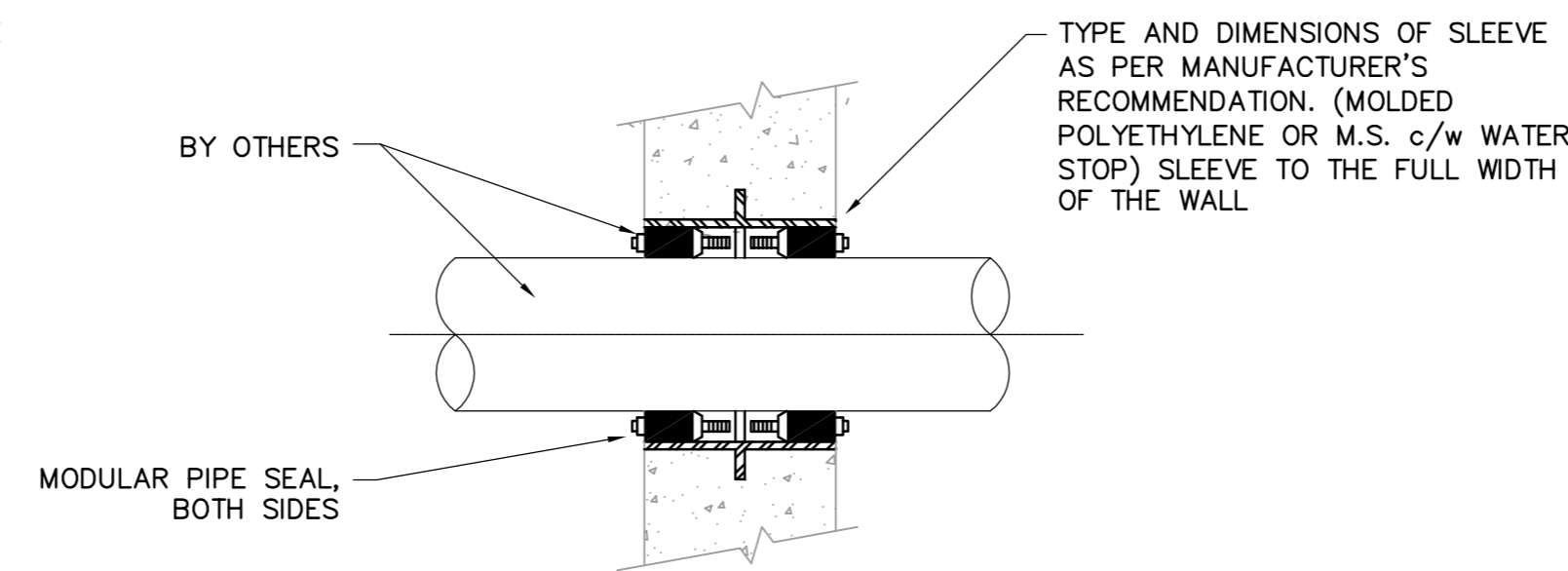

APPLICATION NOTES
1. GROUT RING REQ'D ONLY FOR PENETRATION IN WET AREAS OR BELOW GRADE.
2. LIQUID SIDE MUST PASS LEAKAGE TEST UNDER PRESSURE TO WHICH STRUCTURE IS SUBJECTED
3. FOR PENETRATIONS THROUGH EXISTING STRUCTURES CORE AND INSTALL SEAL PER MANUFACTURER'S SPEC'S (NO SLEEVE REQUIRED)
4. SUPPORT PIPE ON BOTH SIDES OF WALL PENETRATION.
5. USE STAINLESS STEEL HARDWARE.

5 WALL & FLOOR PENETRATION NO. 5
- N.T.S.

 APEGM Certificate of Authorization CH2M Hill Canada Limited (ON) No. 1441 Expiry: April 30, 2006	B.M. ELEV.	 Frederickson Cooper ARCHITECTS	 A Tyco International Ltd. Company	ENGINEER'S SEAL	 THE CITY OF WINNIPEG WATER AND WASTE DEPARTMENT ENGINEERING DIVISION WATER TREATMENT PLANT MAIN BUILDING FOUNDATIONS AND CONCRETE STRUCTURES 1 PROCESS MECHANICAL STANDARD DETAILS	CITY FILE NUMBER SHEET OF CITY DRAWING NUMBER 1-060B-D-M9441-001-00D	
	DESIGNED BY: DC			CHECKED BY: DL			ORIGINAL SIGNED BY: D. CUDDINGTON
	DRAWN BY: EK			APPROVED BY: DJT			2005/10/28
	SCALE: NONE			RELEASED FOR CONSTRUCTION BY: R. SOROKOWSKI			CONSULTANT DRAWING NO. WB-M9441
00 ISSUED FOR TENDER	05/10/28 DC	DATE: 2005/10/25	DATE: 2005/10/28				