

SEWER SERVICE INFORMATION			
ADDRESS	SIZE	Ø	DIST
1462 WELINGTON CR S	RESIDENTIAL	13.72 S OF NL	JUNCTION TIE
1469 WELINGTON CR S	RESIDENTIAL	26.60 S 1ST MH N ACADEMY	
1473 WELINGTON CR S	RESIDENTIAL	5.18 S OF NL	
1479 WELINGTON CR S	RESIDENTIAL	99.36 N MH AT ACADEMY	
1481 WELINGTON CR S	RESIDENTIAL	7.01 N OF SL	
1485 WELINGTON CR S	RESIDENTIAL	3.20 S 1ST MH N ACADEMY	
1489 WELINGTON CR S	RESIDENTIAL	8.10 N OF SL	
1493 WELINGTON CR S	RESIDENTIAL	11.80 S 1ST MH N ACADEMY	
1499 WELINGTON CR S	RESIDENTIAL	5.79 N OF SL	
1489 WELINGTON CR S	RESIDENTIAL	42.0 S 1ST MH N ACADEMY	
1489 WELINGTON CR S	RESIDENTIAL	4.27 N OF SL	
1481 WELINGTON CR S	RESIDENTIAL	57.60 S 1ST MH N ACADEMY	
1485 WELINGTON CR S	RESIDENTIAL	6.71 N OF SL	
1489 WELINGTON CR S	RESIDENTIAL	73.0 S 1ST MH N ACADEMY	
1499 WELINGTON CR S	RESIDENTIAL	9.45 S OF NL	
580 ACADEMY RD	COMMERCIAL	88.50 S 1ST MH N ACADEMY	
580 ACADEMY RD	COMMERCIAL	SERV. OFF ACADEMY	
591 ACADEMY RD	COMMERCIAL	34.90 E OF MH WELINGTON CR S	
591 ACADEMY RD	COMMERCIAL	10.97 S OF NL	
591 ACADEMY RD	COMMERCIAL	72.10 S 1ST MH N ACADEMY	

WATER SERVICE INFORMATION					
ADDRESS	SIZE(mm) & TYPE (STREET)	SIZE(mm) & TYPE (PROP)	SHORT & LONG MEASUREMENT	CORP. LOCATION	REMARKS
1462 WELINGTON CR S	20 COPPER	12	0.92 SSL HSE	OPP S/C	
1469 WELINGTON CR S	20 COPPER	12	66.23 NNL ACADEMY		
1473 WELINGTON CR S	20 COPPER	12	0.46 EWL CELLAR	3.9 W MV EL WELL	
1479 WELINGTON CR S	20 COPPER	12	3.66 W VALVE @ EL ACAD.	4.3 W MV EL WELL	
1481 WELINGTON CR S	20 COPPER	12	1.52 SNL HSE		
1485 WELINGTON CR S	20 COPPER	12	100.58 NNL ACADEMY		
1489 WELINGTON CR S	20 COPPER	12	5.03 SNL HSE	3.35 SNL HSE	
1489 WELINGTON CR S	20 COPPER	12	84.43 NNL ACADEMY		
1481 WELINGTON CR S	20 COPPER	12	1.83 NSL HSE	0.6 S OF S/C	
1485 WELINGTON CR S	20 COPPER	12	71.63 NNL ACADEMY		
1489 WELINGTON CR S	20 COPPER	12	3.66 NSL HSE	OPP S/C	
1489 WELINGTON CR S	20 COPPER	12	52.12 NNL ACADEMY		
1489 WELINGTON CR S	20 COPPER	12	0.61 NSL HSE	3.66 N OF S/C	
1485 WELINGTON CR S	20 COPPER	12	34.75 NNL ACADEMY		
1485 WELINGTON CR S	20 COPPER	12	5.84 NSL HSE	4.57 NSL HSE	
1489 WELINGTON CR S	20 COPPER	12	26.22 NNL ACADEMY		
1499 WELINGTON CR S	20 COPPER	12		2.13 S OF S/C	
591 ACADEMY RD	20 COPPER	20	1.22 NSL HSE		
591 ACADEMY RD	25 COPPER	25	0.8 OFF BLDG	OPP SL HSE	SERV. OFF WELING.
580 ACADEMY RD	25 COPPER	25	28.50 NNL ACADEMY		SERV. OFF BEAVERB.
591 ACADEMY RD	25 COPPER	25	0.8 OFF BLDG	OPP S/C	
591 ACADEMY RD	25 COPPER	25	14.63 SSL ACADEMY		

SEWER JUNCTION INFORMATION FROM SEWER VIDEO INSPECTION S-MA60006795			
DISTANCE FROM MH S-MH60005428			
3.20	S	150	WEST JN
11.80	S	150	WEST JN
26.60	S	150	EAST JN
41.30	S	150	EAST JN
42.00	S	150	WEST JN
50.00	S	150	WEST JN
50.60	S	150	EAST JN
57.60	S	150	WEST JN
72.10	S	150	EAST JN
73.00	S	150	WEST JN
88.50	S	150	WEST JN

NOTE: CHAINAGES SHOWN ARE ALONG E P OF WELINGTON CR. S

WELLINGTON CRESCENT S



- CONSTRUCTION NOTES:
- SEWER TO BE RENEWED BY TRENCHLESS METHODS.
 - CONFIRM THE LOCATION OF ALL SEWER SERVICES WITHIN LIMITS OF RENEWAL.
 - OBTAIN VIDEO INSPECTION OF ALL SEWER SERVICES AND CB LEADS FROM OPEN EXCAVATION TO PROPERTY LINE.
 - SEWER SERVICES TO BE INSTALLED AT A MINIMUM 1.0% SLOPE.
 - BACKFILL IN BOULEVARD TO BE CLASS 5.
 - BACKFILL UNDER PAVEMENT, IN SIDEWALKS, & WITHIN 1.0 m OF PAVEMENT TO BE CLASS 3.

METRIC
WHOLE NUMBERS INDICATE MILLIMETRES
DECIMALIZED NUMBERS INDICATE METRES

WARNING
IF POWER EQUIPMENT OR EXPLOSIVES ARE TO BE USED FOR EXCAVATION ON THIS PROJECT THE CONTRACTOR MUST:
1) NOTIFY THE GAS COMPANY OF THE PROPOSED LOCATION OF EXCAVATION.
2) TAKE PRECAUTION TO AVOID DAMAGE TO GAS COMPANY INSTALLATIONS.
SEE PROVINCIAL REGULATION 210/72 FOR DETAILS

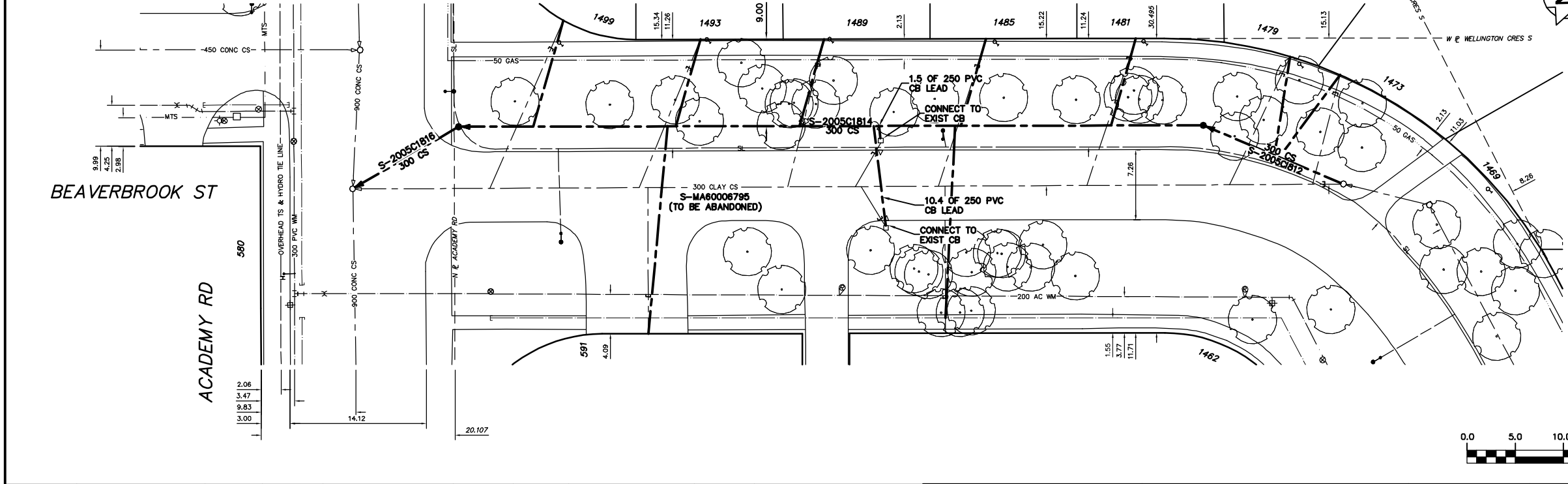
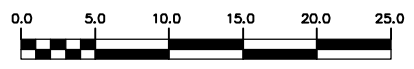

<table border="1"> <tr><td>200 WM</td><td>WATERMAIN</td><td>200 WM</td><td>SL, HYDRO</td><td>150 WM</td><td>WATERMAIN</td><td>150 WM</td></tr> <tr><td>⊕</td><td>HYDRANT</td><td>⊕</td><td>MTS</td><td>⊕</td><td>HYDRANT</td><td>⊕</td></tr> <tr><td>⊙</td><td>VALVE</td><td>⊙</td><td>TRAFFIC SIGNALS</td><td>⊙</td><td>VALVE</td><td>⊙</td></tr> <tr><td>525 LDS</td><td>LAND DRAINAGE SEWER</td><td>525 LDS</td><td>GAS</td><td>300 LDS</td><td>LAND DRAINAGE SEWER</td><td>300 LDS</td></tr> <tr><td>375 WWS</td><td>WASTEWATER SEWER</td><td>375 WWS</td><td>SURVEY BAR</td><td>250 WWS</td><td>WASTEWATER SEWER</td><td>250 WWS</td></tr> <tr><td>○</td><td>MANHOLE</td><td>○</td><td>FENCE</td><td>⊗</td><td>PROFILE</td><td>⊗</td></tr> <tr><td>□</td><td>CATCH BASIN</td><td>□</td><td>POLE - HYDRO, MTS</td><td>⊖</td><td>GROUND ABOVE PIPE</td><td>⊖</td></tr> <tr><td>▽</td><td>CURB INLET</td><td>▽</td><td>CURB STOP</td><td>⊕</td><td>⊕ DITCH (NORTH & WEST)</td><td>⊕</td></tr> <tr><td>⊕</td><td>JUNCTIONS</td><td>⊕</td><td>GUY ANCHOR</td><td>⊖</td><td>⊖ DITCH (SOUTH & EAST)</td><td>⊖</td></tr> <tr><td>⊖</td><td>CULVERT</td><td>⊖</td><td>LIGHT STANDARD</td><td>⊕</td><td>GUTTER (NORTH & WEST)</td><td>⊕</td></tr> <tr><td>⊕</td><td>ANODE</td><td>⊕</td><td>TREE</td><td>⊖</td><td>GUTTER (SOUTH & EAST)</td><td>⊖</td></tr> <tr><td>EXISTING</td><td>LEGEND-PLAN</td><td>PROPOSED</td><td>EXISTING</td><td>LEGEND-PLAN</td><td>PROPOSED</td><td>EXISTING</td></tr> <tr><td>LEGEND-PLAN</td><td>PROPOSED</td><td>EXISTING</td><td>LEGEND-PLAN</td><td>PROPOSED</td><td>EXISTING</td><td>LEGEND-PROFILE</td></tr> <tr><td>PROPOSED</td><td>EXISTING</td><td>LEGEND-PLAN</td><td>PROPOSED</td><td>EXISTING</td><td>LEGEND-PROFILE</td><td>PROPOSED</td></tr> </table>	200 WM	WATERMAIN	200 WM	SL, HYDRO	150 WM	WATERMAIN	150 WM	⊕	HYDRANT	⊕	MTS	⊕	HYDRANT	⊕	⊙	VALVE	⊙	TRAFFIC SIGNALS	⊙	VALVE	⊙	525 LDS	LAND DRAINAGE SEWER	525 LDS	GAS	300 LDS	LAND DRAINAGE SEWER	300 LDS	375 WWS	WASTEWATER SEWER	375 WWS	SURVEY BAR	250 WWS	WASTEWATER SEWER	250 WWS	○	MANHOLE	○	FENCE	⊗	PROFILE	⊗	□	CATCH BASIN	□	POLE - HYDRO, MTS	⊖	GROUND ABOVE PIPE	⊖	▽	CURB INLET	▽	CURB STOP	⊕	⊕ DITCH (NORTH & WEST)	⊕	⊕	JUNCTIONS	⊕	GUY ANCHOR	⊖	⊖ DITCH (SOUTH & EAST)	⊖	⊖	CULVERT	⊖	LIGHT STANDARD	⊕	GUTTER (NORTH & WEST)	⊕	⊕	ANODE	⊕	TREE	⊖	GUTTER (SOUTH & EAST)	⊖	EXISTING	LEGEND-PLAN	PROPOSED	EXISTING	LEGEND-PLAN	PROPOSED	EXISTING	LEGEND-PLAN	PROPOSED	EXISTING	LEGEND-PLAN	PROPOSED	EXISTING	LEGEND-PROFILE	PROPOSED	EXISTING	LEGEND-PLAN	PROPOSED	EXISTING	LEGEND-PROFILE	PROPOSED	<p>LOCATION APPROVED UNDERGROUND STRUCTURES</p> <p>DATE: _____</p> <p>NOTE: LOCATION OF UNDERGROUND STRUCTURES AS SHOWN ARE BASED ON THE BEST INFORMATION AVAILABLE BUT NO GUARANTEE IS GIVEN THAT ALL EXISTING UTILITIES ARE SHOWN OR THAT THE GIVEN LOCATIONS ARE EXACT. CONFIRMATION OF EXISTENCE AND EXACT LOCATION OF ALL SERVICES MUST BE OBTAINED FROM THE INDIVIDUAL UTILITIES BEFORE PROCEEDING WITH CONSTRUCTION.</p>	<p>B.M. ELEV. _____</p> <p>FIELD BOOK # _____</p> <p>POSTED TO LISB _____</p> <p>NO. REVISIONS _____</p> <p>DATE BY _____</p>	<p>CITY OF WINNIPEG WATER AND WASTE ENGINEERING DIVISION</p> <p>DESIGNED BY: NC CHECKED BY: TW</p> <p>DRAWN BY: CJH APPROVED BY: KZ</p> <p>HOR. SCALE: 1:250 VERTICAL: 1:50</p> <p>RELEASED FOR CONSTRUCTION: _____</p> <p>DATE: 2005 12 09</p>	<p>ENGINEER'S SEAL</p> <p>ORIGINAL SIGNED BY K.R. ZUREK 05/12/08</p>	<p>THE CITY OF WINNIPEG WATER AND WASTE DEPARTMENT</p> <p>2005 SEWER RENEWALS AND SEWER REPAIRS CONTRACT 18 WELLINGTON CRESCENT S MH AT ACADEMY ROAD TO 1ST MH N OF ACADEMY ROAD</p>	<p>SHEET 10 OF 10 CITY DRAWING NUMBER 05709</p>
200 WM	WATERMAIN	200 WM	SL, HYDRO	150 WM	WATERMAIN	150 WM																																																																																																		
⊕	HYDRANT	⊕	MTS	⊕	HYDRANT	⊕																																																																																																		
⊙	VALVE	⊙	TRAFFIC SIGNALS	⊙	VALVE	⊙																																																																																																		
525 LDS	LAND DRAINAGE SEWER	525 LDS	GAS	300 LDS	LAND DRAINAGE SEWER	300 LDS																																																																																																		
375 WWS	WASTEWATER SEWER	375 WWS	SURVEY BAR	250 WWS	WASTEWATER SEWER	250 WWS																																																																																																		
○	MANHOLE	○	FENCE	⊗	PROFILE	⊗																																																																																																		
□	CATCH BASIN	□	POLE - HYDRO, MTS	⊖	GROUND ABOVE PIPE	⊖																																																																																																		
▽	CURB INLET	▽	CURB STOP	⊕	⊕ DITCH (NORTH & WEST)	⊕																																																																																																		
⊕	JUNCTIONS	⊕	GUY ANCHOR	⊖	⊖ DITCH (SOUTH & EAST)	⊖																																																																																																		
⊖	CULVERT	⊖	LIGHT STANDARD	⊕	GUTTER (NORTH & WEST)	⊕																																																																																																		
⊕	ANODE	⊕	TREE	⊖	GUTTER (SOUTH & EAST)	⊖																																																																																																		
EXISTING	LEGEND-PLAN	PROPOSED	EXISTING	LEGEND-PLAN	PROPOSED	EXISTING																																																																																																		
LEGEND-PLAN	PROPOSED	EXISTING	LEGEND-PLAN	PROPOSED	EXISTING	LEGEND-PROFILE																																																																																																		
PROPOSED	EXISTING	LEGEND-PLAN	PROPOSED	EXISTING	LEGEND-PROFILE	PROPOSED																																																																																																		