

DUCHARME AVENUE

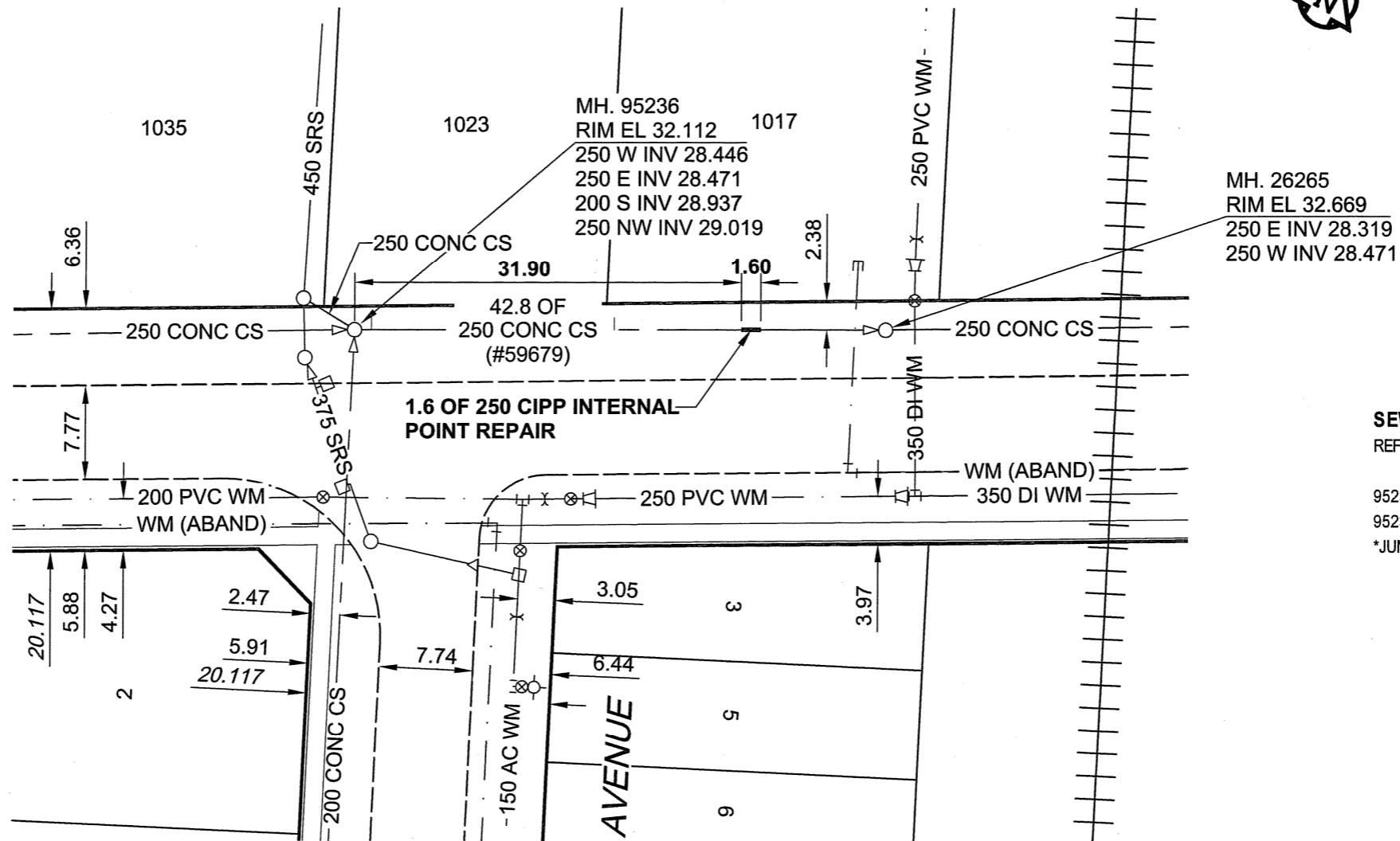

SEWER JUNCTION INFORMATION\*

REF. MH	DIST FROM	SIZE	CLOCK
REF. MH	REF		
95236	1.40	150Ø	10
95236	21.40	150Ø	10

\*JUNCTION LOCATION FROM VIDEO INSPECTION

**METRIC**  
WHOLE NUMBERS INDICATE MILLIMETRES  
DECIMALIZED NUMBERS INDICATE METRES

**APEGM**  
Certificate of Authorization  
UMA Engineering Ltd.  
No. 256 Expiry: April 30, 2006

BID OPPORTUNITY NO. 695-2005

**LOCATION APPROVED**  
UNDERGROUND STRUCTURES

SUPR. U/G STRUCTURES DATE COMMITTEE

**NOTE:**  
LOCATION OF UNDERGROUND STRUCTURES AS SHOWN ARE BASED ON THE BEST INFORMATION AVAILABLE. BUT NO GUARANTEE IS GIVEN THAT ALL EXISTING UTILITIES ARE SHOWN OR THAT THE GIVEN LOCATIONS ARE EXACT. CONFIRMATION OF EXISTENCE AND EXACT LOCATION OF ALL SERVICES MUST BE OBTAINED FROM THE INDIVIDUAL UTILITIES BEFORE PROCEEDING WITH CONSTRUCTION.

BM 50-035 ELEV 233.121m	N.E. Cor. Grenfell Blvd. & Nanton Blvd., Tbit. on top of 0.05 m dia. x 2.4 m iron pipe, 5 m S. of N.L. of Nanton Blvd. & 3 m W. of E.L. of Grenfell Blvd.		
0	ISSUED FOR CONSTRUCTION	06/01/12	KMB
NO.	REVISIONS	YY/MM/DD	BY

UMA | AECOM

© 2005 UMA ENGINEERING LTD. ALL RIGHTS RESERVED.

DESIGNED BY	ALD / MJR	CHECKED BY	ALD
DRAWN BY	KMB	APPROVED BY	<i>[Signature]</i>
HOR. SCALE	1:500	RELEASED FOR CONSTRUCTION	<i>[Signature]</i>
VERT. SCALE		DATE	06/01/12

PROFESSIONAL'S SEAL

CONSULTANT DRAWING NO. 04  
D265-195-02

**THE CITY OF WINNIPEG**  
WATER AND WASTE DEPARTMENT

**2005 COMBINED SEWER RENEWALS  
BY CIPP INTERNAL POINT REPAIRS  
CONTRACT 20**

DUCHARME AVENUE  
MH AT VILLENEUVE AVENUE  
TO 1ST MH E OF VILLENEUVE AVENUE

SHEET 04 OF 26	REV 0
CITY DRAWING NUMBER	05713