

B SIZE 11" x 17" (279mm x 432mm)

PLOT: 06/01/12 10:50:41 AM

UMA FILE NAME: D265-195-02_01-C-1012_RX.dwg Saved By: kberard

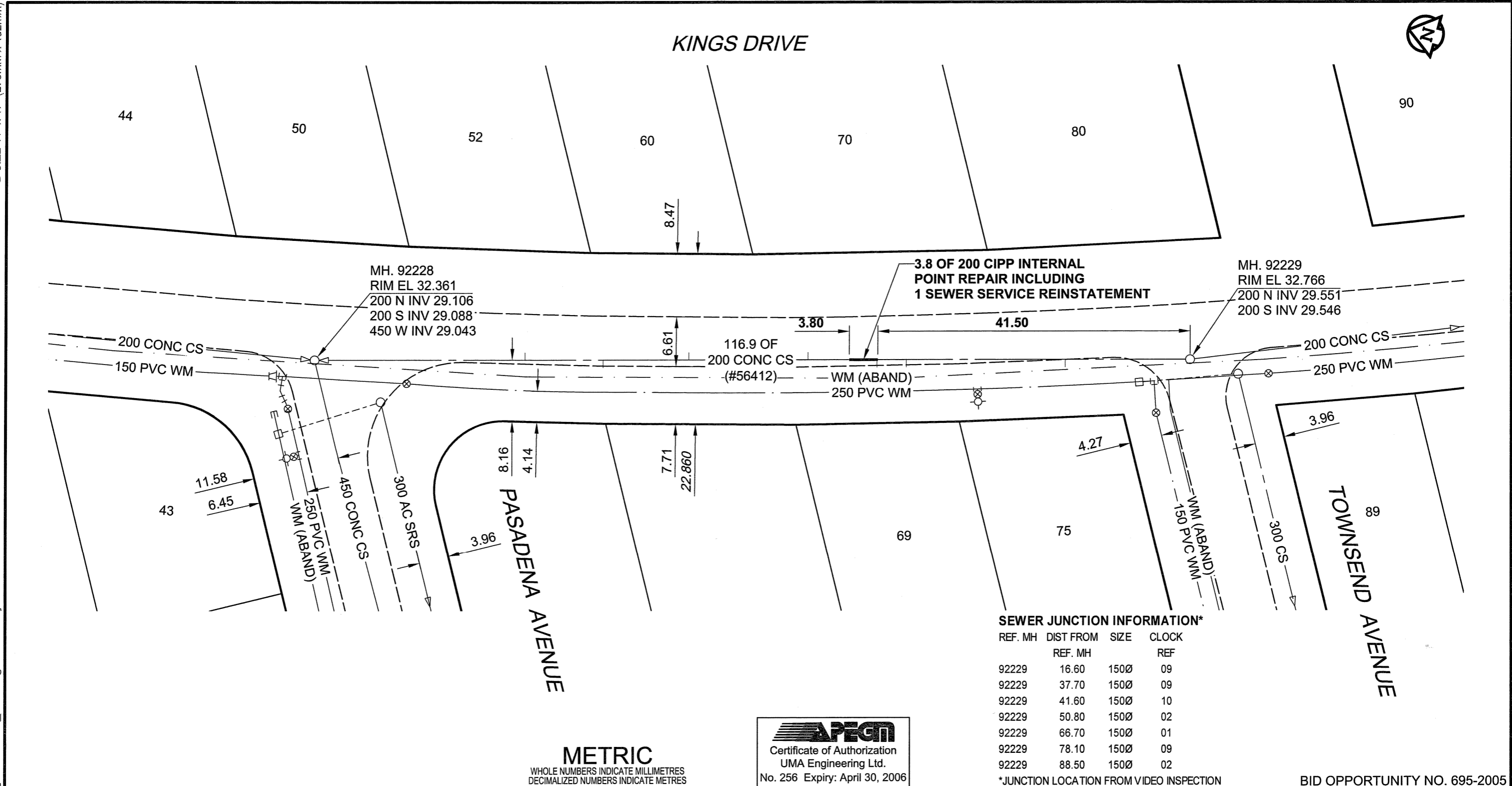

SEWER JUNCTION INFORMATION*

REF. MH	DIST FROM	SIZE	CLOCK
	REF. MH		REF
92229	16.60	150Ø	09
92229	37.70	150Ø	09
92229	41.60	150Ø	10
92229	50.80	150Ø	02
92229	66.70	150Ø	01
92229	78.10	150Ø	09
92229	88.50	150Ø	02

*JUNCTION LOCATION FROM VIDEO INSPECTION

BID OPPORTUNITY NO. 695-2005

METRIC
WHOLE NUMBERS INDICATE MILLIMETRES
DECIMALIZED NUMBERS INDICATE METRES

APECM
Certificate of Authorization
UMA Engineering Ltd.
No. 256 Expiry: April 30, 2006

LOCATION APPROVED
UNDERGROUND STRUCTURES

SUPR. U/G STRUCTURES COMMITTEE DATE

NOTE:
LOCATION OF UNDERGROUND STRUCTURES AS SHOWN ARE BASED ON THE BEST INFORMATION AVAILABLE. BUT NO GUARANTEE IS GIVEN THAT ALL EXISTING UTILITIES ARE SHOWN OR THAT THE GIVEN LOCATIONS ARE EXACT. CONFIRMATION OF EXISTENCE AND EXACT LOCATION OF ALL SERVICES MUST BE OBTAINED FROM THE INDIVIDUAL UTILITIES BEFORE PROCEEDING WITH CONSTRUCTION.

BM 50-035 ELEV 233.121m N.E. Cor. Grenfell Blvd. & Nanton Blvd., Tbit. on top of 0.05 m dia. x 2.4 m iron pipe, 5 m S. of N.L. of Nanton Blvd. & 3 m W. of E.L. of Grenfell Blvd.

NO.	REVISIONS	YY/MM/DD	BY
0	ISSUED FOR CONSTRUCTION	06/01/12	KMB

UMA | AECOM

© 2005 UMA ENGINEERING LTD. ALL RIGHTS RESERVED.

DESIGNED BY	ALD / MJR	CHECKED BY	ALD
DRAWN BY	KMB	APPROVED BY	<i>[Signature]</i>
HOR. SCALE	1:500	RELEASED FOR CONSTRUCTION	<i>[Signature]</i>
VERT. SCALE		DATE	06/01/12

PROFESSIONAL'S SEAL

PROVINCE OF MANITOBA
15 Jan 2009
C. C. MACEY
REGISTERED ENGINEER

CONSULTANT DRAWING NO. 11
D265-195-02

THE CITY OF WINNIPEG
WATER AND WASTE DEPARTMENT

2005 COMBINED SEWER RENEWALS BY CIPP INTERNAL POINT REPAIRS CONTRACT 20

KINGS DRIVE
MH AT PASADENA AVENUE TO MH AT TOWNSEND AVENUE

SHEET 11 OF 26
CITY DRAWING NUMBER 05720
REV 0