

ACADEMY ROAD

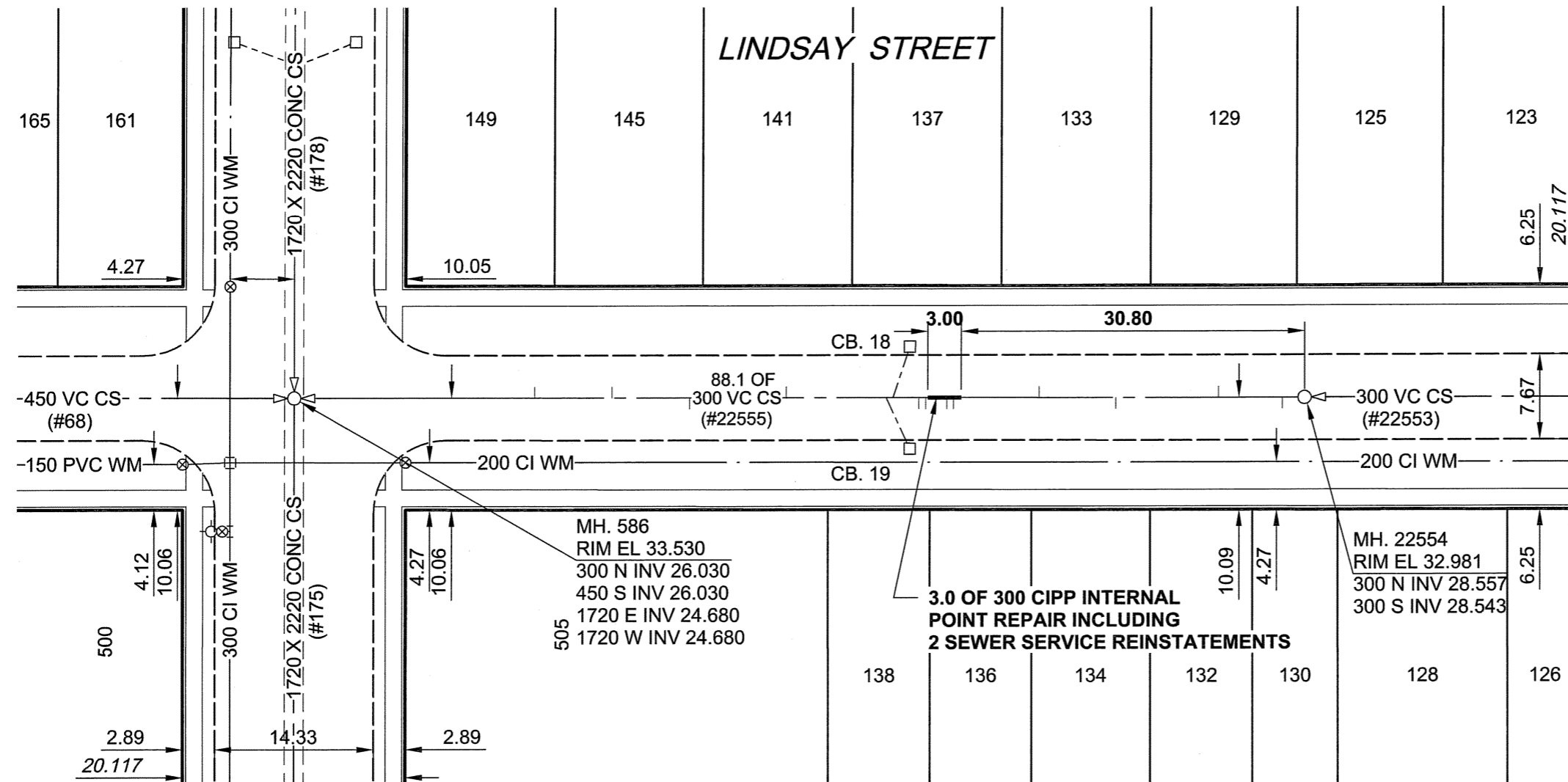

SEWER JUNCTION INFORMATION*

REF. MH	DIST FROM REF. MH	SIZE	CLOCK REF
22554	2.00	150Ø	10
22554	7.70	150Ø	02
22554	16.90	150Ø	11
22554	23.80	150Ø	01
22554	31.50	150Ø	12
22554	32.10	150Ø	10
22554	34.00	150Ø	12
22554	34.60	150Ø	12
22554	46.50	150Ø	02
22554	55.20	150Ø	11
22554	62.20	150Ø	01
22554	69.20	150Ø	01

*JUNCTION LOCATION FROM VIDEO INSPECTION

METRIC
WHOLE NUMBERS INDICATE MILLIMETRES
DECIMALIZED NUMBERS INDICATE METRES

APECM
Certificate of Authorization
UMA Engineering Ltd.
No. 256 Expiry: April 30, 2006

BID OPPORTUNITY NO. 695-2005

LOCATION APPROVED
UNDERGROUND STRUCTURES

SUPR. U/G STRUCTURES COMMITTEE DATE

NOTE:
LOCATION OF UNDERGROUND STRUCTURES AS SHOWN ARE BASED ON THE BEST INFORMATION AVAILABLE. BUT NO GUARANTEE IS GIVEN THAT ALL EXISTING UTILITIES ARE SHOWN OR THAT THE GIVEN LOCATIONS ARE EXACT. CONFIRMATION OF EXISTENCE AND EXACT LOCATION OF ALL SERVICES MUST BE OBTAINED FROM THE INDIVIDUAL UTILITIES BEFORE PROCEEDING WITH CONSTRUCTION.

BM 51-042 ELEV 232.799m	S.E. Cor. Academy Rd. & Borebank St. Tbt. in 7.6 m Conc. pile beneath Valve Box, 8.5 m W. of E.L. Borebank St. & 5.6 m N. of S.L. Academy Rd.		
0	ISSUED FOR CONSTRUCTION	06/01/12	KMB
NO.	REVISIONS	YY/MM/DD	BY

UMA AECOM	
© 2005 UMA ENGINEERING LTD. ALL RIGHTS RESERVED.	
DESIGNED BY ALD / MJR	CHECKED BY ALD
DRAWN BY KMB	APPROVED BY <i>[Signature]</i>
HOR. SCALE 1:500	RELEASED FOR CONSTRUCTION
VERT. SCALE	<i>[Signature]</i>
DATE 06/01/12	DATE Jan 16/12

PROFESSIONAL'S SEAL

CONSULTANT DRAWING NO. 15
D265-195-02

THE CITY OF WINNIPEG
WATER AND WASTE DEPARTMENT

2005 COMBINED SEWER RENEWALS
BY CIPP INTERNAL POINT REPAIRS
CONTRACT 20

LINDSAY STREET
1ST MH N OF ACADEMY ROAD
TO MH AT ACADEMY ROAD

SHEET 15 OF 26	REV 0
CITY DRAWING NUMBER 05724	