

UMA FILE NAME: D265-195-02\_01-C-1024\_RX.dwg Saved By: kberard PLOT: 06/01/12 11:40:43 AM B SIZE 11" x 17" (279mm x 432mm)

**STRATHCONA STREET**

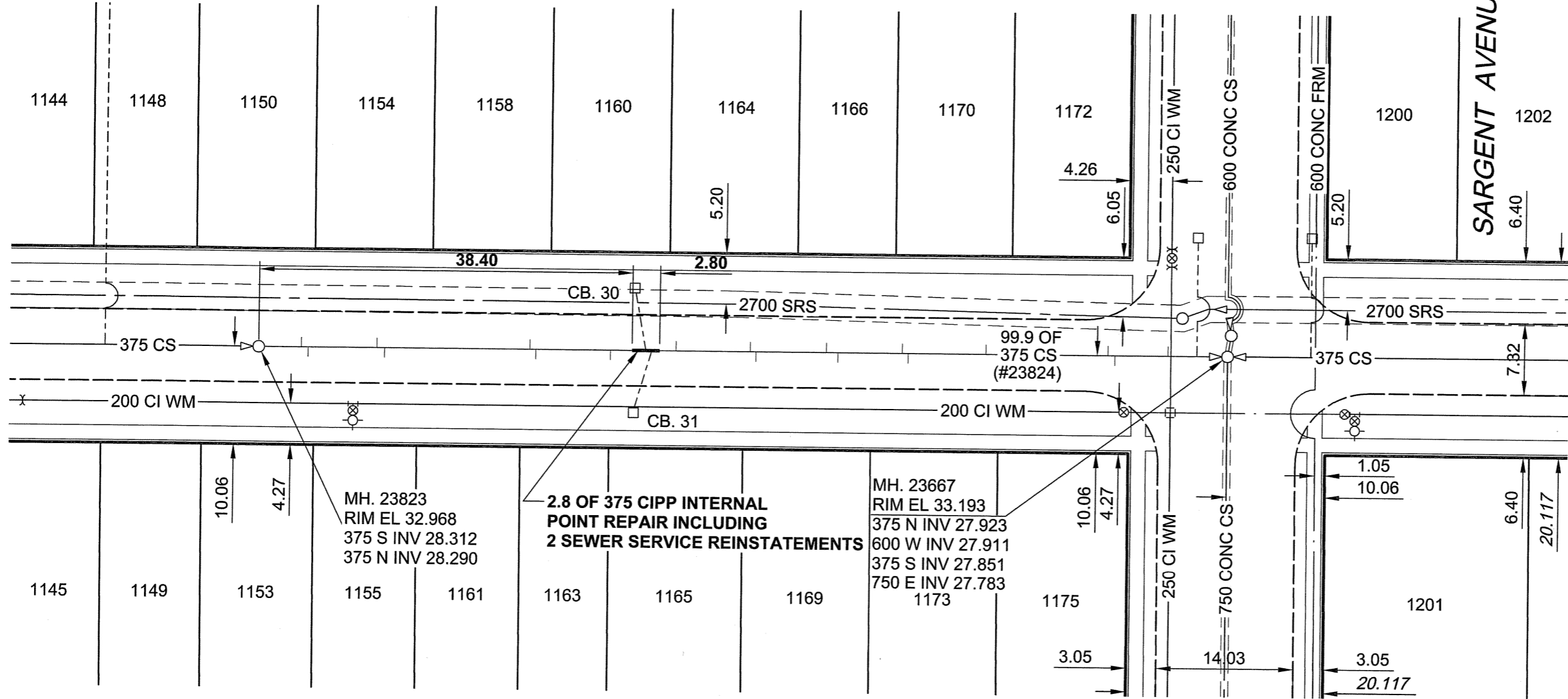

**SEWER JUNCTION INFORMATION\***

REF. MH	DIST FROM REF. MH	SIZE	CLOCK REF
23823	4.40	150Ø	11
23823	5.10	150Ø	01
23823	12.20	150Ø	11
23823	13.00	150Ø	01
23823	28.00	150Ø	11
23823	28.60	150Ø	02
23823	36.30	150Ø	01
23823	39.90	150Ø	11
23823	40.50	250Ø	02
23823	43.00	150Ø	11
23823	50.60	150Ø	11
23823	51.20	150Ø	01
23823	58.40	200Ø	10
23823	59.60	150Ø	01
23823	66.20	150Ø	11
23823	66.80	150Ø	01
23823	74.80	150Ø	11
23823	87.30	150Ø	11
23823	88.00	150Ø	01
23823	93.40	200Ø	09

\*JUNCTION LOCATION FROM VIDEO INSPECTION

**METRIC**

WHOLE NUMBERS INDICATE MILLIMETRES  
DECIMALIZED NUMBERS INDICATE METRES

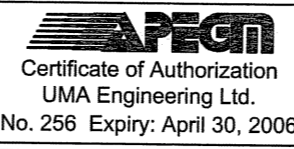

**LOCATION APPROVED UNDERGROUND STRUCTURES**

SUPR. U/G STRUCTURES	DATE

**NOTE:**  
LOCATION OF UNDERGROUND STRUCTURES AS SHOWN ARE BASED ON THE BEST INFORMATION AVAILABLE. BUT NO GUARANTEE IS GIVEN THAT ALL EXISTING UTILITIES ARE SHOWN OR THAT THE GIVEN LOCATIONS ARE EXACT. CONFIRMATION OF EXISTENCE AND EXACT LOCATION OF ALL SERVICES MUST BE OBTAINED FROM THE INDIVIDUAL UTILITIES BEFORE PROCEEDING WITH CONSTRUCTION.

BM 36-011 ELEV 233.048m	Bolt in 7.3 m Conc. pile, 0.6 m N. of N.L. of Sargent Ave. & 2.4 m W. of E.L. of Strathcona St.		
NO.	ISSUED FOR CONSTRUCTION	06/01/12	KMB
NO.	REVISIONS	YY/MM/DD	BY

**UMA | AECOM**

©2005 UMA ENGINEERING LTD. ALL RIGHTS RESERVED.

DESIGNED BY	ALD / MJR	CHECKED BY	ALD
DRAWN BY	KMB	APPROVED BY	<i>[Signature]</i>
HOR. SCALE	1:500	RELEASED FOR CONSTRUCTION	<i>[Signature]</i>
VERT. SCALE		DATE	06/01/12

PROFESSIONAL'S SEAL

CONSULTANT DRAWING NO. 23  
D265-195-02

BID OPPORTUNITY NO. 695-2005

**THE CITY OF WINNIPEG**  
**WATER AND WASTE DEPARTMENT**

**2005 COMBINED SEWER RENEWALS  
BY CIPP INTERNAL POINT REPAIRS  
CONTRACT 20**

**STRATHCONA STREET**  
1ST MH S OF SARGENT AVENUE  
TO MH AT SARGENT AVENUE

SHEET	23	OF	26
CITY DRAWING NUMBER	<b>05732</b>		
REV	0		