

BID OPPORTUNITY # 7 - 2005

CRAIG STREET - FROM WOLSELEY AVE. TO PORTAGE AVE.

L = 315m W = 7.5m A = 2363m²

TYPE - REHABILITATION - MAJOR

CONSTRUCTION NOTES:

1. CONTRACTOR SHALL TAKE PRECAUTIONARY STEPS TO AVOID DAMAGE FROM CONSTRUCTION ACTIVITIES TO EXISTING BOULEVARDS AND TREES WITHIN THE LIMITS OF CONSTRUCTION.
2. LOCATION OF EXISTING SERVICES ARE TO BE CONFIRMED IN THE FIELD BY THE CONTRACTOR.
3. TIE-INS TO BE VERIFIED IN THE FIELD BY THE CONTRACT ADMINISTRATOR.
4. SIDEWALK PLACEMENT TO BE MARKED OUT IN THE FIELD AS DIRECTED BY THE CONTRACT ADMINISTRATOR.
5. BOULEVARD REPLACEMENT TO BE FINALIZED IN THE FIELD AS DIRECTED BY THE CONTRACT ADMINISTRATOR.

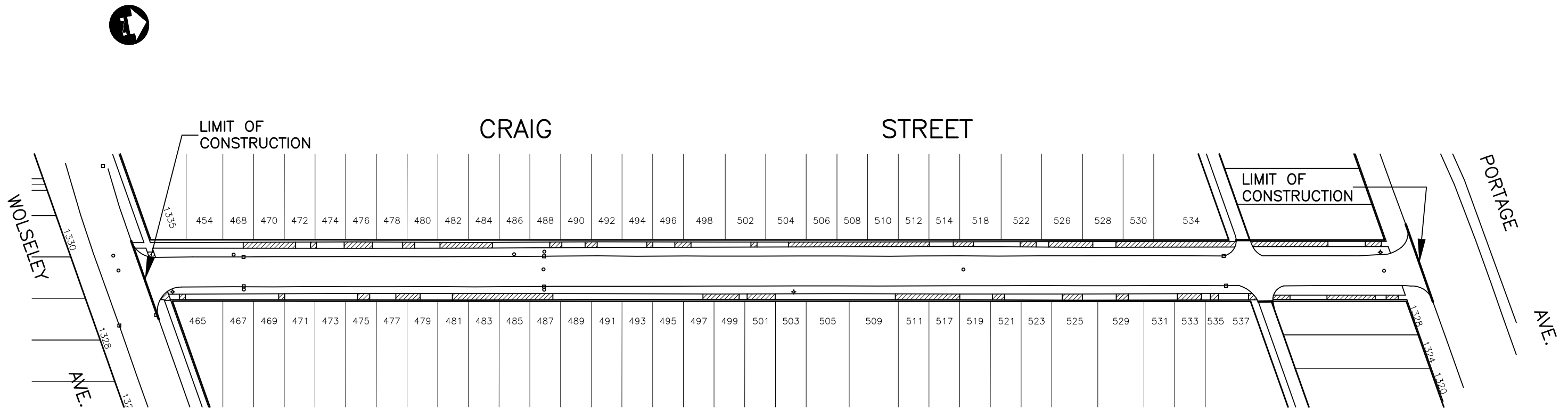

NOTES:

- EXISTING CONCRETE ROADWAY WITH ASPHALT OVERLAY
- ALL CURB TO BE REPLACED WITH NEW CURB AND GUTTER (630 lm)
- PAVEMENT PATCHING
- ASPHALT OVERLAY AVERAGE THICKNESS 100mm
- SIDEWALK REPAIRS (APPROX. 445 m²)
- REPLACE CURB INLETS WITH CATCH PITS AND CURB AND GUTTER INLETS

 NEW SIDEWALK



DILLON
 CONSULTING
 MARCH 2005

2005 RESIDENTIAL STREET RENEWAL PROGRAM	PROJ. NO. 04-3914-1000
	FIG. NO. R-2