

SEE DWG WF-S7117 AND WF-S7118
W360x33
TYP 2 PLACES,
TOS EL 236.520

8
WB-S7456
TYP 2 PLACES

OZONE CONTACTOR NO. 1

OZONE CONTACTOR NO. 2

TOC EL 236.170

TOC EL 236.170

TOC EL 236.170

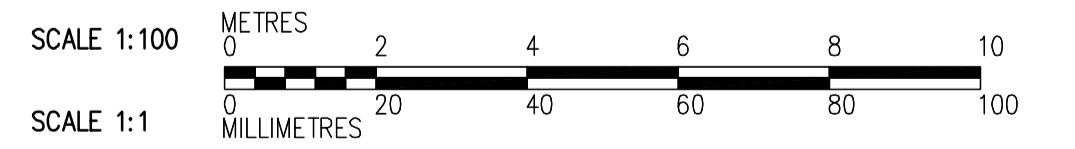
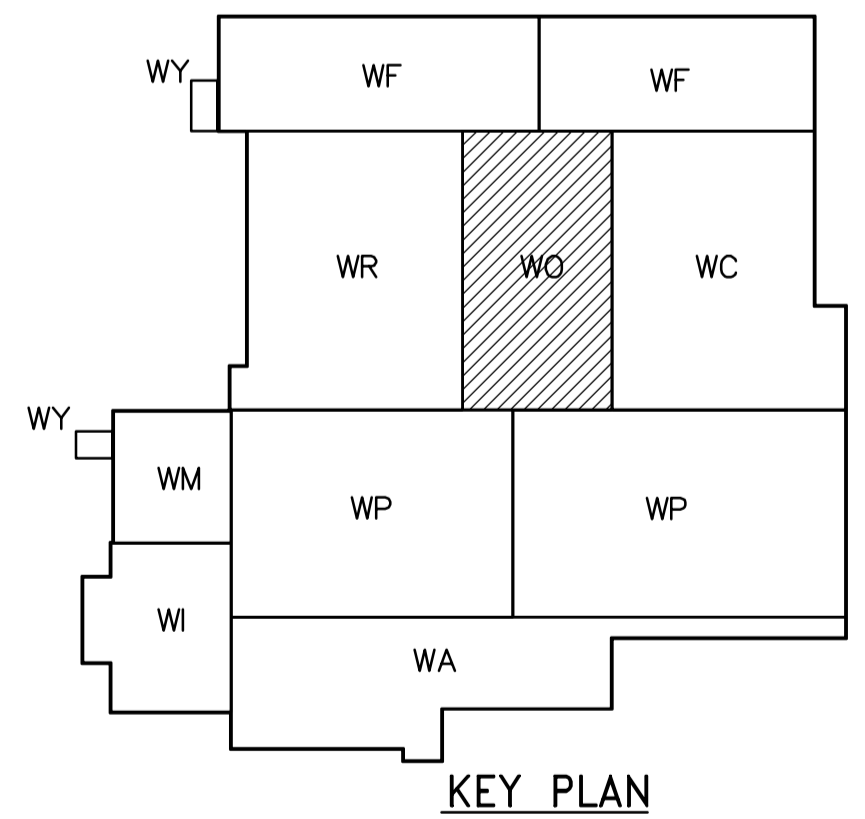

FIRST FLOOR PLAN
1:100

APECA
Certificate of Authorization
CH2M HILL Canada Ltd.
No. 1441 Expiry: April 30, 2006

B.M. ELEV.			
DESIGNED BY	DK	CHECKED BY	AP
DRAWN BY	RL/CA	APPROVED BY	AHL
SCALE:	1:100	RELEASED FOR CONSTRUCTION BY:	R. SOROKOWSKI
NO. REVISIONS	DATE	DATE	DATE
00	742-2005 ADDENDUM 1	06/04/21	DK
		2005/12/19	

CH2MHILL
Frederickson Cooper
ARCHITECTS

EarthTech
A Tyco International Ltd. Company

ENGINEER'S SEAL

ORIGINAL SIGNED BY
D. KRUGER
2006/04/21

CONSULTANT DRAWING NO.
WO-S7111

Winnipeg

THE CITY OF WINNIPEG
WATER AND WASTE DEPARTMENT
ENGINEERING DIVISION

WATER TREATMENT PLANT
OZONE
MECHANICAL AND ELECTRICAL

CITY FILE NUMBER

SHEET OF

CITY DRAWING NUMBER

1-06010-A-S7111-001-000

STRUCTURAL
OZONATION AREA
FIRST FLOOR PLAN