

- NOTES:**
1. ALL 120V AND 208V LOADS ARE FED FROM LP-R21.
 2. EMERGENCY LIGHTING EM-X-1 ARE FED FROM BATTERY PACK EM-X.
 3. MOUNT TYPE A AND I LUMINAIRE AT 3.0m ABOVE THE FLOOR.

SECOND FLOOR POWER AND LIGHTING PLAN
1:100

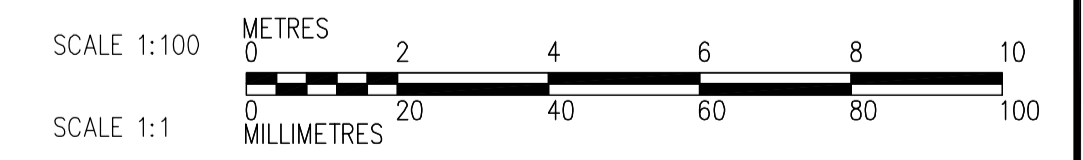
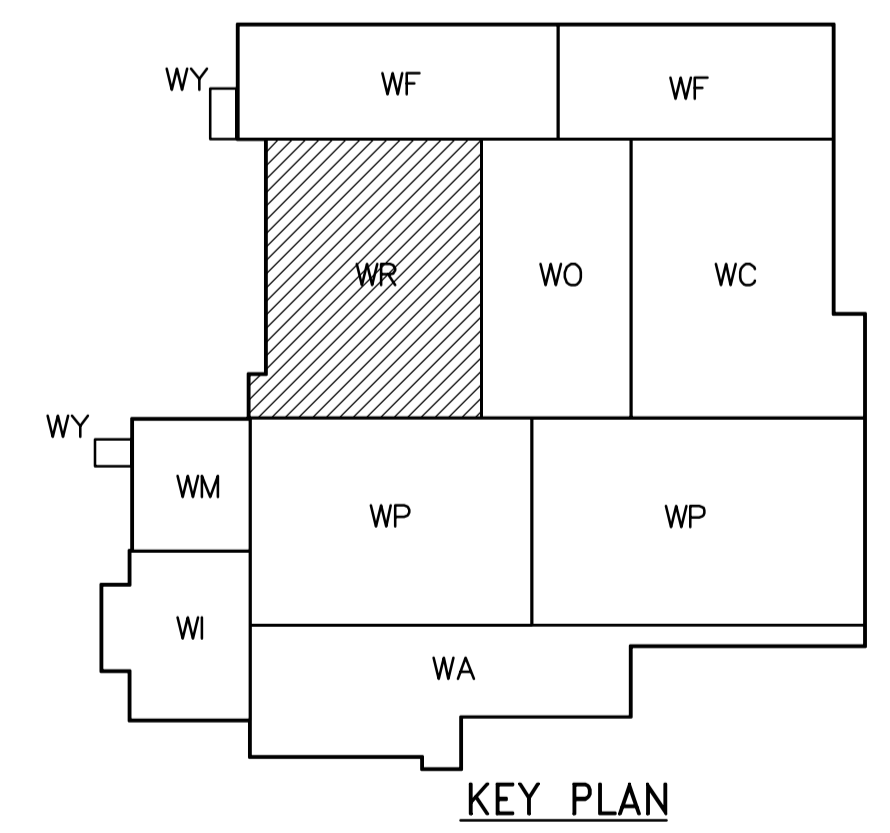

STAIRWELL No. 4

STAIRWELL No. 11

APECA
Certificate of Authorization
CH2M HILL Canada Ltd.
No. 1441 Expiry: April 30, 2007

NO.	REVISIONS	DATE	BY
03	742-2005 ADDENDUM 12	06/06/23	PF
02	742-2005 ADDENDUM 5	06/05/19	LL
01	742-2005 ADDENDUM 3	06/05/05	LL
00	ISSUED FOR TENDER	06/03/29	LL

CH2MHILL Frederickson Cooper ARCHITECTS		EarthTech A Tyco International Ltd. Company	
DESIGNED BY	LL	CHECKED BY	ND
DRAWN BY	TL	APPROVED BY	AHL
SCALE:	1:100	RELEASED FOR CONSTRUCTION BY:	R. SOROKOWSKI
DATE	2005/07/12	DATE	2006/03/29

ENGINEER'S SEAL
ORIGINAL SIGNED BY
L.D. LLEWELLYN
2006/03/29
CONSULTANT DRAWING NO.
WR-E0123

THE CITY OF WINNIPEG
WATER AND WASTE DEPARTMENT
ENGINEERING DIVISION

WATER TREATMENT PLANT
RESIDUALS HANDLING
MECHANICAL AND ELECTRICAL

ELECTRICAL
RESIDUALS HANDLING AREA
SECOND FLOOR POWER AND LIGHTING PLAN

CITY FILE NUMBER
SHEET OF
CITY DRAWING NUMBER
1-0601R-A-E0123-001-03D