

- NOTES:**
1. ALL 120V AND 208V LOADS ARE FED FROM LP-A11.
  2. EMERGENCY LIGHTING EM-X-1, -2 ETC ARE FED FROM BATTERY PACK EM-X.
  3. MOUNT TYPE A LUMINAIRE 3m ABOVE FINISHED FLOOR.
  4. MOUNT TYPE E LUMINAIRE 7m ABOVE FINISHED FLOOR.

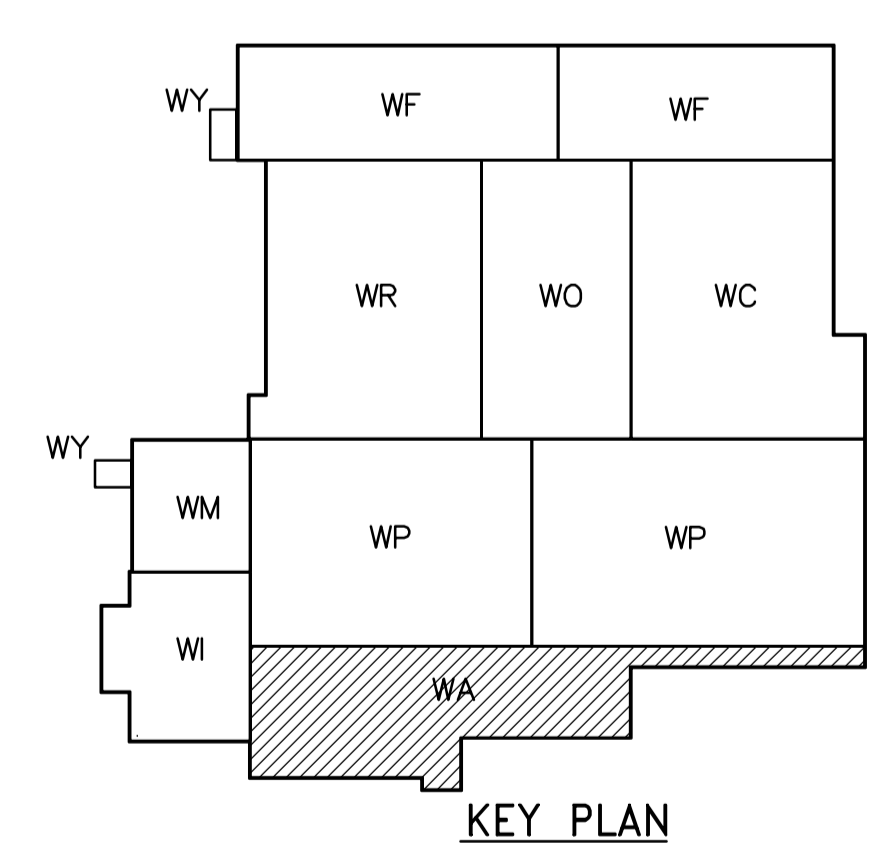

**LOWER LEVEL POWER AND LIGHTING PLAN**  
1:100

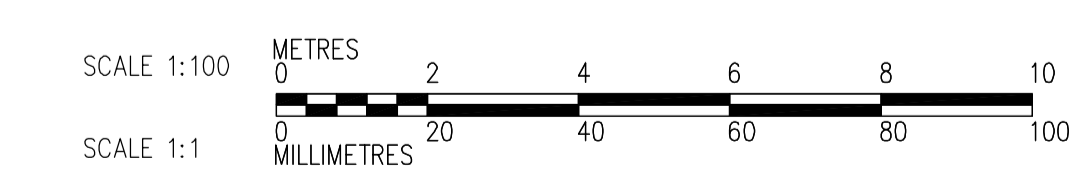

<p><b>APEGN</b> Certificate of Authorization CH2M HILL Canada Ltd. No. 1441 Expiry: April 30, 2007</p>	<p>B.M. ELEV.</p> <table border="1"> <tr><td> </td><td> </td><td> </td></tr> <tr><td> </td><td> </td><td> </td></tr> <tr><td> </td><td> </td><td> </td></tr> </table>										<p>Frederickson Cooper ARCHITECTS</p>	<p>A 300 International Ltd. Company</p>	<p>ENGINEER'S SEAL</p> <p>ORIGINAL SIGNED BY L.D. LLEWELLYN 2006/03/29</p>	<p><b>THE CITY OF WINNIPEG</b> WATER AND WASTE DEPARTMENT ENGINEERING DIVISION</p>	<p>WATER TREATMENT PLANT ADMINISTRATION AREA MECHANICAL AND ELECTRICAL</p>	<p>CITY FILE NUMBER</p> <p>SHEET OF</p> <p>CITY DRAWING NUMBER 1-0601A-A-E0103-001-01D</p>
<p>DESIGNED BY JT</p> <p>CHECKED BY ND</p> <p>DRAWN BY KJ</p> <p>APPROVED BY AHL</p> <p>SCALE: 1:100</p> <p>RELEASED FOR CONSTRUCTION BY: R. SOROKOWSKI</p> <p>DATE 2005/08/18</p>	<p>CONSULTANT DRAWING NO. WA-E0103</p>															