

- NOTES**
1. ALL 120V AND 208V LOADS ARE FED FROM LP-H31.
 2. EMERGENCY LIGHTING EM-X-1,-2 ARE FED FROM BATTERY PACK EM-X.
 3. SEE DRAWING WB-E0401 FOR MOUNTING DETAILS FOR TYPE "A" FIXTURES.

THIRD FLOOR POWER AND LIGHTING PLAN
1:100

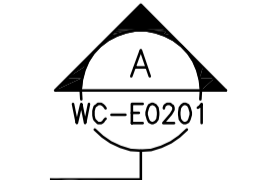
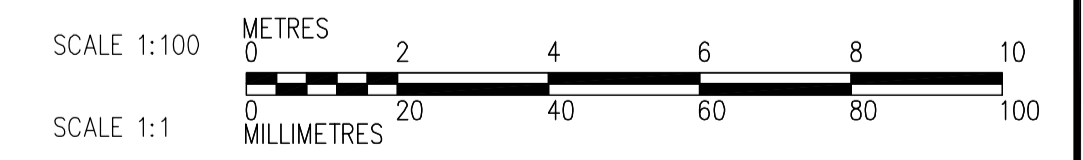
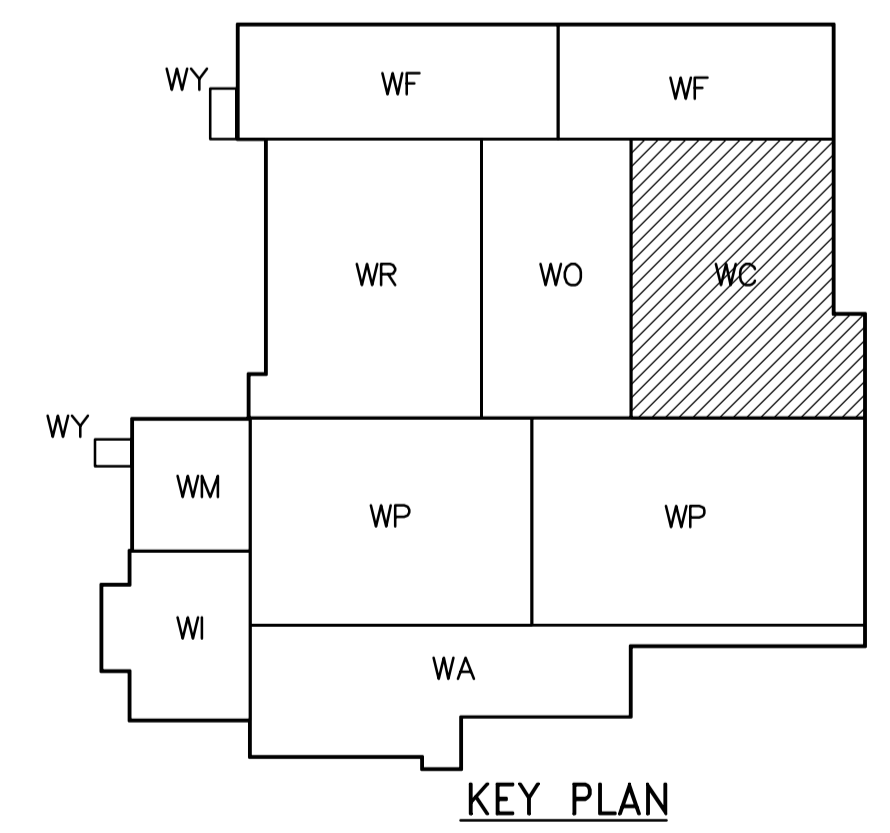

<p>Certificate of Authorization CH2M HILL Canada Ltd. No. 1441 Expiry: April 30, 2007</p>	B.M. ELEV.	<p>Frederickson Cooper ARCHITECTS</p>	<p>A Terra International Ltd. Company</p>	ENGINEER'S SEAL	<p>THE CITY OF WINNIPEG WATER AND WASTE DEPARTMENT ENGINEERING DIVISION</p>		
				DESIGNED BY LL		CHECKED BY ND	ORIGINAL SIGNED BY L.D. LLEWELLYN
				DRAWN BY TL		APPROVED BY AHL	2006/03/29
				SCALE: 1:100		RELEASED FOR CONSTRUCTION BY: R. SOROKOWSKI	CONSULTANT DRAWING NO. WC-E0133
	01 742-2005 ADDENDUM 3 06/05/05 LL	DATE 2006/02/12	DATE 2006/03/29	WATER TREATMENT PLANT CHEMICAL FEED SYSTEM MECHANICAL AND ELECTRICAL	CITY FILE NUMBER		
	00 ISSUED FOR TENDER 06/03/29 LL				SHEET OF		
	NO. REVISIONS	DATE	DATE		CITY DRAWING NUMBER		
					1-0601C-A-E0133-001-01D		