

- NOTES:**
1. SEE MCC 4A & 4B SINGLE LINE DIAGRAMS AND PANEL SCHEDULES DP-H31 AND DP-H32 FOR 600V POWER DISTRIBUTION
 2. SEE DRAWINGS WB-E0402 AND WB-E0403 FOR FLOCCULATION TANK EQUIPMENT WIRING DETAILS
 3. SEE DRAWINGS WB-E0402 AND WB-E0403 FOR CABLE TRAY MOUNTING DETAILS
 4. ALL 120V AND 208V LOADS ARE FED FROM LP-P31

FOR CABLE TRAY TAGGING SEE DETAIL **3** WB-E0455

THIRD FLOOR FACILITY PLAN 2
1:100

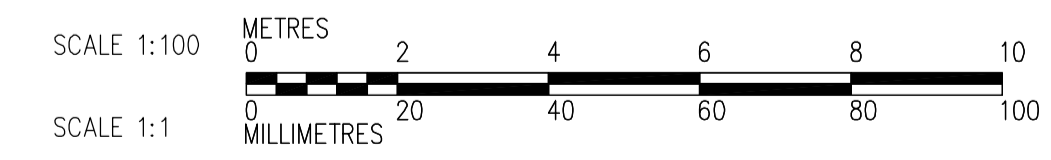
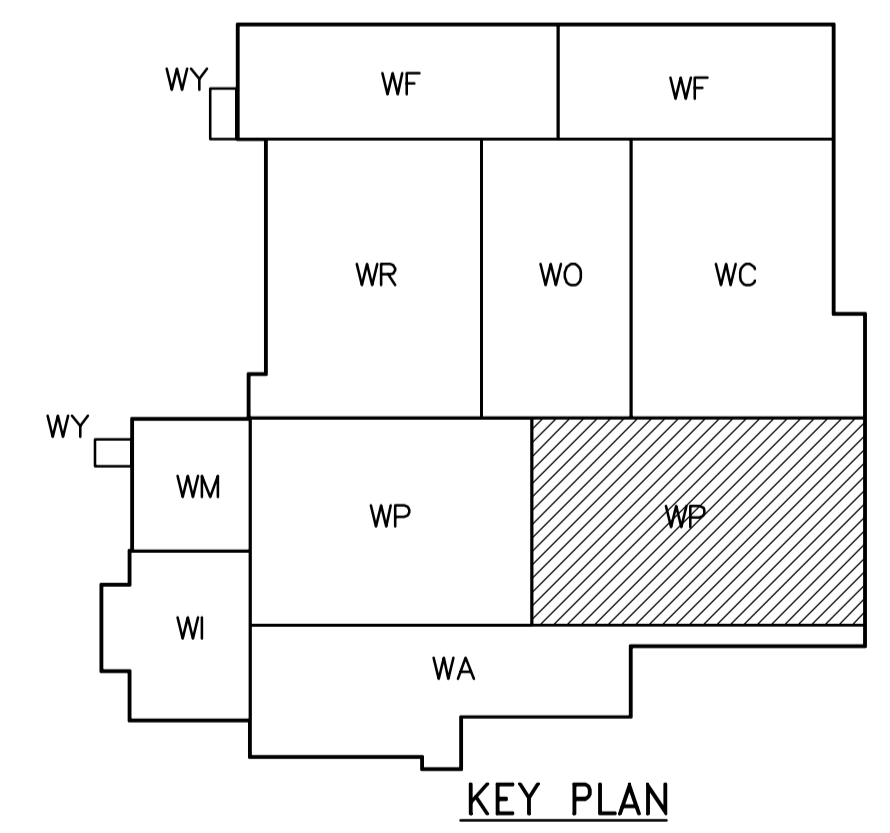

<p>APEGN Certificate of Authorization CH2M HILL Canada Ltd. No. 1441 Expiry: April 30, 2007</p>	<p>Frederickson Cooper ARCHITECTS</p>		<p>A 100 International Ltd. Company</p>		ENGINEER'S SEAL ORIGINAL SIGNED BY L.D. LLEWELLYN 2006/03/29	<p>THE CITY OF WINNIPEG WATER AND WASTE DEPARTMENT ENGINEERING DIVISION</p>
	DESIGNED BY LL CHECKED BY ND		DRAWN BY TL APPROVED BY AHL		CONSULTANT DRAWING NO. WP-E0132	
	SCALE: 1:100		RELEASED FOR CONSTRUCTION BY: R. SOROKOWSKI			
	NO. REVISIONS 01 742-2005 ADDENDUM 3 06/05/05 LL 00 ISSUED FOR TENDER 06/03/29 LL		DATE 2005/07/12 DATE 2006/03/29		WATER TREATMENT PLANT FLOCCULATION AND DAF MECHANICAL AND ELECTRICAL	